

KCC WICHITA

Must Be Filed For All Wells

* Lease Name: Oliver

* Location:

[illegible]

A separate sheet may be attached if necessary

* When transferring a unit which consists of more than one lease please file a separate side two for each lease. If a lease covers more than one section please indicate which section each well is located.



Mid-Continent Association Form B

(This Space Reserved for Filing Stamp)

ASSIGNMENT OF OIL AND GAS LEASE

KNOW ALL MEN BY THESE PRESENTS:

That the undersigned,

Julie A. Herrick

hereinafter called Assignor (whether one or more), for and in consideration of One Dollar (\$1.00) the receipt whereof is hereby acknowledged, does hereby sell, assign, transfer and set over unto

Daniel and/or Bobbi Ard

6014 Slater Merriam, KS 66202

(hereinafter called Assignee), 100% working interest in and to the oil and gas lease dated November 15, 1978, from

Maxine Wells Oliver

, lessor

to Don C. Bloomer

, lessee

recorded in book 270, page 188 insofar as said lease covers the following described land in Miami County, State of Kansas:

NE 1/4 of NE 1/4 16-17-22 and S1/2 NE 1/4 16-17-22

RECEIVED

RECEIVED

MAY 12 2005

FEB 09 2005

KCC WICHITA

KCC WICHITA

of Section 16 Township 17 Range 22E and containing 120 acres, more or less together with the rights incident thereto and the personal property thereon, appurtenant thereto, or used or obtained in connection therewith.

And for the same consideration the Assignor covenants with the Assignee, its or his heirs, successors or assigns: That the Assignor is the lawful owner of and has good title to the interest above assigned in and to said lease, estate, rights and property, free and clear from all liens, encumbrances or adverse claims; That said lease is a valid and subsisting lease on the land above described, and all rentals and royalties due thereunder have been paid and all conditions necessary to keep the same in full force have been duly performed,

EXECUTED, This 20th day of August, 2002

Julie A. Herrick
Julie A. Herrick

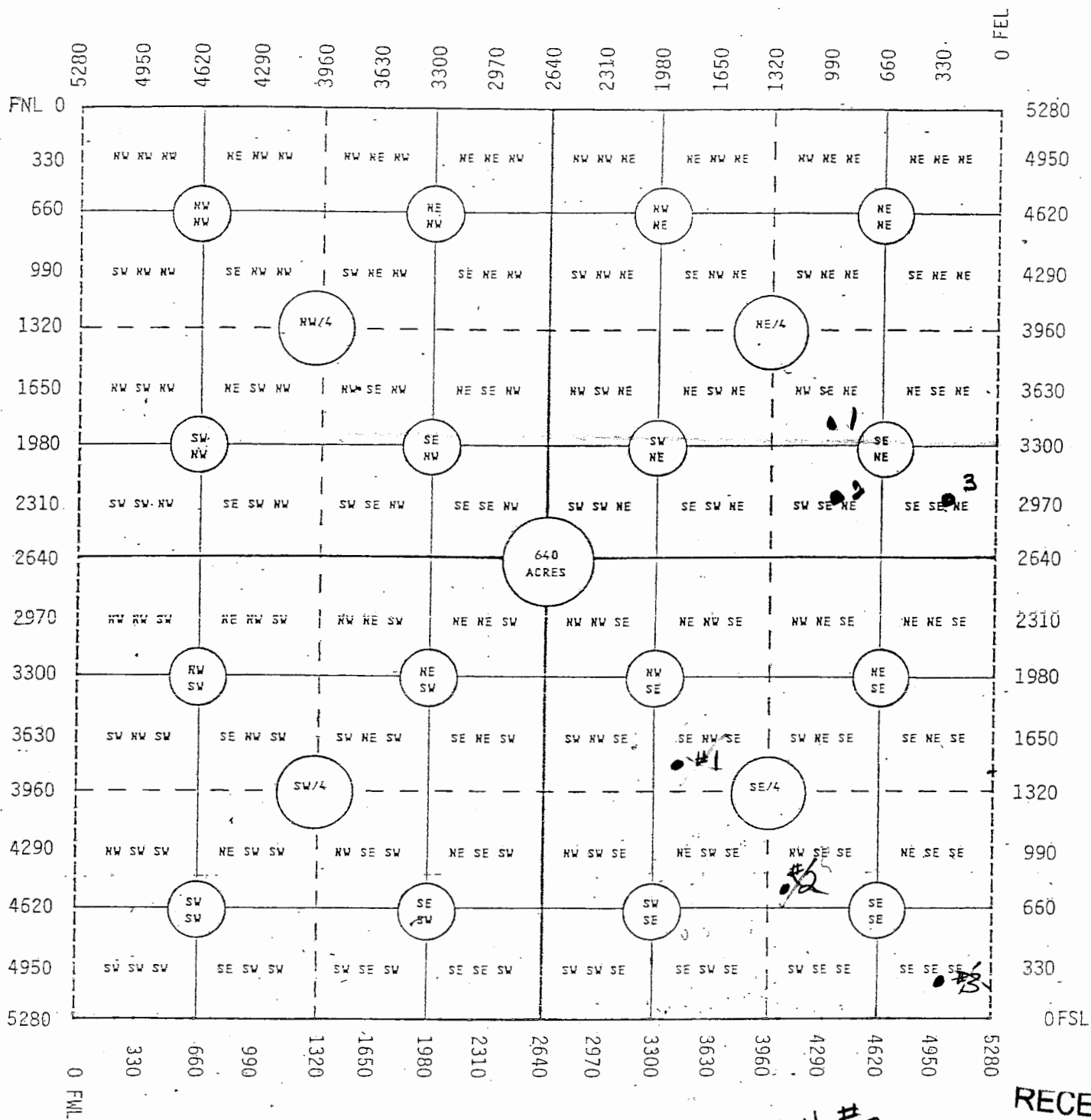

Sorry This is Late
I was in the Hosp.

I have no Idea when
These Wells were Drilled.

Well #3

175' WFEL
2145 NFSL

Well #2

835' WFEL
2145 NFSL

Well #1

835' WFEL
2805' NFSL

RECEIVED
MAY 12 2005
KCC WICHITA