

**1 LOCATION OF WATER WELL:** Fraction NW 1/4 NE 1/4 NE 1/4 NE 1/4 Section Number 34 Township Number T 31 S Range Number 6  E  W  
 County: Cowley

Street/Rural Address of Well Location; if unknown, distance & direction from nearest town or intersection: If at owner's address, check here  189 ft west from N Main st on US160 in Burden  
**Global Positioning Systems (GPS) information:**  
 Latitude: 37.316181 (in decimal degrees)  
 Longitude: -96.754075 (in decimal degrees)  
 Elevation: 1392  
 Horizontal Datum:  WGS84,  NAD83,  NAD27  
 Collection Method:

**2 WATER WELL OWNER:** Kansas Dept of Transportation  GPS unit (Make/Model):  
 RR#, St. Address, Box #: 7093 US 160  Digital Map/Photo,  Topographic Map,  Land Survey  
 City, State ZIP Code: Winfield KS 67156 Est. Accuracy:  < 3 m,  3-5 m,  5-15 m,  > 15 m

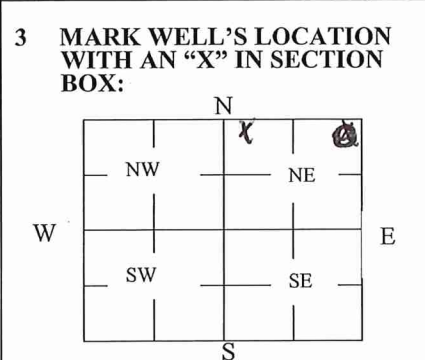

**4 DEPTH OF WELL** 35 ft. RECEIVED  
 WELL'S STATIC WATER LEVEL 30 ft. APR 13 2026  
 WELL WAS USED AS:  
 Domestic  Public Water Supply  Debris  
 Irrigation  Oil Field Water Supply  Monitoring  
 Feedlot  Domestic (Lawn & Garden)  Injection Well  
 Industrial  Air Conditioning  Other Unknown  
 Was a chemical/bacteriological sample submitted to Department? Yes  No

**5 TYPE OF BLANK CASING USED:**  
 Steel  RMP (SR)  Wrought  Fiberglass  Other (Specify below)  
 PVC  ABS  Asbestos-Cement  Concrete Tile Stone  
 Blank casing diameter 7.8 in. Was casing pulled? Yes  No  If yes, how much \_\_\_\_\_ in.  
 Casing height above or below land surface \_\_\_\_\_ in.

**6 GROUT PLUG MATERIAL:**  Neat cement  Cement grout  Bentonite  Other \_\_\_\_\_  
 Grout Plug Intervals: From 23 ft. to 5 ft., From \_\_\_\_\_ ft. to \_\_\_\_\_ ft., From \_\_\_\_\_ ft. to \_\_\_\_\_ ft.

What is the nearest source of possible contamination:  
 Septic tank  Seepage pit  Fuel storage  Other (specify below)  
 Sewer lines  Pit privy  Fertilizer storage  
 Watertight sewer lines  Sewage lagoon  Insecticide storage  
 Lateral lines  Feedyard  Abandoned water well  Oil well/Gas well  
 Cess pool  Livestock pens  
 Direction from well? West  
 How many feet? within 10-15'

FROM	TO	PLUGGING MATERIALS	FROM	TO	PLUGGING MATERIALS
35'	23'	Sand			
23'	5'	Cement grout			
5'	0'	Dirt			

**7 CONTRACTOR'S OR LANDOWNER'S CERTIFICATION:** This water well was plugged under my jurisdiction and was completed on (mo/day/year) 4/3/2026 and this record is true to the best of my knowledge and belief. Kansas Water Well Contractor's License No. \_\_\_\_\_. This Water Well Record was completed on (mo/day/year) 4/6/2026 under the business name of \_\_\_\_\_ by (signature) [Signature] KDOT