

WATER WELL RECORD

Form WWC-5

Division of Water Resources; App. No. _____

1 LOCATION OF WATER WELL: County: Shawnee Fraction: NE 1/4 NE 1/4 NW 1/4 Section Number: 21 Township Number: T 10 S Range Number: R 15 E

Distance and direction from nearest town or city street address of well if located within city? 5 1/2 north of Topeka **Global Positioning Systems** (decimal degrees, min. of 4 digits)
 Latitude: _____
 Longitude: _____
 Elevation: _____
 Datum: _____
 Data Collection Method: _____

2 WATER WELL OWNER: Steve Richter
 RR#, St. Address, Box # : 5733 N.W. 20th
 City, State, ZIP Code : Topeka KS

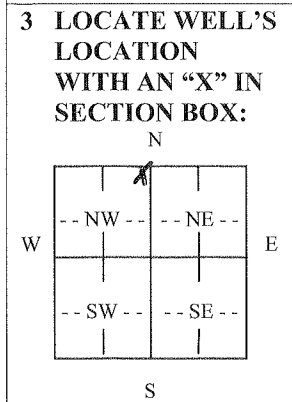

4 DEPTH OF COMPLETED WELL 80 ft.
 Depth(s) Groundwater Encountered (1)..... ft. (2)..... ft. (3)..... ft.
 WELL'S STATIC WATER LEVEL..... ft. below land surface measured on mo/day/yr. 11-18-09
 Pump test data: Well water was.....ft. after..... hours pumping..... gpm
 Est. Yield...7...gpm; Well water was.....ft. after..... hours pumping..... gpm
WELL WATER TO BE USED AS: 5 Public water supply 8 Air conditioning 11 Injection well
 Domestic 3 Feedlot 6 Oil field water supply 9 Dewatering 12 Other (Specify below)
 2 Irrigation 4 Industrial 7 Domestic (lawn & garden) 10 Monitoring well
 Was a chemical/bacteriological sample submitted to Department? Yes No ; If yes, mo/day/yr
 Sample was submitted..... Water well disinfected? Yes No

5 TYPE OF CASING USED: 1 Steel 3 RMP (SR) 6 Asbestos-Cement 8 Concrete tile CASING JOINTS: Glued...... Clamped.....
 2 PVC 4 ABS 7 Fiberglass Welded.....
 Blank casing diameter5..... in. to25..... ft., Diameter in. to ft., Diameter in. to ft.
 Casing height above land surface.....24..... in., Weight lbs./ft. Wall thickness or gauge No. SDR 21

TYPE OF SCREEN OR PERFORATION MATERIAL: 1 Steel 3 Stainless Steel 5 Fiberglass PVC 9 ABS 11 Other (Specify)
 2 Brass 4 Galvanized Steel 6 Concrete tile 8 RM (SR) 10 Asbestos-Cement 12 None used (open hole)
SCREEN OR PERFORATION OPENINGS ARE: 1 Continuous slot 3 Mill slot 5 Gauzed wrapped 7 Torch cut 9 Drilled holes 11 None (open hole)
 2 Louvered shutter 4 Key punched 6 Wire wrapped Saw Cut 10 Other (specify)
SCREEN-PERFORATED INTERVALS: From..... ft. to ft., From ft. to ft.
 From.....25..... ft. to35..... ft., From65..... ft. to70..... ft.
GRAVEL PACK INTERVALS: From.....25..... ft. to80..... ft., From ft. to ft.
 From..... ft. to ft., From ft. to ft.

6 GROUT MATERIAL: 1 Neat cement 2 Cement grout Bentonite 4 Other
 Grout Intervals: From2..... ft. to23..... ft., From ft. to ft., From ft. to ft.
 What is the nearest source of possible contamination:
 Septic tank 4 Lateral lines 7 Pit privy 10 Livestock pens 13 Insecticide Storage 16 Other (specify below)
 2 Sewer lines 5 Cess pool 8 Sewage lagoon 11 Fuel storage 14 Abandoned water well
 3 Watertight sewer lines 6 Sewage pit 9 Feedyard 12 Fertilizer Storage 15 Oil well/gas well
 Direction from well?SW..... How many feet?120.....

FROM	TO	LITHOLOGIC LOG	FROM	TO	PLUGGING INTERVALS
0	5	Topsoil	57	57	Brown limestone
5	19	Brown clay	57	75	Grey shale
19	26	Yellow clay	75	80	Grey limestone
26	27	Loose rock-chert			
27	39	Grey shale			
39	41	Yellow limestone			
41	44	Blue shale			
44	49	Tan limestone			
49	51	Grey shale-loose			
51	53	Blue shale			

7 CONTRACTOR'S OR LANDOWNER'S CERTIFICATION: This water well was constructed, (2) reconstructed, or (3) plugged under my jurisdiction and was completed on (mo/day/year) ..10-7-09 and this record is true to the best of my knowledge and belief.
 Kansas Water Well Contractor's License No. 182 This Water Well Record was completed on (mo/day/year) ..3-20-10 under the business name of Spuder Drilling Co Inc by (signature) [Signature]

INSTRUCTIONS: Use typewriter or ball point pen. PLEASE PRESS EARMLY and PRINT clearly. Please fill in blanks, underline or circle the correct answers. Send top three copies to Kansas Department of Health and Environment, Bureau of Water, Geology Section, 1000 SW Jackson St., Suite 420, Topeka, Kansas 66612-1367. Telephone 785-296-5522. Send one to WATER WELL OWNER and retain one for your records. Fee of \$5.00 for each constructed well. Visit us at <http://www.kdheks.gov/waterwell/index.html>.