

WATER WELL RECORD

Form WWC-5

Division of Water Resources App. No.

Well ID

MW1

[X] Original Record [ ] Correction [ ] Change in Well Ust

1 LOCATION OF WATER WELL: County Jefferson Fraction NE 1/4 SW 1/4 NW 1/4 SW 1/4 Section Number 7 Township Number T 10 S Range Number R 17 [X] E [ ] W

2 WELL OWNER: Last Name: First: Street or Rural Address where well is located (if unknown, distance and direction from nearest town or intersection): If at owner's address, check here: [ ] 201 Dawson, Meriden, KS

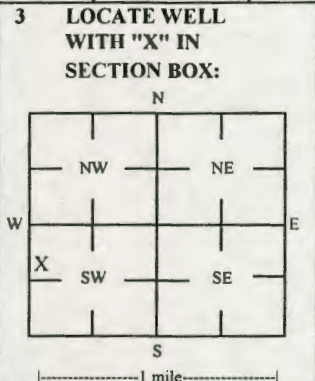

4 DEPTH OF COMPLETED WELL: 14 ft Depth(s) Groundwater Encountered: 1) \_\_\_\_\_ ft 2) \_\_\_\_\_ ft 3) \_\_\_\_\_ ft, or 4) [ ] Dry Well WELL'S STATIC WATER LEVEL: 1.48 ft [X] below land surface, measured on (mo-day-yr) 3/21-22/23 [ ] above land surface, measured on (mo-day-yr) \_\_\_\_\_

5 Latitude: 39.19204 (decimal degrees) Longitude: 95.56973 (decimal degrees) Horizontal Datum [X] WGS 84 [ ] NAD 83 [ ] NAD 27 Source for Latitude/Longitude: [ ] GPS (unit make/model: \_\_\_\_\_) (WAAS enabled? [ ] Yes [ ] No) [X] Land Survey [ ] Topographic Map [ ] Online Mapper 6 Elevation 970.86 ft [ ] Ground Level [X] TOC Source [X] Land Survey [ ] GPS [ ] Topographic Map [ ] Other \_\_\_\_\_

7 WELL WATER TO BE USED AS: 1 Domestic: [ ] Household [ ] Lawn & Garden [ ] Livestock 2 [ ] Irrigation 3 [ ] Feedlot 4 [ ] Industrial 5 [ ] Public Water Supply: well ID \_\_\_\_\_ 6 [ ] Dewatering: how many wells? \_\_\_\_\_ 7 [ ] Aquifer Recharge: well ID \_\_\_\_\_ 8 [X] Monitoring: well ID MW1 9 Environmental Remediation: well ID \_\_\_\_\_ [ ] Air Sparge [ ] Soil Vapor Extractor [ ] Recovery [ ] Injection 10 [ ] Oil Field Water Supply: lease \_\_\_\_\_ 11 Test Hole: well ID \_\_\_\_\_ [ ] Cased [ ] Uncased [ ] Geotechnical 12 Geothermal: How many bores? \_\_\_\_\_ a) Closed Loop [ ] Horizontal [ ] Vertical b) Open Loop [ ] Surface Discharge [ ] Inj. of Water [ ] Other (specify): \_\_\_\_\_

Was a chemical/bacteriological sample submitted to KDHE? [ ] Yes [X] No If yes, date sample was submitted: \_\_\_\_\_ Water well disinfected? [ ] Yes [X] No

8 TYPE OF CASING USED: [ ] Steel [X] PVC [ ] Other \_\_\_\_\_ CASING JOINTS: [ ] Glued [ ] Clamped [ ] Welded [X] Threaded Casing diameter 2 in. to 4 ft, Diameter \_\_\_\_\_ in. to \_\_\_\_\_ ft, Diameter \_\_\_\_\_ in. to \_\_\_\_\_ ft, Casing height above land surface -0.62 in. Weight \_\_\_\_\_ lbs./ft. Well thickness or gauge No \_\_\_\_\_ TYPE OF SCREEN OR PERFORATION MATERIAL: [ ] Steel [ ] Stainless Steel [ ] Fiberglass [X] PVC [ ] Other (Specify) \_\_\_\_\_ [ ] Brass [ ] Galvanized Steel [ ] Concrete tile [ ] None used (open hole) SCREEN OR PERFORATION OPENINGS ARE: [ ] Continuous Slot [X] Mill Slot [ ] Gauze Wrapped [ ] Torch Cut [ ] Drilled Holes [ ] Other (Specify) \_\_\_\_\_ [ ] Louvered Shutter [ ] Key Punched [ ] Wire Wrapped [ ] Saw Cut [ ] None (Open Hole) SCREEN-PERFORATED INTERVALS: From 4 ft. to 14 ft, From \_\_\_\_\_ ft. to \_\_\_\_\_ ft, From \_\_\_\_\_ ft. to \_\_\_\_\_ ft, GRAVEL PACK INTERVALS: From 2 ft. to 14 ft, From \_\_\_\_\_ ft. to \_\_\_\_\_ ft, From \_\_\_\_\_ ft. to \_\_\_\_\_ ft,

9 GROUT MATERIAL: [ ] Neat cement [ ] Cement grout [X] Bentonite [X] Other Concrete: 0-0.5' Grout intervals: From 0.5 ft. to 2 ft, From \_\_\_\_\_ ft. to \_\_\_\_\_ ft, From \_\_\_\_\_ ft. to \_\_\_\_\_ ft,

Nearest source of possible contamination: [ ] Septic Tank [ ] Lateral Lines [ ] Pit Privy [ ] Livestock Pens [ ] Insecticide Storage [ ] Sewer Lines [ ] Cess Pool [ ] Sewage Lagoon [X] Fuel Storage [ ] Abandoned Water Well [ ] Watertight Sewer Lines [ ] Seepage Pit [ ] Feedyard [ ] Fertilizer Storage [ ] Oil Well / Gas Well [ ] Other (Specify) \_\_\_\_\_ Direction from well? Within basin Distance from well? \_\_\_\_\_ ft

Table with columns: FROM, TO, LITHOLOGIC LOG, FROM, TO, LITHO. LOG (cont.) or PLUGGING INTERVALS. Rows: 0-0.2 Gravel, 0.2-1 Silty, sandy clay, 1-2 Rubble, bricks, 2-8 Clay, 8-10 Sandy, silty clay, 10-12 Intermittent limestone & shale, 12-14 Silty shale. Notes: KDHE ID: FCA - Meriden; A4-044-40302 Target of monitoring well is shallow groundwater, <20' of grout was installed at the direction of KDHE.

11 CONTRACTOR'S OR LANDOWNER'S CERTIFICATION: This water well was [X] constructed, [ ] reconstructed, or [ ] plugged under my jurisdiction and was completed on (mo-day-year) 3/20/23 and this record is true to the best of my knowledge and belief. Kansas Water Well Contractor's License No 757 This Water Well Record was completed on (mo-day-year) 4/13/23 under the business name of Larsen & Associates, Inc. Signature \_\_\_\_\_

# DENNIS L HANDKE

1820 NW 59th Terrace  
TOPEKA, KANSAS 66618  
785-286-4047 Home

Jess Chapman  
Larsen & Associates  
1311 E. 25<sup>th</sup> Street, Suite B  
Lawrence, Kansas, 66046

April 10, 2023

RE: Monitor Well Elevation Survey  
201 Dawson, Meriden, Kansas

T, 10 R. 17E  
Sec. 7  
Jefferson  
County

Proj. 23-00K  
FCA - Meriden  
A4-044-40302

Bench Mark: Sq. cut on NE corner of concrete scale platform East of the office building.  
Elev: 974.50      North 1907.94      West 4849.43      (from SE Cor. Sec. 7-10-17E)

MW-1	rim	971.48	North	1788.99	NE1/4,SW1/4,NW1/4,SW1/4
	top pipe	970.86	West	4934.97	Lat = 39.19204    Long = 95.56973
MW-2	rim	971.05	North	1777.52	NW1/4,SW1/4,NW1/4,SW1/4
	top pipe	970.53	West	4987.24	Lat = 39.19201    Long = 95.56991
MW-3	rim	973.52	North	1789.21	NE1/4,SW1/4,NW1/4,SW1/4
	top pipe	973.25	West	4857.52	Lat = 39.19205    Long = 95.56945
MW-4	rim	972.98	North	1965.03	NE1/4,SW1/4,NW1/4,SW1/4
	top pipe	972.36	West	4918.85	Lat = 39.19225    Long = 95.56968
MW-5	rim	970.99	North	1730.13	NE1/4,SW1/4,NW1/4,SW1/4
	top pipe	970.50	West	4903.41	Lat = 39.19188    Long = 95.56961
EMW-2	rim	976.46	North	2282.75	SE1/4,NW1/4,NW1/4,SW1/4
	top pipe	976.24	West	4668.13	Lat = 39.19341    Long = 95.56882
EMW-3	rim	975.86	North	2142.30	SE1/4,NW1/4,NW1/4,SW1/4
	top pipe	975.57	West	4679.99	Lat = 39.19303    Long = 95.56885

Lat & Long derived from Meriden 7.5 quad map. WGS84

Elevation established from USGS BM W 122 "1934". NAVD 88

If you have any questions, please feel free to call me. Thank you for the opportunity to be of service to you.



RECEIVED  
MAY 30 2023  
BUREAU OF WATER

NOTE: Figures exhibited within this report are only to be used within the context of this report. Placement of property lines, wells, structures, and roads is based on the available information from county appraiser maps, surveys, site visits, and/or previous vendor reports and should be considered approximate.

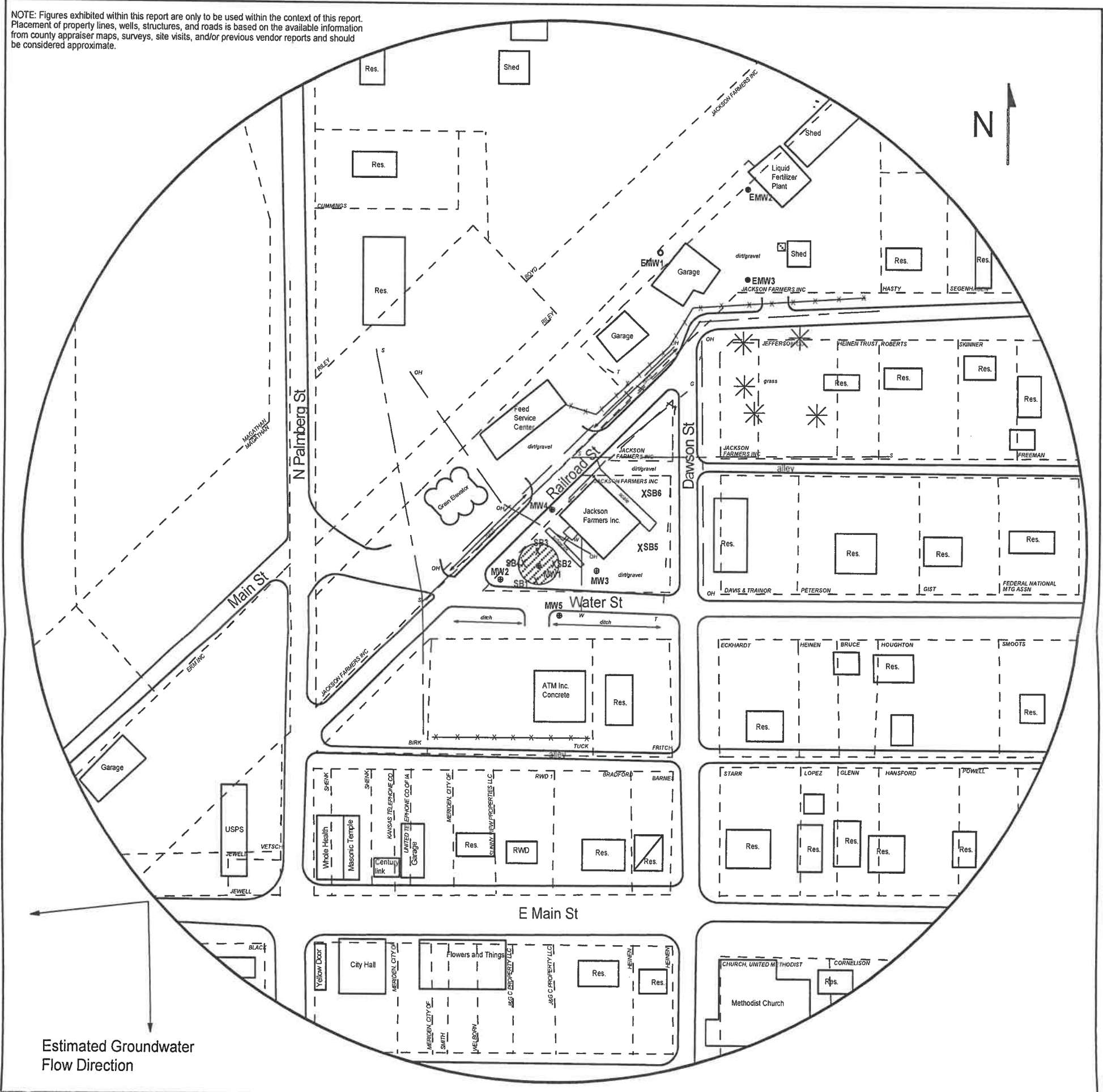

FIGURE 2.1 - 700 FT RADIUS AREA BASE MAP

**LEGEND:**

- Approximate Location of Former bulk fuel storage
- Approximate Location of Active AST
- Destroyed Monitoring Well
- Existing Monitoring Well
- New Monitoring Well (drilled 3/20-21/23)
- Soil Boring (drilled 3/20-21/23)
- Overhead Lines (25-40 ft high)
- Water (2 - 6 ft BGS)
- Sewer (2 - 6 ft BGS)
- Gas (2 - 6 ft BGS)
- Telephone (2 - 6 ft BGS)

NOTE: Utility depths, heights and locations are approximate.



1311 E 25th St., Suite B (785) 841-8707 office  
Lawrence, KS 66046 (785) 865-4282 fax

PROJECT: T.10 R.17E  
FCA - Meriden Sec. 7  
201 Dawson, Jefferson  
Meriden, KS County  
KDHE ID: A4-044-40302  
Date: 3/21-22/23

0 100 feet

RECEIVED  
 MAY 30 2023  
 BUREAU OF WATER