

CORRECTED

WATER WELL RECORD

Form WWC-5

Division of Water Resources App. No.

Well ID

MW3

Original Record Correction Change in Well Use

1 LOCATION OF WATER WELL: County Jefferson Fraction NE 1/4 SW 1/4 NW 1/4 SW 1/4 Section Number 7 Township Number T 10 S Range Number R 17 E

2 WELL OWNER: Last Name: Business: KDHE (FCA - Meriden) Address: 1000 SW Jackson Blvd City: Topeka State: KS ZIP: 66612 Street or Rural Address where well is located (if unknown, distance and direction from nearest town or intersection): 201 Dawson, Meriden, KS

3 LOCATE WELL WITH "X" IN SECTION BOX: N NW NE SW SE S

4 DEPTH OF COMPLETED WELL: 15 ft Depth(s) Groundwater Encountered: 1) 15 ft 2) ft 3) ft, or 4) Dry Well WELL'S STATIC WATER LEVEL: 5.26 ft

5 Latitude: 39.19205 (decimal degrees) Longitude: 95.56945 (decimal degrees) Horizontal Datum: X WGS 84 Source for Latitude/Longitude: X Land Survey

6 Elevation: 973.25 ft Ground Level: X TOC Source: X Land Survey

7 WELL WATER TO BE USED AS: 1 Domestic: Household Lawn & Garden Livestock Irrigation Feedlot Industrial 5 Public Water Supply: well ID 6 Dewatering: how many wells? 7 Aquifer Recharge: well ID 8 Monitoring: well ID MW3 9 Environmental Remediation: well ID 10 Oil Field Water Supply: lease 11 Test Hole: well ID 12 Geothermal: How many bores?

Was a chemical/bacteriological sample submitted to KDHE? Yes No If yes, date sample was submitted: Water well disinfected? Yes No

8 TYPE OF CASING USED: Steel PVC Other CASING JOINTS: Glued Clamped Welded Threaded Casing diameter 2 in. to 5 ft. Diameter in. to ft. Casing height above land surface -0.27 in. Weight lbs./ft. Well thickness or gauge No TYPE OF SCREEN OR PERFORATION MATERIAL: Steel Stainless Steel Fiberglass PVC Brass Galvanized Steel Concrete tile None used (open hole) SCREEN OR PERFORATION OPENINGS ARE: Continuous Slot Mill Slot Gauze Wrapped Torch Cut Drilled Holes Other (Specify) Louvered Shutter Key Punched Wire Wrapped Saw Cut None (Open Hole) SCREEN-PERFORATED INTERVALS: From 5 ft. to 15 ft. GRAVEL PACK INTERVALS: From 3 ft. to 15 ft.

9 GROUT MATERIAL: Neat cement Cement grout Bentonite Other Concrete: 0-0.5' Grout intervals: From 0.5 ft. to 3 ft. From ft. to ft. From ft. to ft.

Nearest source of possible contamination: Septic Tank Lateral Lines Pit Privy Livestock Pens Insecticide Storage Sewer Lines Cess Pool Sewage Lagoon Fuel Storage Abandoned Water Well Watertight Sewer Lines Seepage Pit Feedyard Fertilizer Storage Oil Well / Gas Well Other (Specify) Direction from well? W Distance from well? -60 ft

Table with 6 columns: FROM, TO, LITHOLOGIC LOG, FROM, TO, LITHO. LOG (cont.) or PLUGGING INTERVALS. Rows show soil layers: Topsoil (0-0.8 ft), Silty clay (0.8-1.5 ft), Clay (1.5-12 ft), Shale (12-15 ft).

Notes: KDHE ID: FCA - Meriden; A4-044-40302 Target of monitoring well is shallow groundwater, <20' of grout was installed at the direction of KDHE.

11 CONTRACTOR'S OR LANDOWNER'S CERTIFICATION: This water well was constructed reconstructed or plugged under my jurisdiction and was completed on (mo-day-year) 3/20/23 and this record is true to the best of my knowledge and belief. Kansas Water Well Contractor's License No 757 This Water Well Record was completed on (mo-day-year) 4/13/23 under the business name of Larsen & Associates, Inc. Signature

DENNIS L HANDKE

1820 NW 59th Terrace
TOPEKA, KANSAS 66618
785-286-4047 Home

Jess Chapman
Larsen & Associates
1311 E. 25th Street, Suite B
Lawrence, Kansas, 66046

April 10, 2023

RE: Monitor Well Elevation Survey
201 Dawson, Meriden, Kansas

T, 10 R. 17E
Sec. 7
Jefferson
County

Proj. 23-00K
FCA - Meriden
A4-044-40302

Bench Mark: Sq. cut on NE corner of concrete scale platform East of the office building.
Elev: 974.50 North 1907.94 West 4849.43 (from SE Cor. Sec. 7-10-17E)

MW-1	rim	971.48	North	1788.99	NE1/4,SW1/4,NW1/4,SW1/4
	top pipe	970.86	West	4934.97	Lat = 39.19204 Long = 95.56973
MW-2	rim	971.05	North	1777.52	NW1/4,SW1/4,NW1/4,SW1/4
	top pipe	970.53	West	4987.24	Lat = 39.19201 Long = 95.56991
MW-3	rim	973.52	North	1789.21	NE1/4,SW1/4,NW1/4,SW1/4
	top pipe	973.25	West	4857.52	Lat = 39.19205 Long = 95.56945
MW-4	rim	972.98	North	1965.03	NE1/4,SW1/4,NW1/4,SW1/4
	top pipe	972.36	West	4918.85	Lat = 39.19225 Long = 95.56968
MW-5	rim	970.99	North	1730.13	NE1/4,SW1/4,NW1/4,SW1/4
	top pipe	970.50	West	4903.41	Lat = 39.19188 Long = 95.56961
EMW-2	rim	976.46	North	2282.75	SE1/4,NW1/4,NW1/4,SW1/4
	top pipe	976.24	West	4668.13	Lat = 39.19341 Long = 95.56882
EMW-3	rim	975.86	North	2142.30	SE1/4,NW1/4,NW1/4,SW1/4
	top pipe	975.57	West	4679.99	Lat = 39.19303 Long = 95.56885

Lat & Long derived from Meriden 7.5 quad map. WGS84

Elevation established from USGS BM W 122 "1934". NAVD 88

If you have any questions, please feel free to call me. Thank you for the opportunity to be of service to you.



RECEIVED
MAY 30 2023
BUREAU OF WATER

NOTE: Figures exhibited within this report are only to be used within the context of this report. Placement of property lines, wells, structures, and roads is based on the available information from county appraiser maps, surveys, site visits, and/or previous vendor reports and should be considered approximate.

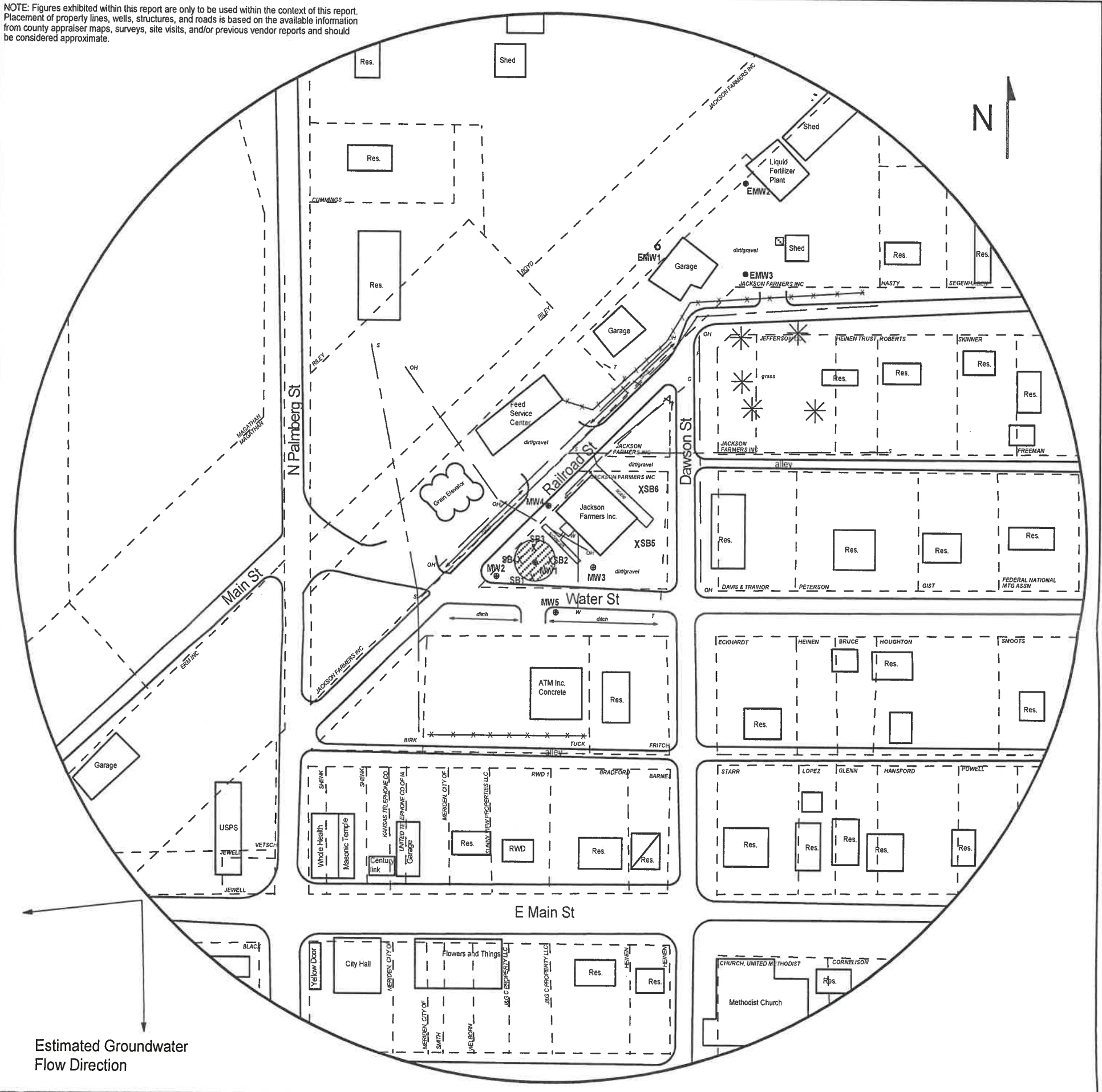

FIGURE 2.1 - 700 FT RADIUS AREA BASE MAP

LEGEND:

- Approximate Location of Former bulk fuel storage
- Approximate Location of Active AST
- Destroyed Monitoring Well
- Existing Monitoring Well
- New Monitoring Well (drilled 3/20-21/23)
- Soil Boring (drilled 3/20-21/23)
- Overhead Lines (25-40 ft high)
- Water (2 - 6 ft BGS)
- Sewer (2 - 6 ft BGS)
- Gas (2 - 6 ft BGS)
- Telephone (2 - 6 ft BGS)

NOTE: Utility depths, heights and locations are approximate.



1311 E 25th St., Suite B (785) 841-8707 office
Lawrence, KS 66046 (785) 865-4282 fax

PROJECT: T.10 R.17E
FCA - Meriden SEC. 7
201 Dawson, Jefferson
Meriden, KS County
KDHE ID: A4-044-40302
Date: 3/21-22/23



RECEIVED
 MAY 30 2023
 BUREAU OF WATER