

WATER WELL RECORD

Form WWC-5

Division of Water Resources App. No.

Well ID

MW3

Original Record Correction Change in Well Use

1 LOCATION OF WATER WELL: County Wyandotte Fraction SE 1/4 SW 1/4 SW 1/4 SE 1/4 Section Number 34 Township Number T 10 S Range Number R 23 E W

2 WELL OWNER: Last Name: Business: Star Fuel Centers, Inc. Address: 7415 W 130th St., Suite 100 City: Overland Park State: KS ZIP: 66213 Street or Rural Address where well is located (if unknown, distance and direction from nearest town or intersection): 10950 Parallel Parkway, Kansas City, KS

3 LOCATE WELL WITH "X" IN SECTION BOX: N NW NE SW SE S X

4 DEPTH OF COMPLETED WELL: 18 ft Depth(s) Groundwater Encountered: 1) 18 ft 2) ft 3) ft, or 4) Dry Well WELL'S STATIC WATER LEVEL: 2.31 ft. X below land surface, measured on (mo-day-yr) 1/15-16/20

5 Latitude: 39.12886 (decimal degrees) Longitude: 94.83471 (decimal degrees) Horizontal Datum: X WGS 84 NAD 83 NAD 27 Source for Latitude/Longitude: GPS (unit make/model:) (WAAS enabled? Yes No) X Land Survey Topographic Map Online Mapper

6 Elevation: 1018.68 ft Ground Level: X TOC Source: X Land Survey GPS Topographic Map Other

7 WELL WATER TO BE USED AS: 1 Domestic: Household Lawn & Garden Livestock Irrigation Feedlot Industrial 5 Public Water Supply: well ID 6 Dewatering: how many wells? 7 Aquifer Recharge: well ID 8 X Monitoring: well ID MW3 9 Environmental Remediation: well ID Air Sparge Soil Vapor Extractor Recovery Injection 10 Oil Field Water Supply: lease 11 Test Hole: well ID Cased Uncased Geotechnical 12 Geothermal: How many bores? a) Closed Loop Horizontal Vertical b) Open Loop Surface Discharge Inj. of Water Other (specify):

Was a chemical/bacteriological sample submitted to KDHE? Yes No X No If yes, date sample was submitted: Water well disinfected? Yes No X No

8 TYPE OF CASING USED: Steel PVC X Other CASING JOINTS: Glued Clamped Welded X Threaded Casing diameter 2 in. to 8 ft, Diameter in. to ft, Diameter in. to ft, Casing height above land surface -0.31 in. Weight lbs./ft. Well thickness or gauge No TYPE OF SCREEN OR PERFORATION MATERIAL: Steel Stainless Steel Fiberglass X PVC Other (Specify) Brass Galvanized Steel Concrete tile None used (open hole) SCREEN OR PERFORATION OPENINGS ARE: Continuous Slot X Mill Slot Gauze Wrapped Torch Cut Drilled Holes Other (Specify) Louvered Shutter Key Punched Wire Wrapped Saw Cut None (Open Hole) SCREEN-PERFORATED INTERVALS: From 8 ft. to 18 ft, From ft. to ft, From ft. to ft, GRAVEL PACK INTERVALS: From 6 ft. to 18 ft, From ft. to ft, From ft. to ft,

9 GROUT MATERIAL: Neat cement Cement grout X Bentonite X Other Concrete: 0-0.5' Grout intervals: From 0.5 ft. to 6 ft, From ft. to ft, From ft. to ft,

Nearest source of possible contamination: Septic Tank Lateral Lines Pit Privy Livestock Pens Insecticide Storage Sewer Lines Cess Pool Sewage Lagoon X Fuel Storage Abandoned Water Well Watertight Sewer Lines Seepage Pit Feedyard Fertilizer Storage Oil Well / Gas Well Other (Specify) Direction from well? E Distance from well? ~50 ft

10 FROM TO LITHOLOGIC LOG FROM TO LITHO. LOG (cont.) or PLUGGING INTERVALS

Notes: KDHE ID: 7-11Star Fuel #707; U4-105-15169 Target of monitoring well is shallow groundwater, <20' of grout was installed at the direction of KDHE.

11 CONTRACTOR'S OR LANDOWNER'S CERTIFICATION: This water well was X constructed, reconstructed, or plugged under my jurisdiction and was completed on (mo-day-year) 1/14/20 and this record is true to the best of my knowledge and belief. Kansas Water Well Contractor's License No 757 This Water Well Record was completed on (mo-day-year) 1/30/20 under the business name of Larsen & Associates, Inc. Signature

Mail 1 white copy along with a fee of \$5.00 for each constructed well to: Kansas Department of Health and Environment, Bureau of Water, GWS Section, 1000 SW Jackson St., Suite 420, Topeka, Kansas 66612-1367. Mail one to Water Well Owner and retain one for your records. Telephone 785-296-5524.

Wyandotte

54-110-R23E

DENNIS L HANDKE

1820 NW 59th Terrace
TOPEKA, KANSAS 66618
785-286-4047 Home

Jess Chapman
Larsen & Associates
1311 E. 25th Street, Suite B
Lawrence, Kansas, 66046

January 28, 2020

RE: Monitor Well Elevation Survey
10950 Parallel Parkway, Kansas City, Kansas

Proj. 20-00C
7-11/Star Fuel #707
U4-105-15169

Bench Mark: Chisled Square on Northeast corner of concrete storm inlet at Southwest corner of property.
Elev: 1020.75 North 64.47 West 2248.42 (from SE Cor. Sec. 34-10-23E)

MW-1	rim	1018.11	North	118.17	SE1/4,SW1/4,SW1/4,SE1/4
	top pipe	1017.79	West	2051.50	Lat= 39.12898 Long = 94.83408
MW-2	rim	1018.87	North	76.72	SE1/4,SW1/4,SW1/4,SE1/4
	top pipe	1018.61	West	2134.73	Lat= 39.12887 Long = 94.83438
MW-3	rim	1018.99	North	75.16	SE1/4,SW1/4,SW1/4,SE1/4
	top pipe	1018.68	West	2229.74	Lat= 39.12886 Long = 94.83471
MW-4	rim	1016.70	North	149.78	SE1/4,SW1/4,SW1/4,SE1/4
	top pipe	1016.35	West	2255.93	Lat= 39.12907 Long = 94.83480
MW-5	rim	1017.00	North	249.35	SE1/4,SW1/4,SW1/4,SE1/4
	top pipe	1016.63	West	2117.46	Lat= 39.12934 Long = 94.83431
MW-6	rim	1016.89	North	167.40	SE1/4,SW1/4,SW1/4,SE1/4
	top pipe	1016.66	West	2033.88	Lat= 39.12911 Long = 94.83402

Lat & Long derived from Wolcott 7.5 quad map. WGS84.

Elevation established from USGS BM TT16 0 1933. NAVD 88

If you have any questions, please feel free to call me. Thank you for the opportunity to be of service to you.

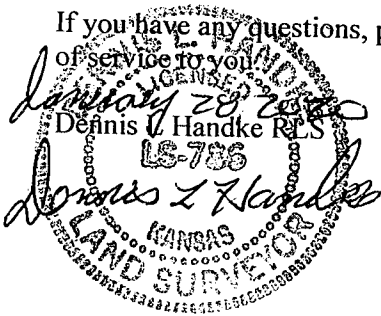

NOTE: Figures exhibited within this report are only to be used within the context of this report. Placement of property lines, wells, structures, and roads is based on the available information from county appraiser maps, surveys, site visits, and/or previous vendor reports and should be considered approximate.

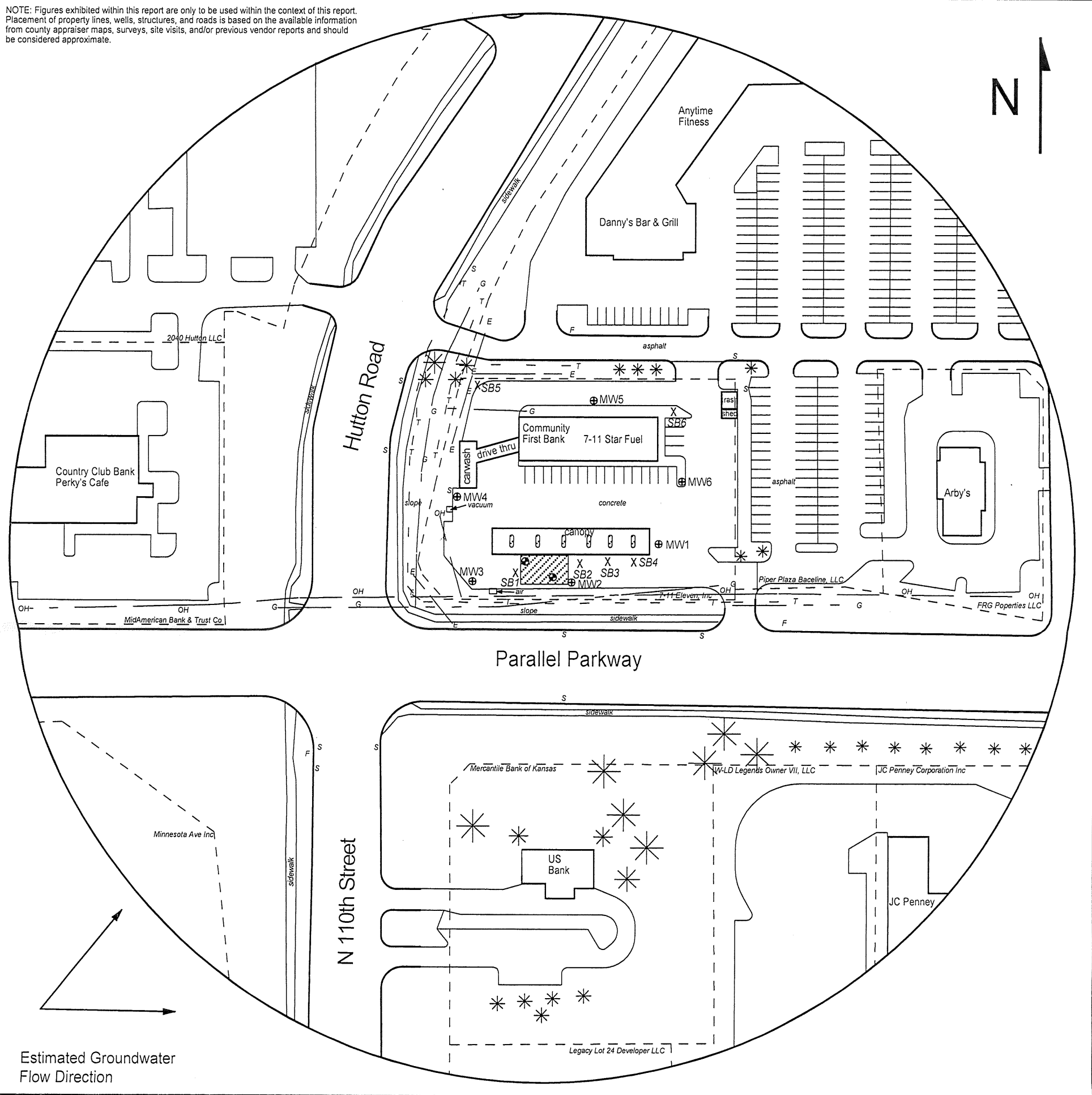

FIGURE 2.2 - 500 FT RADIUS AREA BASE MAP

LEGEND

- Approximate Location of Active UST Basin & Pump Islands
- Approximate Location of Property Line
- Observation Well
- Monitoring Well (Installed 1/13-15/20)
- Soil Boring (Drilled 1/14-15/20)
- Fire Hydrant
- Gas Lines (1.5 - 3 ft bgs)
- Overhead Lines (25'-40' high)
- Sewer Lines (2 - 6 ft bgs)
- Telephone Lines (2 - 6 ft bgs)
- Water Lines (2 - 6 ft bgs)

NOTE: SB5 & SB6 were drilled to collect hydrologic samples.
 NOTE: Utility depths, heights and locations are approximate.
 NOTE: Location of active product lines is unknown.

PROJECT:

7-11 Star Fuel #707
 10950 Parallel Parkway
 Kansas City, KS
 KDHE ID: U4-105-15169
 Date: 1/15-16/20

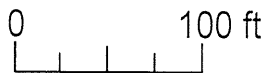

1311 E 25th St., Suite B 785-841-8707 office
 Lawrence, KS 66046 785-865-4282 fax