

WATER WELL RECORD

Form WWC-5

Division of Water Resources App. No.

Well ID

MW3

Original Record Correction Change in Well Use

1 LOCATION OF WATER WELL: County Wyandotte Fraction NE 1/4 NE 1/4 NE 1/4 NE 1/4 Section Number 35 Township Number T 10 S Range Number R 24 E W

2 WELL OWNER: Last Name: First: Street or Rural Address where well is located (if unknown, distance and direction from nearest town or intersection): If at owner's address, check here: ~240' SW-W of the SW corner of Leavenworth Rd & 51st St., Kansas City, KS

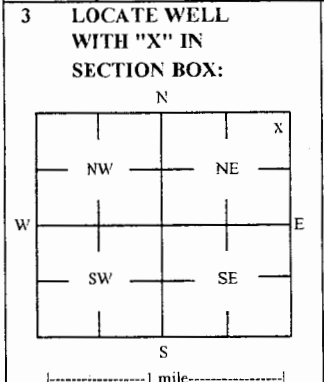

3 LOCATE WELL WITH 'X' IN SECTION BOX: 4 DEPTH OF COMPLETED WELL: 15 ft Depth(s) Groundwater Encountered: 1) ft 2) ft 3) ft or 4) Dry Well WELL'S STATIC WATER LEVEL: 5.3 ft

5 Latitude: 39.14255 (decimal degrees) Longitude: 94.69739 (decimal degrees) Horizontal Datum: WGS 84 NAD 83 NAD 27 Source for Latitude/Longitude: GPS (unit make/model: ) (WAAS enabled? Yes No) Land Survey Topographic Map Online Mapper

7 WELL WATER TO BE USED AS: 1 Domestic: Household Lawn & Garden Livestock Irrigation Feedlot Industrial 5 Public Water Supply: well ID 6 Dewatering: how many wells? 7 Aquifer Recharge: well ID 8 Monitoring: well ID MW3 9 Environmental Remediation: well ID Air Sparge Soil Vapor Extractor Recovery Injection 10 Oil Field Water Supply: lease 11 Test Hole: well ID Cased Uncased Geotechnical 12 Geothermal: How many bores? a) Closed Loop Horizontal Vertical b) Open Loop Surface Discharge Inj. of Water Other (specify):

Was a chemical/bacteriological sample submitted to KDHE? Yes No If yes, date sample was submitted: Water well disinfected? Yes No

8 TYPE OF CASING USED: Steel PVC Other CASING JOINTS: Glued Clamped Welded Threaded Casing diameter 2 in. to 5 ft. Diameter in. to ft. Diameter in. to ft. Casing height above land surface -0.49 in. Weight lbs./ft. Well thickness or gauge No TYPE OF SCREEN OR PERFORATION MATERIAL: Steel Stainless Steel Fiberglass PVC Other (Specify) Brass Galvanized Steel Concrete tile None used (open hole) SCREEN OR PERFORATION OPENINGS ARE: Continuous Slot Mill Slot Gauze Wrapped Torch Cut Drilled Holes Other (Specify) Louvered Shutter Key Punched Wire Wrapped Saw Cut None (Open Hole) SCREEN-PERFORATED INTERVALS: From 5 ft. to 15 ft. From ft. to ft. From ft. to ft. GRAVEL PACK INTERVALS: From 3 ft. to 15 ft. From ft. to ft. From ft. to ft.

9 GROUT MATERIAL: Neat cement Cement grout Bentonite Other Concrete: 0-1' Grout intervals: From 1 ft. to 3 ft. From ft. to ft. From ft. to ft.

Nearest source of possible contamination: Septic Tank Lateral Lines Pit Privy Livestock Pens Insecticide Storage Sewer Lines Cess Pool Sewage Lagoon Fuel Storage Abandoned Water Well Watertight Sewer Lines Seepage Pit Feedyard Fertilizer Storage Oil Well / Gas Well Other (Specify): Direction from well? Unknown Distance from well? Unknown ft

Table with columns: FROM, TO, LITHOLOGIC LOG, FROM, TO, LITHO. LOG (cont.) or PLUGGING INTERVALS. Row 1: 0 to 0.5, Gravel and broken asphalt. Row 2: 0.5 to 15, Silty clay.

Notes: KDHE ID: Former Station; U4-105-15057 Target of monitoring well is shallow groundwater, <20' of grout was installed at the direction of KDHE.

11 CONTRACTOR'S OR LANDOWNER'S CERTIFICATION: This water well was constructed, reconstructed, or plugged under my jurisdiction and was completed on (mo-day-year) 5/9/18 and this record is true to the best of my knowledge and belief. Kansas Water Well Contractor's License No 757 This Water Well Record was completed on (mo-day-year) 6/5/18 under the business name of Larsen & Associates, Inc. Signature

Wyandotte

36-10-24E

**DENNIS L HANDKE**

1820 NW 59th Terrace  
TOPEKA, KANSAS 66618  
785-286-4047 Home  
785-286-1990 Fax

Jess Chapman  
Larsen & Assoc.  
1311 E. 25<sup>th</sup> St., Suite B  
Topeka, Kansas 66046

May 23, 2018  
Revised June 5, 2018

RE: Monitor Well Elevation Survey  
5030 Leavenworth Road, Kansas City, Kansas

Proj. 18-00Q  
Former Station  
KDHE ID U4-105-15057

Bench Mark: Chisled square on West end of old concrete light base at the SE corner of property.  
Elev.: 966.07      South 14      West 5116      (from SE Cor. Sec. 25-10-24E)

MW-2	rim	961.25	South	90	NW1/4,NW1/4,NW1/4,NW1/4 (Sec. 36-10-24E)
	top pipe	960.96	West	5248	Lat = 39.14280    Long = 94.69642
MW-3	rim	944.73	South	184	NE1/4,NE1/4,NE1/4,NE1/4 (Sec. 35-10-24E)
	top pipe	944.24	West	5520	Lat = 39.14255    Long = 94.69739
MW-4	rim	963.92	North	29	SW1/4,SW1/4,SW1/4,SW1/4 (Sec. 25-10-24E)
	top pipe	963.59	West	5166	Lat = 39.14313    Long = 94.69613
MW-5	rim	961.80	South	188	NW1/4,NW1/4,NW1/4,NW1/4 (Sec. 36-10-24E)
	top pipe	961.44	West	5250	Lat = 39.14253    Long = 94.69643

Lat & Long derived from Parkville 7.5' quad map. WGS84.

Elevation derived from BM #6 of Leavenworth Road Street Project NAVD 83.

If you have any questions, please feel free to call me. Thank you for the opportunity to be of service to you.

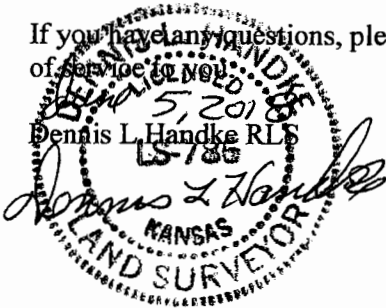

Wyandotte 36-10-24E

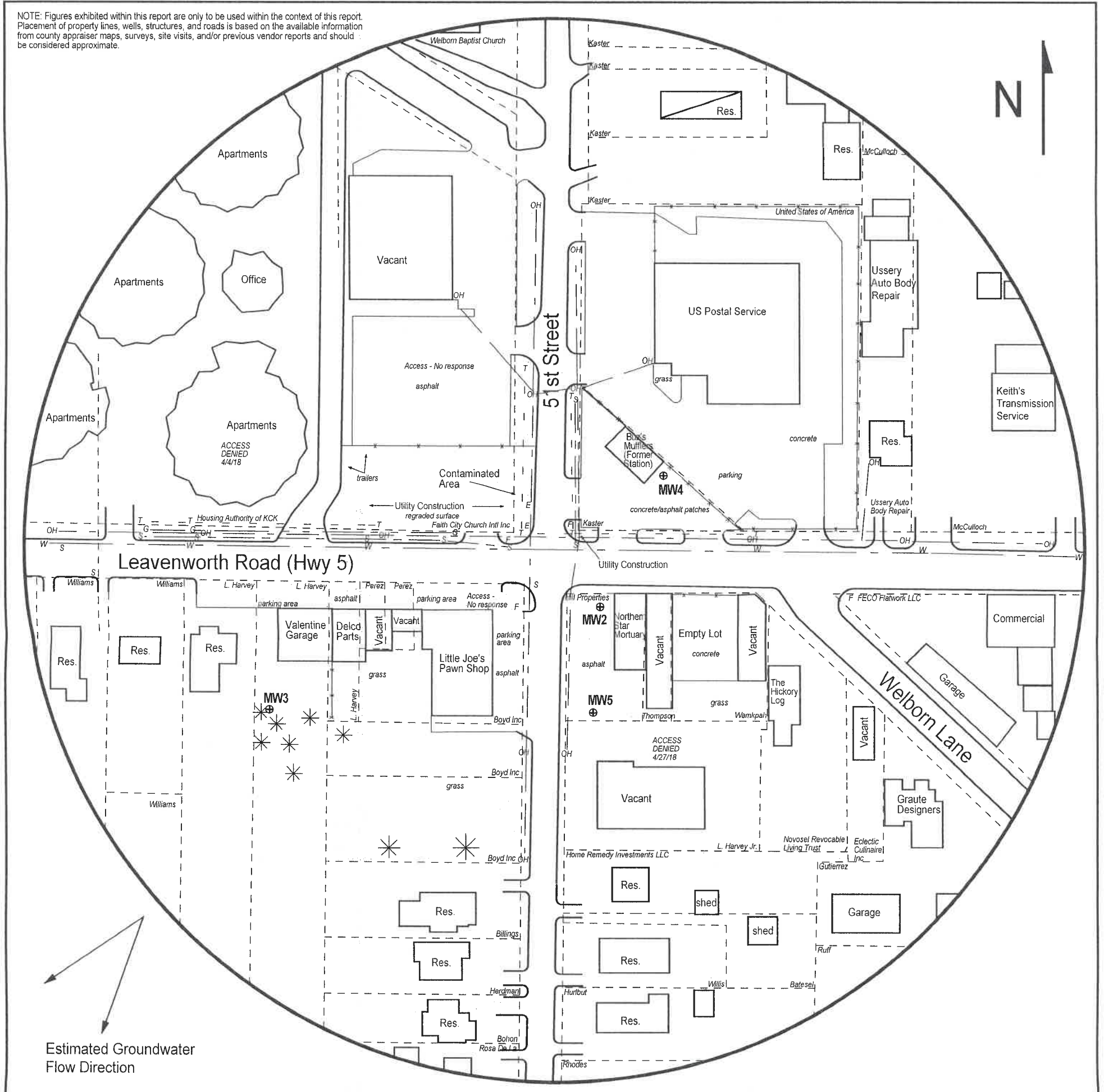

**FIGURE 2.2 - 500 FT RADIUS AREA BASE MAP**

**LEGEND:**

- Building with Basement
- Approximate Location of Property Line
- Monitoring Well (Installed 5/8-9/18)
- Electric Meter
- Fire Hydrant
- Gas Lines (2 - 6 ft BGS)
- Sanitary Sewer (2 - 6 ft BGS)
- Overhead Lines (25-40 ft high)
- Telephone Lines (2 - 6 ft BGS)
- Water Lines (2 - 6 ft BGS)

NOTE: Utility depths, heights and locations are approximate.



**PROJECT:**  
 Former Station  
 5030 Leavenworth Rd.  
 Kansas City, KS  
 KDHE ID: U4-105-15057  
 Date: 6/1/18

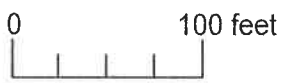

1311 E 25th St., Suite B (785) 841-8707 office  
 Lawrence, KS 66046 (785) 865-4282 fax

RECEIVED  
 JUN 28 2018  
 BUREAU OF WATER