

WATER WELL RECORD

Form WWC-5

Division of Water Resources App. No.

Well ID

MW15

[X] Original Record [ ] Correction [ ] Change in Well Use

1 LOCATION OF WATER WELL: County Wyandotte Fraction NE 1/4 NE 1/4 NE 1/4 NE 1/4 Section Number 35 Township Number T 10 S Range Number R 24 [X] E [ ] W

2 WELL OWNER: Last Name: Business: KDHE Address: 1000 SW Jackson Blvd City Topeka State: KS ZIP: 66612 Street or Rural Address where well is located (if unknown, distance and direction from nearest town or intersection): If at owner's address, check here: [ ] 245' SW of the SW corner of Leavenworth Rd & 51st St., Kansas City, KS

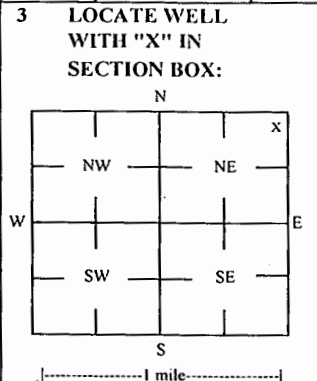

3 LOCATE WELL WITH "X" IN SECTION BOX: 4 DEPTH OF COMPLETED WELL: 13.5 ft Depth(s) Groundwater Encountered: 1) 13.5 ft 2) ft 3) ft or 4) [ ] Dry Well WELL'S STATIC WATER LEVEL: 4.66 ft. [X] below land surface, measured on (mo-day-yr) 5/22/19 [ ] above land surface, measured on (mo-day-yr) Pump test data: Well water was ft after hours pumping gpm Water well was ft after hours pumping gpm Estimated Yield: gpm Bore Hole Diameter: 7.25 in to ft, and in to ft

5 Latitude: 39.14245 (decimal degrees) Longitude: 94.69738 (decimal degrees) Horizontal Datum: [ ] WGS 84 [X] NAD 83 [ ] NAD 27 Source for Latitude/Longitude: [ ] GPS (unit make/model: ) (WAAS enabled? [ ] Yes [ ] No) [X] Land Survey [ ] Topographic Map [ ] Online Mapper 6 Elevation 943.83 ft [ ] Ground Level [X] TOC Source [X] Land Survey [ ] GPS [ ] Topographic Map [ ] Other

7 WELL WATER TO BE USED AS: 1 Domestic: [ ] Household [ ] Lawn & Garden [ ] Livestock 2 Irrigation 3 Feedlot 4 Industrial 5 Public Water Supply: well ID 6 Dewatering: how many wells? 7 Aquifer Recharge: well ID 8 [X] Monitoring: well ID MW15 9 Environmental Remediation: well ID [ ] Air Sparge [ ] Soil Vapor Extractor [ ] Recovery [ ] Injection 10 Oil Field Water Supply: lease 11 Test Hole: well ID [ ] Cased [ ] Uncased [ ] Geotechnical 12 Geothermal: How many bores? a) Closed Loop [ ] Horizontal [ ] Vertical b) Open Loop [ ] Surface Discharge [ ] Inj. of Water [ ] Other (specify):

Was a chemical/bacteriological sample submitted to KDHE? [ ] Yes [X] No If yes, date sample was submitted: Water well disinfected? [ ] Yes [X] No

8 TYPE OF CASING USED: [ ] Steel [X] PVC [ ] Other CASING JOINTS: [ ] Glued [ ] Clamped [ ] Welded [X] Threaded Casing diameter 2 in. to 3.5 ft, Diameter in. to ft, Diameter in. to ft, Casing height above land surface -0.61 in. Weight lbs./ft. Well thickness or gauge No TYPE OF SCREEN OR PERFORATION MATERIAL: [ ] Steel [ ] Stainless Steel [ ] Fiberglass [X] PVC [ ] Other (Specify) [ ] Brass [ ] Galvanized Steel [ ] Concrete tile [ ] None used (open hole) SCREEN OR PERFORATION OPENINGS ARE: [ ] Continuous Slot [X] Mill Slot [ ] Gauze Wrapped [ ] Torch Cut [ ] Drilled Holes [ ] Other (Specify) [ ] Louvered Shutter [ ] Key Punched [ ] Wire Wrapped [ ] Saw Cut [ ] None (Open Hole) SCREEN-PERFORATED INTERVALS: From 3.5 ft. to 13.5 ft, From ft. to ft, From ft. to ft, GRAVEL PACK INTERVALS: From 2 ft. to 13.5 ft, From ft. to ft, From ft. to ft,

9 GROUT MATERIAL: [ ] Neat cement [ ] Cement grout [X] Bentonite [X] Other Concrete: 0-0.7' Grout intervals: From 0.7 ft. to 2 ft, From ft. to ft, From ft. to ft,

Nearest source of possible contamination: [ ] Septic Tank [ ] Lateral Lines [ ] Pit Privy [ ] Livestock Pens [ ] Insecticide Storage [ ] Sewer Lines [ ] Cess Pool [ ] Sewage Lagoon [X] Fuel Storage [ ] Abandoned Water Well [ ] Watertight Sewer Lines [ ] Seepage Pit [ ] Feedyard [ ] Fertilizer Storage [ ] Oil Well / Gas Well [ ] Other (Specify)

Direction from well? Unknown Distance from well? Unknown ft

Table with 6 columns: FROM, TO, LITHOLOGIC LOG, FROM, TO, LITHO. LOG (cont.) or PLUGGING INTERVALS. Rows show depth intervals from 0 to 13.5 ft with lithology descriptions like 'Gravel w/ silty clay' and 'Silty clay w/ weathered shale'.

Notes: KDHE ID: Former Station; U4-105-15057 Target of monitoring well is shallow groundwater, <20' of grout was installed at the direction of KDHE.

11 CONTRACTOR'S OR LANDOWNER'S CERTIFICATION: This water well was [X] constructed, [ ] reconstructed, or [ ] plugged under my jurisdiction and was completed on (mo-day-year) 5/22/19 and this record is true to the best of my knowledge and belief. Kansas Water Well Contractor's License No 757 This Water Well Record was completed on (mo-day-year) 6/11/19 under the business name of Larsen & Associates, Inc. Signature

Mail 1 white copy along with a fee of \$5.00 for each constructed well to: Kansas Department of Health and Environment, Bureau of Water, OWTS Section, 1000 SW Jackson St., Suite 420, Topeka, Kansas 66612-1367. Mail one to Water Well Owner and retain one for your records. Telephone 785-296-5524.

# DENNIS L HANDKE

1820 NW 59th Terrace  
TOPEKA, KANSAS 66618  
785-286-4047 Home  
785-286-1990 Fax

Jess Chapman  
Larsen & Assoc.  
1311 E. 25<sup>th</sup> St., Suite B  
Topeka, Kansas 66046

May 27, 2019  
Revised June 12, 2019

RE: Monitor Well Elevation Survey  
5030 Leavenworth Road, Kansas City, Kansas

Proj. 19-00S  
Former Station  
KDHE ID U4-105-15057

Bench Mark: Chisled X on top SW bolt of fire hydrant at the SW corner of property.  
Elev.: 963.32      South 3      West 5263      (from SE Cor. Sec. 25-10-24E)

MW-2R	rim	961.12	South	90	NW1/4,NW1/4,NW1/4,NW1/4 (Sec. 36-10-24E)
	top pipe	960.75	West	5248	Lat = 39.14280    Long = 94.69643
MW-6	rim	967.45	South	168	SW1/4,SW1/4,SW1/4,SW1/4 (Sec. 25-10-24E)
	top pipe	967.01	West	5232	Lat = 39.14352    Long = 94.69636
MW-7	rim	969.15	North	109	SW1/4,SW1/4,SW1/4,SW1/4 (Sec. 25-10-24E)
	top pipe	968.80	West	5164	Lat = 39.14335    Long = 94.69611
MW-8	rim	959.21	South	14	SE1/4,SE1/4,SE1/4,SE1/4 (Sec. 26-10-24E)
	top pipe	958.75	West	5335	Lat = 39.14310    Long = 94.69673
MW-9	rim	944.22	South	223	NE1/4,NE1/4,NE1/4,NE1/4 (Sec. 35-10-24E)
	top pipe	943.74	West	5538	Lat = 39.14245    Long = 94.69745
MW-10	rim	959.88	North	41	SE1/4,SE1/4,SE1/4,SE1/4 (Sec. 26-10-24E)
	top pipe	959.53	West	5463	Lat = 39.14317    Long = 94.69718
MW-11	rim	954.93	South	84	NE1/4,NE1/4,NE1/4,NE1/4 (Sec. 35-10-24E)
	top pipe	954.60	West	5583	Lat = 39.14283    Long = 94.69761
MW-12	rim	964.25	North	203	NW1/4,NW1/4,NW1/4,NW1/4 (Sec. 36-10-24E)
	top pipe	963.93	West	5022	Lat = 39.14249    Long = 94.69563
MW-13	rim	962.32	South	18	SW1/4,SW1/4,SW1/4,SW1/4 (Sec.25-10-24E)
	top pipe	961.91	West	5234	Lat = 39.14310    Long = 94.69637
MW-14	rim	966.17	South	437	SE1/4,NE1/4,NE1/4,NE1/4 (Sec. 35-10-24E)
	top pipe	965.94	West	5315	Lat = 39.14186    Long = 94.69667
MW-15	rim	944.44	South	223	NE1/4,NE1/4,NE1/4,NE1/4 (Sec. 35-10-24E)
	top pipe	943.83	West	5519	Lat = 39.14245    Long = 94.69738
MW-16	rim	969.47	South	61	SW1/4,SW1/4,SW1/4,SW1/4 (Sec. 25-10-24E)
	top pipe	969.15	West	5025	Lat = 39.14322    Long = 94.69563

RECEIVED

JUL 03 2019

BUREAU OF WATER

Lat & Long derived from Parkville 7.5' quad map. WGS84.

Elevation derived from existing project NAVD 83.

If you have any questions, please feel free to call me. Thank you for the opportunity to be of service to you.

Donus L. Handke R089

LS-736



NOTE: Figures exhibited within this report are only to be used within the context of this report. Placement of property lines, wells, structures, and roads is based on the available information from county appraiser maps, surveys, site visits, and/or previous vendor reports and should be considered approximate.

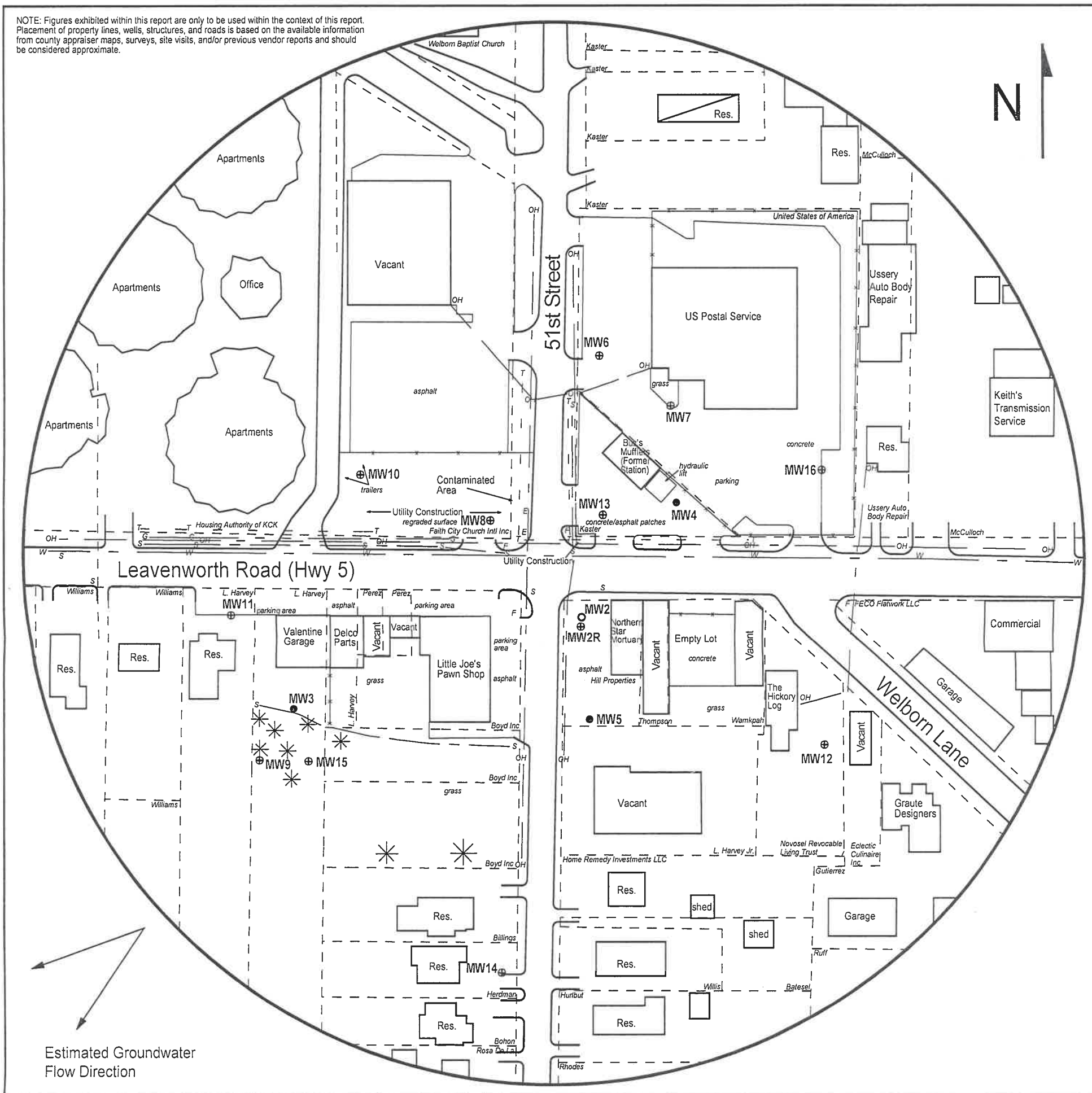

FIGURE 2.2 - 500 FT RADIUS AREA BASE MAP

**LEGEND:**

- Building with Basement
  - Approximate Location of Property Line
  - Monitoring Well (Installed 4/29-30/19, 5/1-2/19 & 5/16/19)
  - Existing Monitoring Well
  - Plugged Well
  - Electric Meter
  - Fire Hydrant
  - Gas Lines (2 - 6 ft BGS)
  - Sanitary Sewer (2 - 6 ft BGS)
  - Overhead Lines (25-40 ft high)
  - Telephone Lines (2 - 6 ft BGS)
  - Water Lines (2 - 6 ft BGS)
- NOTE: Utility depths, heights and locations are approximate.



**PROJECT:**  
 Former Station  
 5030 Leavenworth Rd.  
 Kansas City, KS  
 KDHE ID: U4-105-15057  
 Date: 5/22/19



1311 E 25th St., Suite B (785) 841-8707 office  
 Lawrence, KS 66046 (785) 865-4282 fax

RECEIVED  
 JUL 03 2019  
 BUREAU OF WATER