

WATER WELL RECORD

Form WWC-5

Division of Water Resources App. No.

Well ID

MW17

Original Record Correction Change in Well Use

1 LOCATION OF WATER WELL: County Wyandotte Fraction NE 1/4 NE 1/4 NE 1/4 NE 1/4 Section Number 35 Township Number T 10 S Range Number R 24 E W

2 WELL OWNER: Last Name: Business: KDHE Address: 1000 SW Jackson Blvd City Topeka State: KS ZIP: 66612 Street or Rural Address where well is located (if unknown, distance and direction from nearest town or intersection): 430' SW of the NE corner of Leavenworth Rd & 51st St., Kansas City, KS

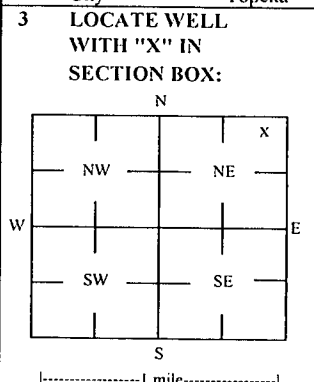

4 DEPTH OF COMPLETED WELL: 16 ft Depth(s) Groundwater Encountered: 1) 16 ft 2) ft 3) ft or 4) Dry Well WELLS STATIC WATER LEVEL: 6.71 ft. X below land surface, measured on (mo-day-yr) 12/9-10/19

5 Latitude: 39.14232 (decimal degrees) Longitude: 94.69755 (decimal degrees) Horizontal Datum: WGS 84 X NAD 83 NAD 27 Source for Latitude/Longitude: GPS (unit make/model) Land Survey X Topographic Map Online Mapper

6 Elevation 950.97 ft Ground Level X TOC Source X Land Survey GPS Topographic Map Other

7 WELL WATER TO BE USED AS: 1 Domestic: Household Lawn & Garden Livestock Irrigation Feedlot Industrial 5 Public Water Supply: well ID 6 Dewatering: how many wells? 7 Aquifer Recharge: well ID 8 X Monitoring: well ID MW17 9 Environmental Remediation: well ID Air Sparge Soil Vapor Extractor Recovery Injection 10 Oil Field Water Supply: lease 11 Test Hole: well ID Cased Uncased Geotechnical 12 Geothermal: How many bores? a) Closed Loop Horizontal Vertical b) Open Loop Surface Discharge Inj. of Water Other (specify):

Was a chemical/bacteriological sample submitted to KDHE? Yes No X No If yes, date sample was submitted: Water well disinfected? Yes No X No

8 TYPE OF CASING USED: Steel X PVC Other CASING JOINTS: Glued Clamped Welded X Threaded Casing diameter 2 in. to 6 ft, Diameter in. to ft, Diameter in. to ft, Casing height above land surface 2.48 in. Weight lbs./ft. Well thickness or gauge No TYPE OF SCREEN OR PERFORATION MATERIAL: Steel Stainless Steel Fiberglass X PVC Other (Specify) SCREEN OR PERFORATION OPENINGS ARE: Continuous Slot X Mill Slot Gauze Wrapped Torch Cut Drilled Holes Other (Specify) Louvered Shutter Key Punched Wire Wrapped Saw Cut None (Open Hole) SCREEN-PERFORATED INTERVALS: From 3.5 ft. to 13.5 ft, From ft. to ft, From ft. to ft, GRAVEL PACK INTERVALS: From 2.5 ft. to 13.5 ft, From ft. to ft, From ft. to ft,

9 GROUT MATERIAL: Neat cement Cement grout X Bentonite X Other Concrete: 0-0.5' Grout intervals: From 0.5 ft. to 2.5 ft, From ft. to ft, From ft. to ft,

Nearest source of possible contamination: Septic Tank Lateral Lines Pit Privy Livestock Pens Insecticide Storage Sewer Lines Cess Pool Sewage Lagoon X Fuel Storage Abandoned Water Well Watertight Sewer Lines Scepage Pit Feedyard Fertilizer Storage Oil Well / Gas Well Other (Specify) Direction from well? Unknown Distance from well? Unknown ft

Table with 6 columns: FROM, TO, LITHOLOGIC LOG, FROM, TO, LITHO. LOG (cont.) or PLUGGING INTERVALS. Row 1: 0, 0.5, Grass/topsoil, , , . Row 2: 0.5, 13.5, Silty clay, , ,

Notes: KDHE ID: Former Station; U4-105-15057 Target of monitoring well is shallow groundwater, <20' of grout was installed at the direction of KDHE.

11 CONTRACTOR'S OR LANDOWNER'S CERTIFICATION: This water well was X constructed, reconstructed, or plugged under my jurisdiction and was completed on (mo-day-year) 12/6/19 and this record is true to the best of my knowledge and belief. Kansas Water Well Contractor's License No 757 This Water Well Record was completed on (mo-day-year) 12/27/19 under the business name of Larsen & Associates, Inc. Signature

# DENNIS L HANDKE

1820 NW 59th Terrace  
TOPEKA, KANSAS 66618  
785-286-4047 Home  
785-286-1990 Fax

Jess Chapman  
Larsen & Assoc.  
1311 E. 25<sup>th</sup> St., Suite B  
Topeka, Kansas 66046

December 18, 2019

RE: Monitor Well Elevation Survey  
5030 Leavenworth Road, Kansas City, Kansas

Proj. 19-0000  
Former Station  
KDHE ID U4-105-15057

Bench Mark: Chisled X on top SW bolt of fire hydrant at the SW corner of property.  
Elev.: 963.32      South 3      West 5263      (from SE Corner Sec. 25-10-24E)

MW-17	rim	948.49	South	269	NE1/4,NE1/4,NE1/4,NE1/4 (Sec. 35-10-24E)
	top pipe	950.97	West	5564	Lat = 39.14232    Long = 94.69755
MW-18	rim	963.54	South	315	NW1/4,NW1/4,NW1/4,NW1/4 (Sec. 36-10-24E)
	top pipe	963.27	West	5061	Lat = 39.14218    Long = 94.69577
MW-19	rim	961.86	South	312	NW1/4,NW1/4,NW1/4,NW1/4 (Sec. 36-10-24E)
	top pipe	961.58	West	4982	Lat = 39.14219    Long = 94.69550
MW-20	rim	965.33	South	155	NW1/4,NW1/4,NW1/4,NW1/4 (Sec. 36-10-24E)
	top pipe	965.03	West	5004	Lat = 39.14265    Long = 94.69556

Lat & Long derived from Parkville 7.5' quad map. WGS84.

Elevation derived from existing Project

If you have any questions, please feel free to call me. Thank you for the opportunity to be of service to you.

December 18, 2019  
Dennis L Handke RES  
LS-703  
*Dennis L Handke*

RECEIVED  
JAN 09 2020  
BUREAU OF WATER

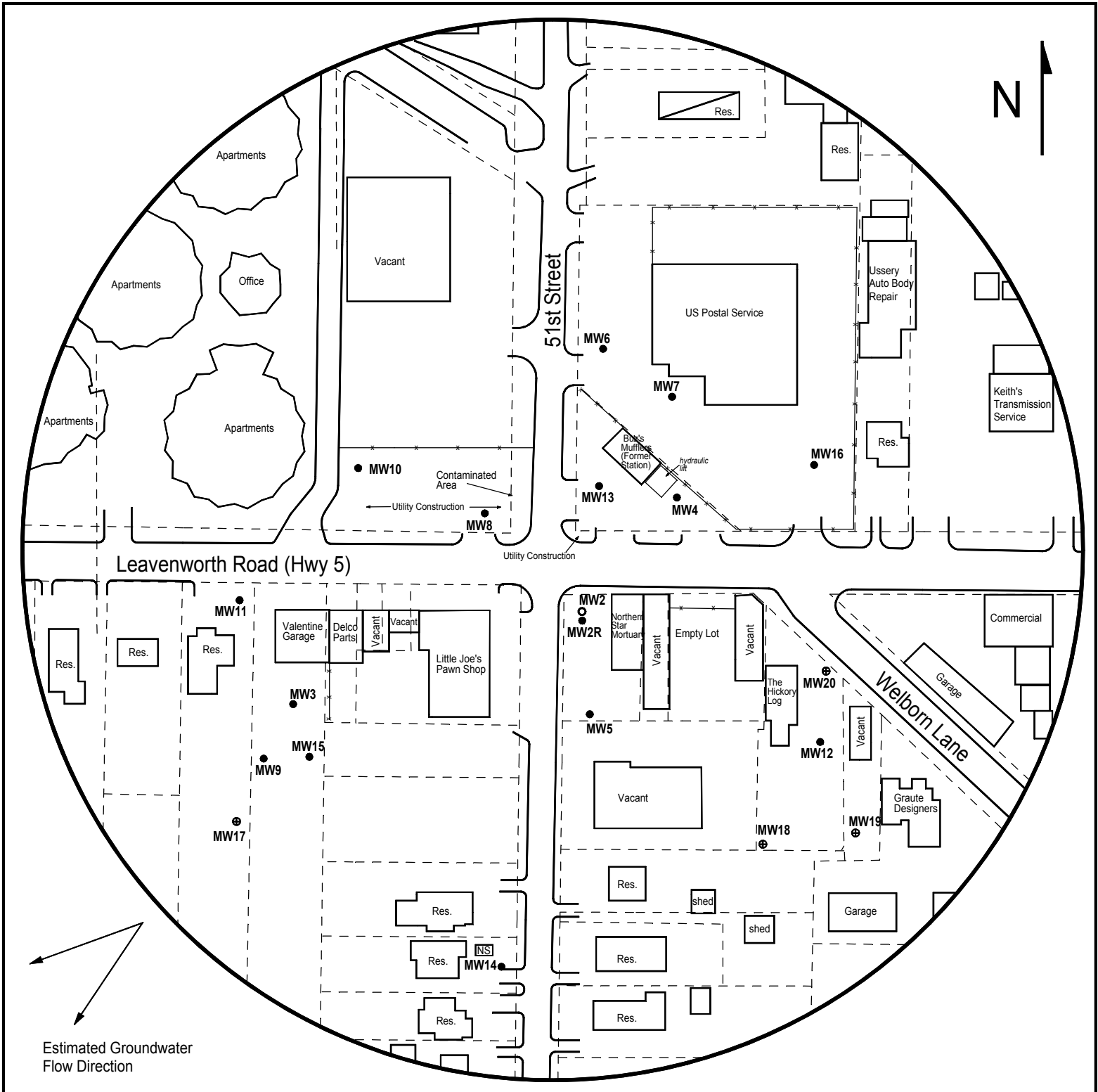

Estimated Groundwater  
Flow Direction

**LEGEND:**

- Building with Basement
- Approximate Location of Property Line
- Existing Monitoring Well
- Monitoring Well (Installed 12/6/19)
- Plugged Well

**PROJECT:**

Former Station  
5030 Leavenworth Rd.  
Kansas City, KS  
KDHE ID: U4-105-15057  
Date: 12/9-10/19



1311 E 25th St., Suite B (785) 841-8707 office  
Lawrence, KS 66046 (785) 865-4282 fax