

WATER WELL RECORD

Form WWC-5

Division of Water Resources App. No.

Well ID

MW19

Original Record Correction Change in Well Ust

1 LOCATION OF WATER WELL: County Wyandotte Fraction NW 1/4 NW 1/4 NW 1/4 Section Number 36 Township Number T 10 S Range Number R 24 E W

2 WELL OWNER: Last Name: Business: KDHE Address: 1000 SW Jackson Blvd City: Topeka State: KS ZIP: 66612 Street or Rural Address where well is located (if unknown, distance and direction from nearest town or intersection): 370' SE of the NE corner of Leavenworth Rd & 51st St., Kansas City, KS

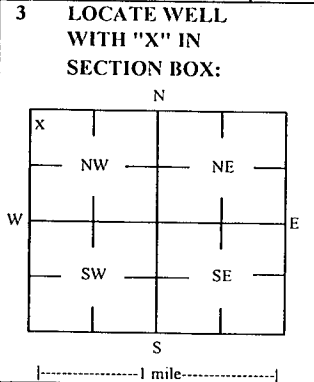

3 LOCATE WELL WITH 'X' IN SECTION BOX: 4 DEPTH OF COMPLETED WELL: 20 ft Depth(s) Groundwater Encountered: 1) 1 ft 2) ft 3) ft or 4) Dry Well WELL'S STATIC WATER LEVEL: 13.8 ft. X below land surface, measured on (mo-day-yr) 12/9-10/19

5 Latitude: 39.14219 (decimal degrees) Longitude: 94.69550 (decimal degrees) Horizontal Datum: WGS 84 X NAD 83 NAD 27 Source for Latitude/Longitude: GPS (unit make/model): Land Survey X Topographic Map Online Mapper

6 Elevation 961.58 ft Ground Level X TOC Source X Land Survey GPS Topographic Map Other

7 WELL WATER TO BE USED AS: 1 Domestic: Household Lawn & Garden Livestock Irrigation Feedlot Industrial 2 Public Water Supply: well ID 3 Dewatering: how many wells? 4 Aquifer Recharge: well ID 5 Monitoring: well ID MW19 6 Environmental Remediation: well ID 7 Air Sparge 8 Soil Vapor Extractor 9 Recovery 10 Injection 10 Oil Field Water Supply: lease 11 Test Hole: well ID Cased Uncased Geotechnical 12 Geothermal: How many bores? a) Closed Loop Horizontal Vertical b) Open Loop Surface Discharge Inj. of Water Other (specify):

Was a chemical/bacteriological sample submitted to KDHE? Yes No X No If yes, date sample was submitted: Water well disinfected? Yes No X No

8 TYPE OF CASING USED: Steel X PVC Other CASING JOINTS: Glued Clamped Welded X Threaded Casing diameter 2 in. to 10 ft, Diameter in. to ft, Diameter in. to ft, Casing height above land surface -0.28 in. Weight lbs./ft. Well thickness or gauge No TYPE OF SCREEN OR PERFORATION MATERIAL: Steel Stainless Steel Fiberglass X PVC Other (Specify) SCREEN OR PERFORATION OPENINGS ARE: Continuous Slot X Mill Slot Gauze Wrapped Torch Cut Drilled Holes Other (Specify) Louvered Shutter Key Punched Wire Wrapped Saw Cut None (Open Hole) SCREEN-PERFORATED INTERVALS: From 10 ft. to 20 ft. From ft. to ft. From ft. to ft. GRAVEL PACK INTERVALS: From 8 ft. to 20 ft. From ft. to ft. From ft. to ft.

9 GROUT MATERIAL: Neat cement Cement grout X Bentonite X Other Concrete: 0-0.5' Grout intervals: From 0.5 ft. to 8 ft. From ft. to ft. From ft. to ft.

Nearest source of possible contamination: Septic Tank Lateral Lines Pit Privy Livestock Pens Insecticide Storage Sewer Lines Cess Pool Sewage Lagoon X Fuel Storage Abandoned Water Well Watertight Sewer Lines Seepage Pit Feedyard Fertilizer Storage Oil Well / Gas Well Other (Specify):

Direction from well? Unknown Distance from well? Unknown ft

Table with columns: FROM, TO, LITHOLOGIC LOG, FROM, TO, LITH. LOG (cont.) or PLUGGING INTERVALS. Rows: 0 to 0.5 Grass/topsoil, 0.5 to 8.5 Rubble Fill, 8.5 to 20 Silty clay.

Notes: KDHE ID: Former Station; U4-105-15057 Target of monitoring well is shallow groundwater, <20' of grout was installed at the direction of KDHE.

11 CONTRACTOR'S OR LANDOWNER'S CERTIFICATION: This water well was X constructed, reconstructed or plugged under my jurisdiction and was completed on (mo-day-year) 12/6/19 and this record is true to the best of my knowledge and belief. Kansas Water Well Contractor's License No 757 This Water Well Record was completed on (mo-day-year) 12/27/19 under the business name of Larsen & Associates, Inc. Signature

Mail 1 white copy along with a fee of \$5.00 for each constructed well to: Kansas Department of Health and Environment, Bureau of Water, GWS Section, 1000 SW Jackson St., Suite 420, Topeka, Kansas 66612-1367. Mail one to Water Well Owner and retain one for your records. Telephone 785-296-5524.

DENNIS L HANDKE

1820 NW 59th Terrace
TOPEKA, KANSAS 66618
785-286-4047 Home
785-286-1990 Fax

Jess Chapman
Larsen & Assoc.
1311 E. 25th St., Suite B
Topeka, Kansas 66046

December 18, 2019

RE: Monitor Well Elevation Survey
5030 Leavenworth Road, Kansas City, Kansas

Proj. 19-0000
Former Station
KDHE ID U4-105-15057

Bench Mark: Chisled X on top SW bolt of fire hydrant at the SW corner of property.
Elev.: 963.32 South 3 West 5263 (from SE Corner Sec. 25-10-24E)

| | | | | | |
|-------|----------|--------|-------|------|------------------------------------------|
| MW-17 | rim | 948.49 | South | 269 | NE1/4,NE1/4,NE1/4,NE1/4 (Sec. 35-10-24E) |
| | top pipe | 950.97 | West | 5564 | Lat = 39.14232 Long = 94.69755 |
| MW-18 | rim | 963.54 | South | 315 | NW1/4,NW1/4,NW1/4,NW1/4 (Sec. 36-10-24E) |
| | top pipe | 963.27 | West | 5061 | Lat = 39.14218 Long = 94.69577 |
| MW-19 | rim | 961.86 | South | 312 | NW1/4,NW1/4,NW1/4,NW1/4 (Sec. 36-10-24E) |
| | top pipe | 961.58 | West | 4982 | Lat = 39.14219 Long = 94.69550 |
| MW-20 | rim | 965.33 | South | 155 | NW1/4,NW1/4,NW1/4,NW1/4 (Sec. 36-10-24E) |
| | top pipe | 965.03 | West | 5004 | Lat = 39.14265 Long = 94.69556 |

Lat & Long derived from Parkville 7.5' quad map. WGS84.

Elevation derived from existing Project

If you have any questions, please feel free to call me. Thank you for the opportunity to be of service to you.

December 18, 2019
Dennis L Handke RES
LS-703
Dennis L Handke

RECEIVED
JAN 09 2020
BUREAU OF WATER

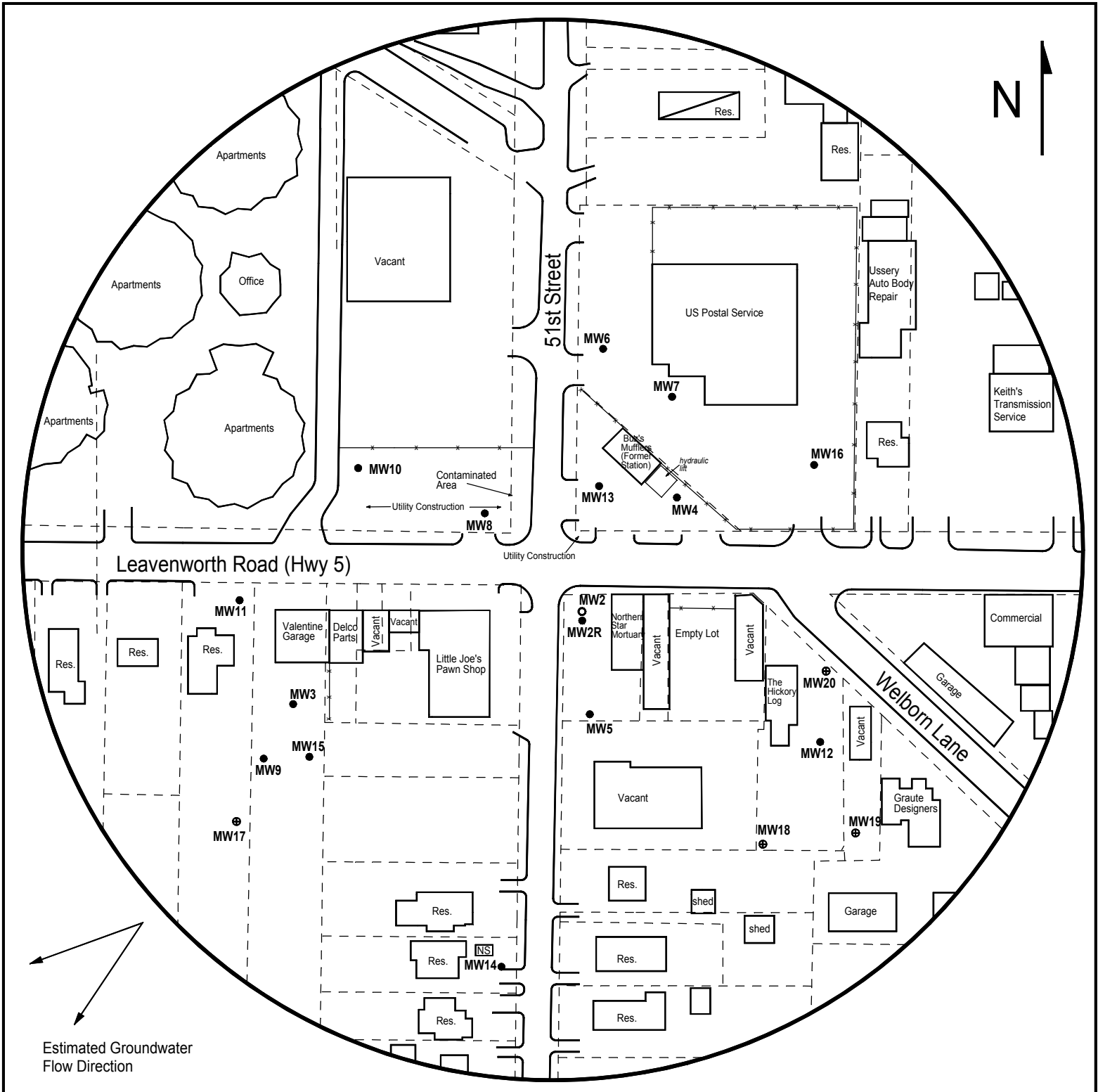

LEGEND:

- Building with Basement
- Approximate Location of Property Line
- Existing Monitoring Well
- Monitoring Well (Installed 12/6/19)
- Plugged Well

PROJECT:

Former Station
 5030 Leavenworth Rd.
 Kansas City, KS
 KDHE ID: U4-105-15057
 Date: 12/9-10/19



1311 E 25th St., Suite B (785) 841-8707 office
 Lawrence, KS 66046 (785) 865-4282 fax