

CORRECTION(S) TO WATER WELL RECORD (WWC-5)

(to rectify lacking or incorrect information)

County: Wyandotte

Location listed as:

Section-Township-Range: 2-115-25E

Fraction (1/4 1/4 1/4): NW NE SW

Location changed to:

34-105-25E

NE SE SE SE

Other changes: Initial statements: _____

Changed to: _____

Comments: _____

verification method: Map of well locations from owner, and
North Kansas City 1:24,000 topo. map.

initials: DRJ date: 9/14/2005

submitted by: Kansas Geological Survey, Data Resources Library, 1930 Constant Ave., Lawrence, KS 66047-3726
to: Kansas Dept of Health & Environment, Bureau of Water, 1000 SW Jackson, Suite 420, Topeka, KS 66612-1367.

MW 62

1	LOCATION OF WATER WELL:	Fraction	Section Number	Township Number	Range Number
County:	Myandotk	NW 1/4 NE 1/4 SW 1/4	2	11 S	25 EW

Distance and direction from nearest town or city street address of well if located within city?
2029 Fairfax KCKS 66115

2 WATER WELL OWNER: Ronoco Phillips Company
 RR #, St. Address, Box #: 1218 Phillips Bldg 420 S Kecker Ave
 City, State, ZIP Code: Bartlesville OK 74004
 Board of Agriculture, Division of Water Resources
 Application Number: _____

3 MARK WELL'S LOCATION WITH AN "X" IN SECTION BOX:

N		
X	NW	NE
W		E
	SW	SE
S		

4 DEPTH OF WELL 26.28 ft.
 WELL'S STATIC WATER LEVEL ft.
 WELL WAS USED AS:
 1 Domestic 5 Public Water Supply 9 Dewatering
 2 Irrigation 6 Oil Field Water Supply 10 Monitoring Well
 3 Feedlot 7 Domestic (Lawn & Garden) 11 Injection Well
 4 Industrial 8 Air Conditioning 12 Other

Was a chemical / bacteriological sample submitted to Department? Yes No
 If yes, mo/day/yr sample was submitted

Water Well Disinfected: Yes No

5 TYPE OF BLANK CASING USED:

1 Steel	3 RMP (SR)	5 Wrought	7 Fiberglass	9 Other (Specify below)
PVC	4 ABS	6 Asbestos-Cement	8 Concrete Tile	

Blank casing diameter 2 in. Was casing pulled? Yes No
 Casing height above or below land surface 29 in. If yes, how much 26.28

6 GROUT PLUG MATERIAL: 1 Neat cement 2 Cement grout 3 Bentonite 4 Other

Grout Plug Intervals: From 26.28 to 0 ft., From ft. to ft., From to ft.

What is the nearest source of possible contamination:

1 Septic tank	6 Seepage pit	10 Fuel storage	16 Other (specify below)
2 Sewer lines	7 Pit privy	12 Fertilizer storage	
3 Watertight sewer lines	8 Sewage lagoon	13 Insecticide storage	
4 Lateral lines	9 Feedyard	14 Abandoned water well	
5 Cess pool	10 Livestock pens	15 Oil well/Gas well	

Direction from well? How many feet?

FROM	TO	PLUGGING MATERIALS
26.28	0	Cement Grout

7 CONTRACTOR'S OR LANDOWNER'S CERTIFICATION: This water well was plugged under my jurisdiction and was completed on (mo/day/year) 11-30-01 and this record is true to the best of my knowledge and belief. Kansas Water Well Contractor's License No. 704 This Water Well Record was completed on (mo/day/year) 2-11-05 under the business name of MAXS
 by (signature) David Hough

INSTRUCTIONS: Use typewriter or ball point pen. Please press firmly and print clearly. Please fill in blanks, underline or circle the correct answers. Send top three copies to Kansas Department of Health and Environment, Bureau of Water, Geology Section, 1000 SW Jackson St., Ste. 420, Topeka, Kansas 66612-1367. Telephone: 785/296-5522. Send one to Water Well Owner and retain one for your records.

R25E

NE

NW

34

35

SE

SW

T10S

T11S

2

NW

MISSOURI RIVER

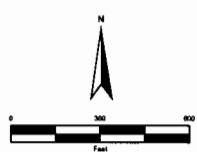
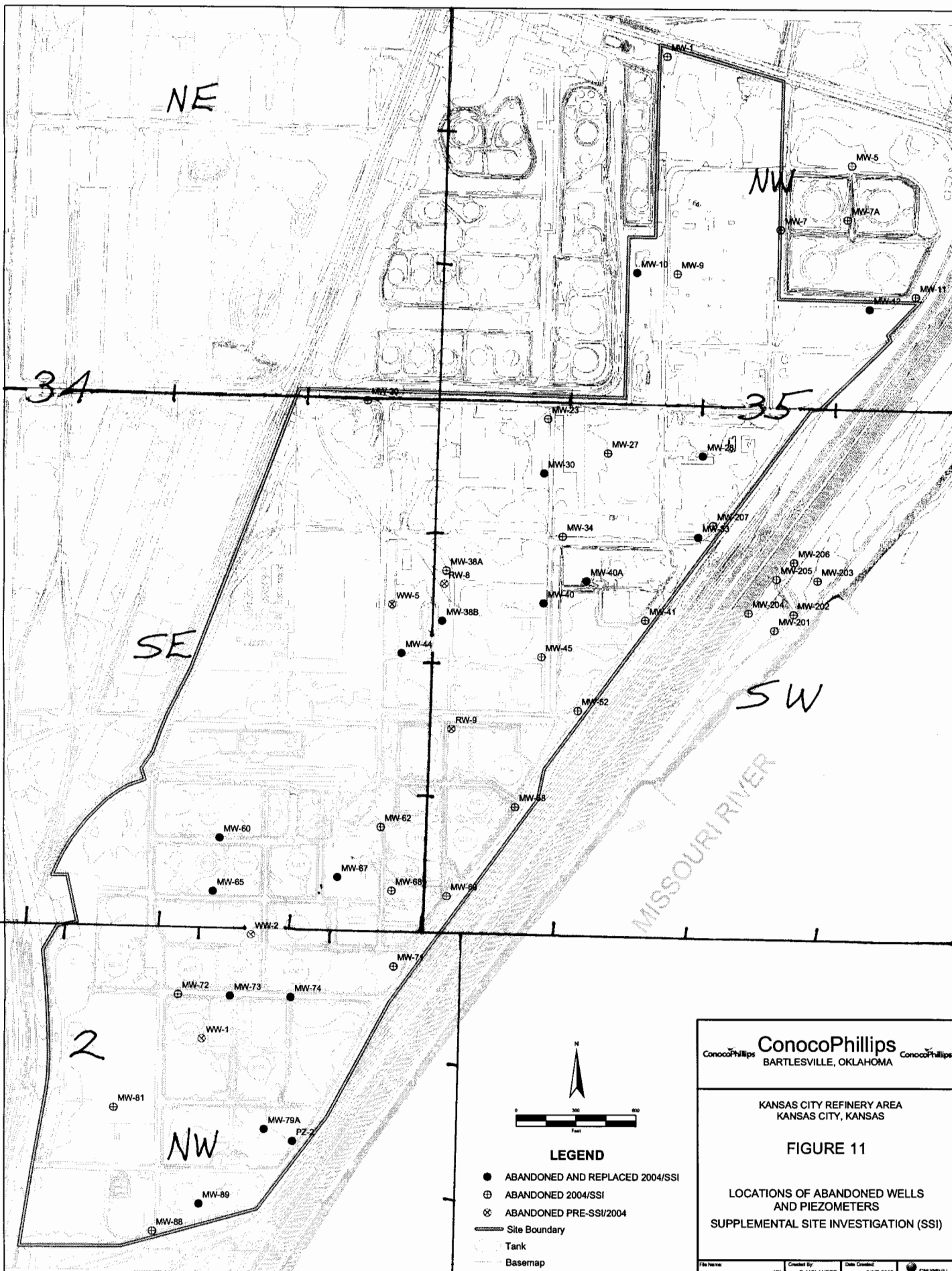

LEGEND

- ABANDONED AND REPLACED 2004/SSI
- ⊕ ABANDONED 2004/SSI
- ⊗ ABANDONED PRE-SSI/2004
- Site Boundary
- Tank
- Basemap

ConocoPhillips
 ConocoPhillips BARTLESVILLE, OKLAHOMA ConocoPhillips

KANSAS CITY REFINERY AREA
 KANSAS CITY, KANSAS

FIGURE 11

LOCATIONS OF ABANDONED WELLS
 AND PIEZOMETERS
 SUPPLEMENTAL SITE INVESTIGATION (SSI)