

CORRECTION(S) TO WATER WELL RECORD (WWC-5)

(to rectify lacking or incorrect information)

County: Wyandotte

Location listed as:

Location changed to:

Section-Township-Range: 22-50N-33W

35-105-25E

Fraction ($\frac{1}{4}$ $\frac{1}{4}$ $\frac{1}{4}$): NW NW NW

NE NW NW SW

Other changes: Initial statements: _____

Changed to: _____

Comments: _____

verification method: Map of well locations from owner, and
North Kansas City 1:24,000 topo. map.

initials: DR date: 9/9/2005

submitted by: Kansas Geological Survey, Data Resources Library, 1930 Constant Ave., Lawrence, KS 66047-3726
to: Kansas Dept of Health & Environment, Bureau of Water, 1000 SW Jackson, Suite 420, Topeka, KS 66612-1367.

MW 23

1	LOCATION OF WATER WELL:	Fraction	Section Number	Township Number	Range Number
County:	<i>Wyandotte</i>	<i>NW 1/4 NW 1/4 NW 1/4</i>	<i>22</i>	<i>50 N</i>	<i>33 EW</i>

Distance and direction from nearest town or city street address of well if located within city?
2029 Fairfax RCKS 66115

2 WATER WELL OWNER: *Conoco Phillips Company*
 RR #, St. Address, Box #: *1218 Phillips Bldg 426 S Reeler AVE*
 City, State, ZIP Code: *Bartlesville OK 74004*
 Board of Agriculture, Division of Water Resources
 Application Number: _____

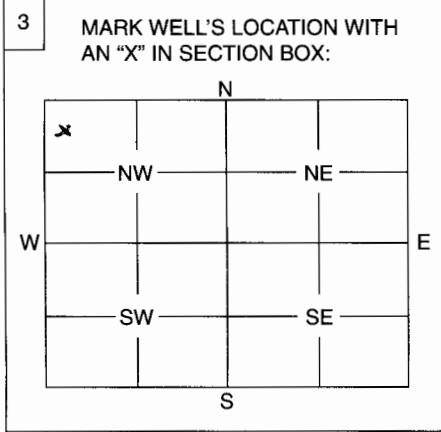

4 DEPTH OF WELL *25.97* ft.
 WELL'S STATIC WATER LEVEL ft.
 WELL WAS USED AS:

1 Domestic	5 Public Water Supply	9 Dewatering
2 Irrigation	6 Oil Field Water Supply	10 Monitoring Well
3 Feedlot	7 Domestic (Lawn & Garden)	11 Injection Well
4 Industrial	8 Air Conditioning	12 Other

Was a chemical / bacteriological sample submitted to Department? Yes No *>*
 If yes, mo/day/yr sample was submitted

Water Well Disinfected: Yes No *f*

5 TYPE OF BLANK CASING USED:

1 Steel	3 RMP (SR)	5 Wrought	7 Fiberglass	9 Other (Specify below)
2 PVC	4 ABS	6 Asbestos-Cement	8 Concrete Tile

Blank casing diameter *2* in. Was casing pulled? Yes *>* No If yes, how much *147* in.
 Casing height above or below land surface *29* in.

6 GROUT PLUG MATERIAL: 1 Neat cement 2 Cement grout 3 Bentonite 4 Other

Grout Plug Intervals: From *25.97* ft. to *0* ft., From ft. to ft., From to ft.

What is the nearest source of possible contamination:

1 Septic tank	6 Seepage pit	<u>11</u> Fuel storage	16 Other (specify below)
2 Sewer lines	7 Pit privy	12 Fertilizer storage
3 Watertight sewer lines	8 Sewage lagoon	13 Insecticide storage
4 Lateral lines	9 Feedyard	14 Abandoned water well
5 Cess pool	10 Livestock pens	15 Oil well/Gas well

Direction from well? How many feet?

FROM	TO	PLUGGING MATERIALS
<i>25.97</i>	<i>0</i>	<i>Cement Grout</i>

7 CONTRACTOR'S OR LANDOWNER'S CERTIFICATION: This water well was plugged under my jurisdiction and was completed on (mo/day/year) *11-11-04* and this record is true to the best of my knowledge and belief. Kansas Water Well Contractor's License No. *704* This Water Well Record was completed on (mo/day/year) *2-11-05* under the business name of *M.A.E.S.* by (signature) *David Hough*

INSTRUCTIONS: Use typewriter or ball point pen. Please press firmly and print clearly. Please fill in blanks, underline or circle the correct answers. Send top three copies to Kansas Department of Health and Environment, Bureau of Water, Geology Section, 1000 SW Jackson St., Ste. 420, Topeka, Kansas 66612-1367. Telephone: 785/296-5522. Send one to Water Well Owner and retain one for your records.

R25E

NE

NW

34

35

SE

SW

T10S

T11S

2

NW

MISSOURI RIVER

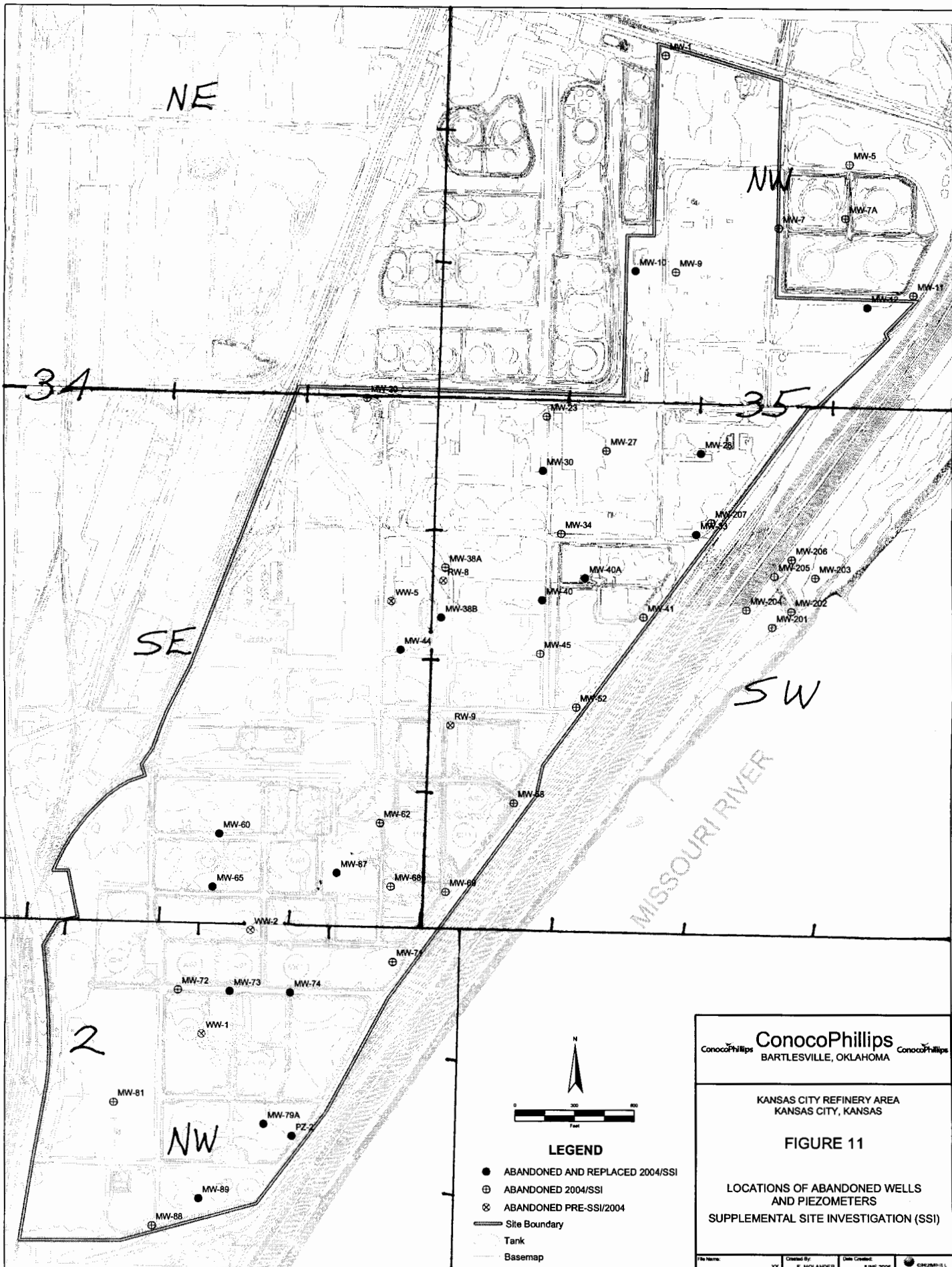

- LEGEND**
- ABANDONED AND REPLACED 2004/SSI
 - ⊕ ABANDONED 2004/SSI
 - ⊗ ABANDONED PRE-SSI/2004
 - Site Boundary
 - Tank
 - Basemap

ConocoPhillips
BARTLESVILLE, OKLAHOMA

KANSAS CITY REFINERY AREA
KANSAS CITY, KANSAS

FIGURE 11

LOCATIONS OF ABANDONED WELLS
AND PIEZOMETERS
SUPPLEMENTAL SITE INVESTIGATION (SSI)

File Name: Created By: Date Created: XX E. MOLANDER JUNE 2006