

WATER WELL PLUGGING RECORD

Form WWC-5P

KSA 82a-1212

ID NO.

53P

1 LOCATION OF WATER WELL: County: Wyandotte	Fraction NW 1/4 NW 1/4 NW 1/4 SE 1/4	Section Number 26	Township Number T 10 S	Range Number 25 <input checked="" type="checkbox"/> E <input type="checkbox"/> W
Street/Rural Address of Well Location; if unknown, distance & direction from nearest town or intersection: If at owner's address, check here <input checked="" type="checkbox"/>		Global Positioning Systems (GPS) information: Latitude: <u>39.14962</u> (in decimal degrees) Longitude: <u>-94.5933</u> (in decimal degrees) Elevation: <u>749.81</u> Datum: <input type="checkbox"/> WGS84, <input checked="" type="checkbox"/> NAD83, <input type="checkbox"/> NAD27 Collection Method: <input checked="" type="checkbox"/> GPS unit (Make/Model: <u>Trimble GeoXT 2008 Series</u>) <input type="checkbox"/> Digital Map/Photo, <input type="checkbox"/> Topographic Map, <input type="checkbox"/> Land Survey Est. Accuracy: <input checked="" type="checkbox"/> < 3 m, <input type="checkbox"/> 3-5 m, <input type="checkbox"/> 5-15 m, <input type="checkbox"/> > 15 m		

2 WATER WELL OWNER: Fairfax Drainage District RR#, St. Address, Box #: 1620 Fairfax Trafficway City, State ZIP Code: Kansas City, KS 66115	
---	--

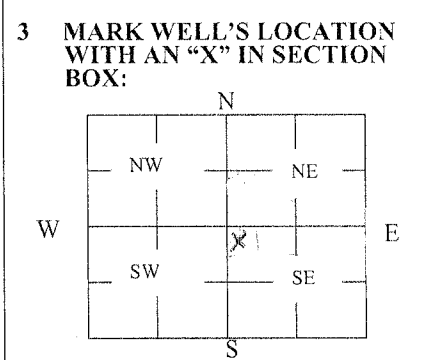

4 DEPTH OF WELL 104.14 ft.
WELL'S STATIC WATER LEVEL 31.1 ft.
WELL WAS USED AS:

<input type="checkbox"/> Domestic	<input type="checkbox"/> Public Water Supply	<input type="checkbox"/> Dewatering
<input type="checkbox"/> Irrigation	<input type="checkbox"/> Oil Field Water Supply	<input type="checkbox"/> Monitoring
<input type="checkbox"/> Feedlot	<input type="checkbox"/> Domestic (Lawn & Garden)	<input type="checkbox"/> Injection Well
<input type="checkbox"/> Industrial	<input type="checkbox"/> Air Conditioning	<input checked="" type="checkbox"/> Other <u>Relief Well</u>

Was a chemical/bacteriological sample submitted to Department? Yes No

5 TYPE OF BLANK CASING USED:

<input checked="" type="checkbox"/> Steel	<input type="checkbox"/> RMP (SR)	<input type="checkbox"/> Wrought	<input type="checkbox"/> Fiberglass	<input type="checkbox"/> Other (Specify below)
<input type="checkbox"/> PVC	<input type="checkbox"/> ABS	<input type="checkbox"/> Asbestos-Cement	<input type="checkbox"/> Concrete Tile	

Blank casing diameter _____ in. Was casing pulled? Yes No If yes, how much _____
 Casing height above or below land surface (21.73) in. ft.

6 GROUT PLUG MATERIAL: Neat cement Cement grout Bentonite Other _____

Grout Plug Intervals: From 21.73 ft. to 43.73 ft., From _____ ft. to _____ ft., From _____ to _____ ft.

What is the nearest source of possible contamination:

<input type="checkbox"/> Septic tank	<input type="checkbox"/> Seepage pit	<input type="checkbox"/> Fuel Storage	<input checked="" type="checkbox"/> Other (specify below)
<input type="checkbox"/> Sewer lines	<input type="checkbox"/> Pit privy	<input type="checkbox"/> Fertilizer storage	<u>Underground Hydrocarbons from Old Refinery</u>
<input type="checkbox"/> Watertight sewer lines	<input type="checkbox"/> Sewage lagoon	<input type="checkbox"/> Insecticide storage	
<input type="checkbox"/> Lateral lines	<input type="checkbox"/> Feedyard	<input type="checkbox"/> Abandoned water well	Direction from well? <u>Southwest</u>
<input type="checkbox"/> Cess pool	<input type="checkbox"/> Livestock pens	<input type="checkbox"/> Oil well/Gas well	How many feet? <u>7400</u>

FROM	TO	PLUGGING MATERIALS	FROM	TO	PLUGGING MATERIALS
21.73	43.73	Cement Grout			
43.73	104.14	Chlorinated Silica Sand			

7 CONTRACTOR'S OR LANDOWNER'S CERTIFICATION: This water well was plugged under my jurisdiction and was completed on (mo/day/year) 02/07/2011 and this record is true to the best of my knowledge and belief. Kansas Water Well Contractor's License No. _____. This Water Well Record was completed on (mo/day/year) 04/16/2012 under the business name of Fairfax Drainage District by (signature) Stephen P. Dancy P.E.

INSTRUCTIONS: Use typewriter or ballpoint pen. Please press firmly and print clearly. Please fill in blanks, underline or circle the correct answers. Send top three copies to Kansas Department of Health and Environment, Bureau of Water, Geology Section, 1000 SW Jackson St., Ste. 420, Topeka, Kansas 66612-1367. Telephone: 785/296-5524. Send one to Water Well Owner and retain one for your records. Visit us at <http://www.kdheks.gov/waterwell/index.html>.

Check one: White Copy Blue Copy Pink Copy