

WATER WELL PLUGGING RECORD Form WWC-5P KSA 82a-1212 ID NO. 29P

| | | | | |
|---|--|-----------------------------|----------------------------------|--|
| 1 LOCATION OF WATER WELL: County: Wyandotte | Fraction <u>NE 1/4 NW 1/4 NE 1/4 SW 1/4</u> | Section Number <u>35</u> | Township Number T <u>10</u> S | Range Number <u>25</u> <input checked="" type="checkbox"/> E <input type="checkbox"/> W |
|---|--|-----------------------------|----------------------------------|--|

Street/Rural Address of Well Location; if unknown, distance & direction from nearest town or intersection: If at owner's address, check here

Global Positioning Systems (GPS) information:
 Latitude: 39.13508 (in decimal degrees)
 Longitude: -94.5968 (in decimal degrees)
 Elevation: 743.94
 Datum: WGS84, NAD83, NAD27
 Collection Method:
 GPS unit (Make/Model: Trimble GeoXT 2008 Series)
 Digital Map/Photo, Topographic Map, Land Survey
 Est. Accuracy: < 3 m, 3-5 m, 5-15 m, > 15 m

2 WATER WELL OWNER: Fairfax Drainage District
 RR#, St. Address, Box #: 1620 Fairfax Trafficway
 City, State ZIP Code: Kansas City, KS 66115

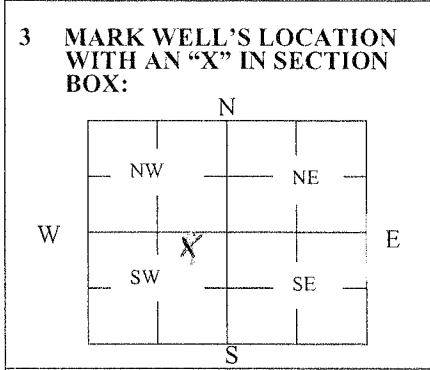

4 DEPTH OF WELL 80.28 ft.
 WELL'S STATIC WATER LEVEL 18.7 ft.
 WELL WAS USED AS:
 Domestic Public Water Supply Dewatering
 Irrigation Oil Field Water Supply Monitoring
 Feedlot Domestic (Lawn & Garden) Injection Well
 Industrial Air Conditioning Other Relief Well
 Was a chemical/bacteriological sample submitted to Department? Yes No

5 TYPE OF BLANK CASING USED:

Steel RMP (SR) Wrought Fiberglass Other (Specify below)
 PVC ABS Asbestos-Cement Concrete Tile

Blank casing diameter _____ in. Was casing pulled? Yes No If yes, how much _____
 Casing height above or below land surface (11.28) in. ft.

6 GROUT PLUG MATERIAL: Neat cement Cement grout Bentonite Other _____

Grout Plug Intervals: From 11.28 ft. to 29.28 ft., From _____ ft. to _____ ft., From _____ to _____ ft.

What is the nearest source of possible contamination:
 Septic tank Seepage pit Fuel Storage Other (specify below)
 Sewer lines Pit privy Fertilizer storage Underground Hydrocarbons from Old Refinery
 Watertight sewer lines Sewage lagoon Insecticide storage
 Lateral lines Feedyard Abandoned water well
 Cess pool Livestock pens Oil well/Gas well
 Direction from well? Southwest
 How many feet? 2300

| FROM | TO | PLUGGING MATERIALS | FROM | TO | PLUGGING MATERIALS |
|--------------|--------------|-------------------------|------|----|--------------------|
| <u>11.28</u> | <u>29.28</u> | Cement Grout | | | |
| <u>29.28</u> | <u>80.28</u> | Chlorinated Silica Sand | | | |
| | | | | | |
| | | | | | |
| | | | | | |

7 CONTRACTOR'S OR LANDOWNER'S CERTIFICATION: This water well was plugged under my jurisdiction and was completed on (mo/day/year) 2/24/2011 and this record is true to the best of my knowledge and belief. Kansas Water Well Contractor's License No. _____. This Water Well Record was completed on (mo/day/year) 04/16/2012 under the business name of Fairfax Drainage District by (signature) Stephen P. Dandy P.E.

INSTRUCTIONS: Use typewriter or ballpoint pen. Please press firmly and print clearly. Please fill in blanks, underline or circle the correct answers. Send top three copies to Kansas Department of Health and Environment, Bureau of Water, Geology Section, 1000 SW Jackson St., Ste. 420, Topeka, Kansas 66612-1367. Telephone: 785/296-5524. Send one to Water Well Owner and retain one for your records. Visit us at <http://www.kdheks.gov/waterwell/index.html>.