

**WATER WELL PLUGGING RECORD Form WWC-5P** KSA 82a-1212 ID NO. 22P

<b>1 LOCATION OF WATER WELL:</b> County: Wyandotte	Fraction <u>NW 1/4 SW 1/4 NE 1/4 SW 1/4</u>	Section Number <u>35</u>	Township Number T <u>10</u> S	Range Number <u>25</u> <input checked="" type="checkbox"/> E <input type="checkbox"/> W
---	--	-----------------------------	----------------------------------	--

Street/Rural Address of Well Location; if unknown, distance & direction from nearest town or intersection: If at owner's address, check here

**Global Positioning Systems (GPS) information:**  
 Latitude: 39.13309 (in decimal degrees)  
 Longitude: -94.5987 (in decimal degrees)  
 Elevation: 744.34  
 Datum:  WGS84,  NAD83,  NAD27  
**Collection Method:**  
 GPS unit (Make/Model: Trimble GeoXT 2008 Series)  
 Digital Map/Photo,  Topographic Map,  Land Survey  
 Est. Accuracy:  < 3 m,  3-5 m,  5-15 m,  > 15 m

**2 WATER WELL OWNER:** Fairfax Drainage District  
 RR#, St. Address, Box #: 1620 Fairfax Trafficway  
 City, State ZIP Code: Kansas City, KS 66115

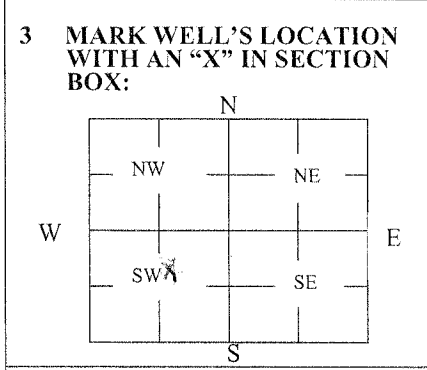

**4 DEPTH OF WELL** 86.06 ft.  
 WELL'S STATIC WATER LEVEL 26.3 ft.  
 WELL WAS USED AS:  
 Domestic  Public Water Supply  Dewatering  
 Irrigation  Oil Field Water Supply  Monitoring  
 Feedlot  Domestic (Lawn & Garden)  Injection Well  
 Industrial  Air Conditioning  Other Relief Well  
 Was a chemical/bacteriological sample submitted to Department? Yes  No

**5 TYPE OF BLANK CASING USED:**

Steel  RMP (SR)  Wrought  Fiberglass  Other (Specify below)  
 PVC  ABS  Asbestos-Cement  Concrete Tile

Blank casing diameter \_\_\_\_\_ in. Was casing pulled? Yes  No  If yes, how much \_\_\_\_\_  
 Casing height above or below land surface (7.59) in. ft.

**6 GROUT PLUG MATERIAL:**  Neat cement  Cement grout  Bentonite  Other \_\_\_\_\_

Grout Plug Intervals: From 7.59 ft. to 28.09 ft., From \_\_\_\_\_ ft. to \_\_\_\_\_ ft., From \_\_\_\_\_ to \_\_\_\_\_ ft.

What is the nearest source of possible contamination:

<input type="checkbox"/> Septic tank	<input type="checkbox"/> Seepage pit	<input type="checkbox"/> Fuel Storage	<input checked="" type="checkbox"/> Other (specify below) <u>Underground Hydrocarbons from Old Refinery</u>
<input type="checkbox"/> Sewer lines	<input type="checkbox"/> Pit privy	<input type="checkbox"/> Fertilizer storage	
<input type="checkbox"/> Watertight sewer lines	<input type="checkbox"/> Sewage lagoon	<input type="checkbox"/> Insecticide storage	
<input type="checkbox"/> Lateral lines	<input type="checkbox"/> Feedyard	<input type="checkbox"/> Abandoned water well	
<input type="checkbox"/> Cess pool	<input type="checkbox"/> Livestock pens	<input type="checkbox"/> Oil well/Gas well	

Direction from well? Southwest  
 How many feet? 1400

FROM	TO	PLUGGING MATERIALS	FROM	TO	PLUGGING MATERIALS
<u>7.59</u>	<u>28.09</u>	Cement Grout			
<u>28.09</u>	<u>86.06</u>	Chlorinated Silica Sand			

**7 CONTRACTOR'S OR LANDOWNER'S CERTIFICATION:** This water well was plugged under my jurisdiction and was completed on (mo/day/year) 1/06/2011 and this record is true to the best of my knowledge and belief. Kansas Water Well Contractor's License No. \_\_\_\_\_. This Water Well Record was completed on (mo/day/year) 04/16/2012 under the business name of Fairfax Drainage District by (signature) Stephen P. Dierly P.E.

**INSTRUCTIONS:** Use typewriter or ballpoint pen. Please press firmly and print clearly. Please fill in blanks, underline or circle the correct answers. Send top three copies to Kansas Department of Health and Environment, Bureau of Water, Geology Section, 1000 SW Jackson St., Ste. 420, Topeka, Kansas 66612-1367. Telephone: 785/296-5524. Send one to Water Well Owner and retain one for your records. Visit us at <http://www.kdheks.gov/waterwell/index.html>.