

County: Wyandotte Fraction NE NW SW SE Sec. 34 T 10 S R 25 (E/W)

CORRECTION(S) TO WATER WELL COMPLETION RECORD (WWC-5)
(to rectify lacking or incorrect information)

Owner: Phillips 66

Location was listed as:

Section-Township-Range: 2-115-26E

Fraction (1/4 1/4 1/4): SW NW NE

Location changed to:

34-105-25E

NE NW SW SE

Other changes: Initial statements: _____

Changed to: _____

Comments: _____

Verification method: Latitude & longitude, KGS' "LEO" conversion tool,
well site address, other monitoring wells for same company in same area,
and mapping tool & aerial photos on KGS website. initials: DRJ date: 10/29/2013

Submitted by: Kansas Geological Survey, Data Resources Library, 1930 Constant Ave., Lawrence, KS 66047-3726
to: Kansas Dept of Health & Environment, Bureau of Water, 1000 SW Jackson, Suite 420, Topeka, KS 66612-1367.

MW-1

WATER WELL PLUGGING RECORD Form WWC-5P KSA 82a-1212 ID NO.

1 LOCATION OF WATER WELL: Fraction 1/4 SW 1/4 NW 1/4 NE 1/4 Section Number 2 Township Number T 11 S Range Number 26 [X] E [] W

Street/Rural Address of Well Location; if unknown, distance & direction from nearest town or intersection: If at owner's address, check here [] 2851 Fairfax Trafficway, Kansas City, KS Global Positioning Systems (GPS) information: Latitude: 39.1319 (in decimal degrees) Longitude: 94.6109 (in decimal degrees) Elevation: Datum: [X] WGS84, [] NAD83, [] NAD27 Collection Method: [X] GPS unit (Make/Model: Garmin etrex 10) [] Digital Map/Photo, [] Topographic Map, [] Land Survey Est. Accuracy: [] < 3 m, [X] 3-5 m, [] 5-15 m, [] > 15 m

2 WATER WELL OWNER: Phillips 66 RR#, St. Address, Box #: 1604-02 Phillips Building City, State ZIP Code: Bartlesville, OK 74003

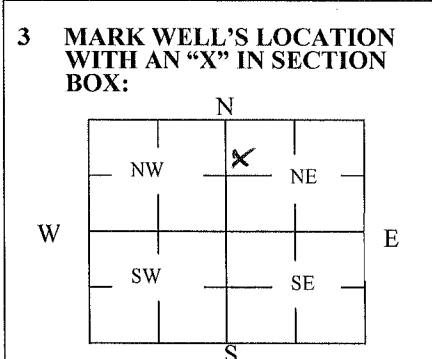

4 DEPTH OF WELL 28.2 ft. WELL'S STATIC WATER LEVEL _____ ft. WELL WAS USED AS: [] Domestic [] Irrigation [] Feedlot [] Industrial [] Public Water Supply [] Oil Field Water Supply [] Domestic (Lawn & Garden) [] Air Conditioning [] Dewatering [X] Monitoring [] Injection Well [] Other _____ Was a chemical/bacteriological sample submitted to Department? Yes [] No [X]

5 TYPE OF BLANK CASING USED: [X] Steel [] RMP (SR) [] Wrought [] Fiberglass [] Other (Specify below) [] PVC [] ABS [] Asbestos-Cement [] Concrete Tile Blank casing diameter 2 in. Was casing pulled? Yes [] No [X] If yes, how much _____ Casing height above or below land surface -4.0 in.

6 GROUT PLUG MATERIAL: [] Neat cement [X] Cement grout [] Bentonite [] Other _____ Grout Plug Intervals: From 2 ft. to 28.2 ft., From _____ ft. to _____ ft., From _____ to _____ ft. What is the nearest source of possible contamination: [] Septic tank [] Sewer lines [] Watertight sewer lines [] Lateral lines [] Cess pool [] Seepage pit [] Pit privy [] Sewage lagoon [] Feedyard [] Livestock pens [] Fuel Storage [] Fertilizer storage [] Insecticide storage [] Abandoned water well [] Oil well/Gas well [] Other (specify below) _____ Direction from well? _____ How many feet? _____

Table with 6 columns: FROM, TO, PLUGGING MATERIALS, FROM, TO, PLUGGING MATERIALS. Row 1: 0, 2', Concrete. Row 2: 2', 28.2', Cement/Bentonite Grout.

7 CONTRACTOR'S OR LANDOWNER'S CERTIFICATION: This water well was plugged under my jurisdiction and was completed on (mo/day/year) 9/11/2013 and this record is true to the best of my knowledge and belief. Kansas Water Well Contractor's License No. 710. This Water Well Record was completed on (mo/day/year) 9/30/2013 under the business name of Below Ground Surface, Inc. by (signature) [Signature]

INSTRUCTIONS: Use typewriter or ballpoint pen. Please press firmly and print clearly. Please fill in blanks, underline or circle the correct answers. Send top three copies to Kansas Department of Health and Environment, Bureau of Water, Geology Section, 1000 SW Jackson St., Ste. 420, Topeka, Kansas 66612-1367. Telephone: 785/296-5524. Send one to Water Well Owner and retain one for your records. Visit us at http://www.kdheks.gov/waterwell/index.html.

Check one: [] White Copy [] Blue Copy [] Pink Copy