

MMW-2

WATER WELL RECORD

Form WWC-5

Division of Water Resources App. No.

1 LOCATION OF WATER WELL: County: Wyandotte Fraction 1/4 1/4 1/4 SW 1/4 Section Number 28 Township No. T 10 S Range Number R 25 [X]E []W

Street/Rural Address of Well Location; if unknown, distance & direction from nearest town or intersection: If at owner's address, check here []. 1090 Sunshine Rd., Kansas City, KS Global Positioning System (GPS) information: Latitude: 39.1497 Longitude: 94.6330

2 WATER WELL OWNER: Magellan Pipeline Company, L.P. RR#, Street Address, Box #: One Williams Center, MD 27-6 City, State, ZIP Code : Tulsa, OK 74172 Collection Method: [X] GPS unit (Make/Model: Garmin etrex)

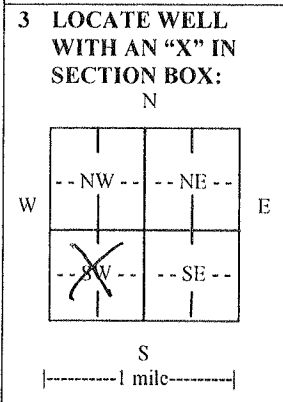

3 LOCATE WELL WITH AN 'X' IN SECTION BOX: 4 DEPTH OF COMPLETED WELL 30 ft. Depth(s) Groundwater Encountered (1) 17 ft. (2) 17 ft. (3) 17 ft. WELL'S STATIC WATER LEVEL 26.47 ft. below land surface measured on mo/day/yr 3-17-14

5 TYPE OF CASING USED: [] Steel [X] PVC [] Other CASING JOINTS: [] Glued [] Clamped [] Welded [X] Threaded Casing diameter 2 in. to 10 ft., Diameter 7 in. to 7 ft., Diameter 7 in. to 7 ft. Casing height above land surface 30 in., Weight lbs./ft., Wall thickness or gauge No. Sch. 40

6 GROUT MATERIAL: [] Neat cement [X] Cement grout [X] Bentonite [] Other Grout Intervals: From 8 ft. to 5 ft., From 5 ft. to 2 ft., From ft. to ft. What is the nearest source of possible contamination: [] Septic tank [] Lateral lines [] Pit privy [] Livestock pens [] Insecticide storage [] Other (specify below)

Table with 6 columns: FROM, TO, LITHOLOGIC LOG, FROM, TO, LITHO. LOG (cont.) or PLUGGING INTERVALS. Row 1: 0, 9, Silt Clay, , , . Row 2: 9, 30, Sand, Very Fine grading to Medium, , ,

7 CONTRACTOR'S OR LANDOWNER'S CERTIFICATION: This water well was [X] constructed, [] reconstructed, or [] plugged under my jurisdiction and was completed on (mo/day/year) 3/10/2014 and this record is true to the best of my knowledge and belief. Kansas Water Well Contractor's License No. 710 This Water Well Record was completed on (mo/day/year) 3/18/2014 under the business name of Below Ground Surface, Inc. by (signature)

INSTRUCTIONS: Use typewriter or ball point pen. PLEASE PRESS FIRMLY and PRINT clearly. Please fill in blanks and check the correct answers. Send three copies (white, blue, pink) to Kansas Department of Health and Environment, Bureau of Water, Geology Section, 1000 SW Jackson St., Suite 420, Topeka, Kansas 66612-1367. Telephone 785-296-5524. Send one copy to WATER WELL OWNER and retain one for your records. I include fee of \$5.00 for each constructed well. Visit us at http://www.kdheks.gov/waterwell/index.html.