

1 LOCATION OF WATER WELL: Fraction $\frac{1}{4}$ $\frac{1}{4}$ SE $\frac{1}{4}$ SE $\frac{1}{4}$ Section Number 27 Township Number T 10 S Range Number 25 E W
 County: Wyandotte

Street/Rural Address of Well Location; if unknown, distance & direction from nearest town or intersection: If at owner's address, check here wells located on GM-Fairfax Plant at Fairfax Trafficway and Kindleberger Road Kansas City, KS

Global Positioning Systems (GPS) information:
 Latitude: 38. 142168 (in decimal degrees)
 Longitude: -94. 598875 (in decimal degrees)
 Elevation: _____
 Horizontal Datum: WGS84, NAD83, NAD27
 Collection Method: _____

2 WATER WELL OWNER: Magellan Midstream Partners
 RR#, St. Address, Box #: 401 E. Donovan Road
 City, State ZIP Code: Kansas City, KS 66215

GPS unit (Make/Model: Garmin etrek)
 Digital Map/Photo, Topographic Map, Land Survey
 Est. Accuracy: < 3 m, 3-5 m, 5-15 m, > 15 m

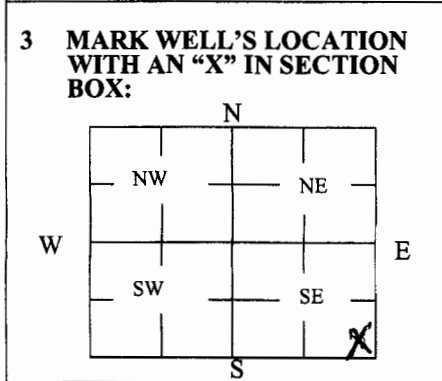

4 DEPTH OF WELL 87 ft.
 WELL'S STATIC WATER LEVEL _____ ft.
 WELL WAS USED AS:

Domestic Public Water Supply Dewatering
 Irrigation Oil Field Water Supply Monitoring MW-4B
 Feedlot Domestic (Lawn & Garden) Injection Well
 Industrial Air Conditioning Other _____

Was a chemical/bacteriological sample submitted to Department? Yes No

5 TYPE OF BLANK CASING USED:

Steel RMP (SR) Wrought Fiberglass Other (Specify below)
 PVC ABS Asbestos-Cement Concrete Tile

Blank casing diameter 2 in. Was casing pulled? Yes No If yes, how much 5 feet
 Casing height above or below land surface 30 in.

6 GROUT PLUG MATERIAL: Neat cement Cement grout Bentonite Other Top Soil

Grout Plug Intervals: From 0 ft. to 3 ft., From 3 ft. to 87 ft., From _____ ft. to _____ ft.

What is the nearest source of possible contamination:

Septic tank Seepage pit Fuel storage Other (specify below)
 Sewer lines Pit privy Fertilizer storage
 Watertight sewer lines Sewage lagoon Insecticide storage
 Lateral lines Feedyard Abandoned water well Direction from well? Southeast
 Cess pool Livestock pens Oil well/Gas well How many feet? 1800

FROM	TO	PLUGGING MATERIALS	FROM	TO	PLUGGING MATERIALS
0	3	Top Soil			
3	87	Bentonite/Portland Grout			

7 CONTRACTOR'S OR LANDOWNER'S CERTIFICATION: This water well was plugged under my jurisdiction and was completed on (mo/day/year) 12/28/2016 and this record is true to the best of my knowledge and belief. Kansas Water Well Contractor's License No. 710. This Water Well Record was completed on (mo/day/year) 12/29/2016 under the business name of Below Ground Surface, Inc. by (signature) [Signature]

Send one white copy to Kansas Department of Health & Environment, Geology Section, 1000 SW Jackson Street, Ste. 420, Topeka, KS 66612-1367. Send one copy to WATER WELL OWNER and retain one for your records.
 Visit us at <http://www.kdheks.gov/waterwell/index.html> Telephone 785-296-5524.

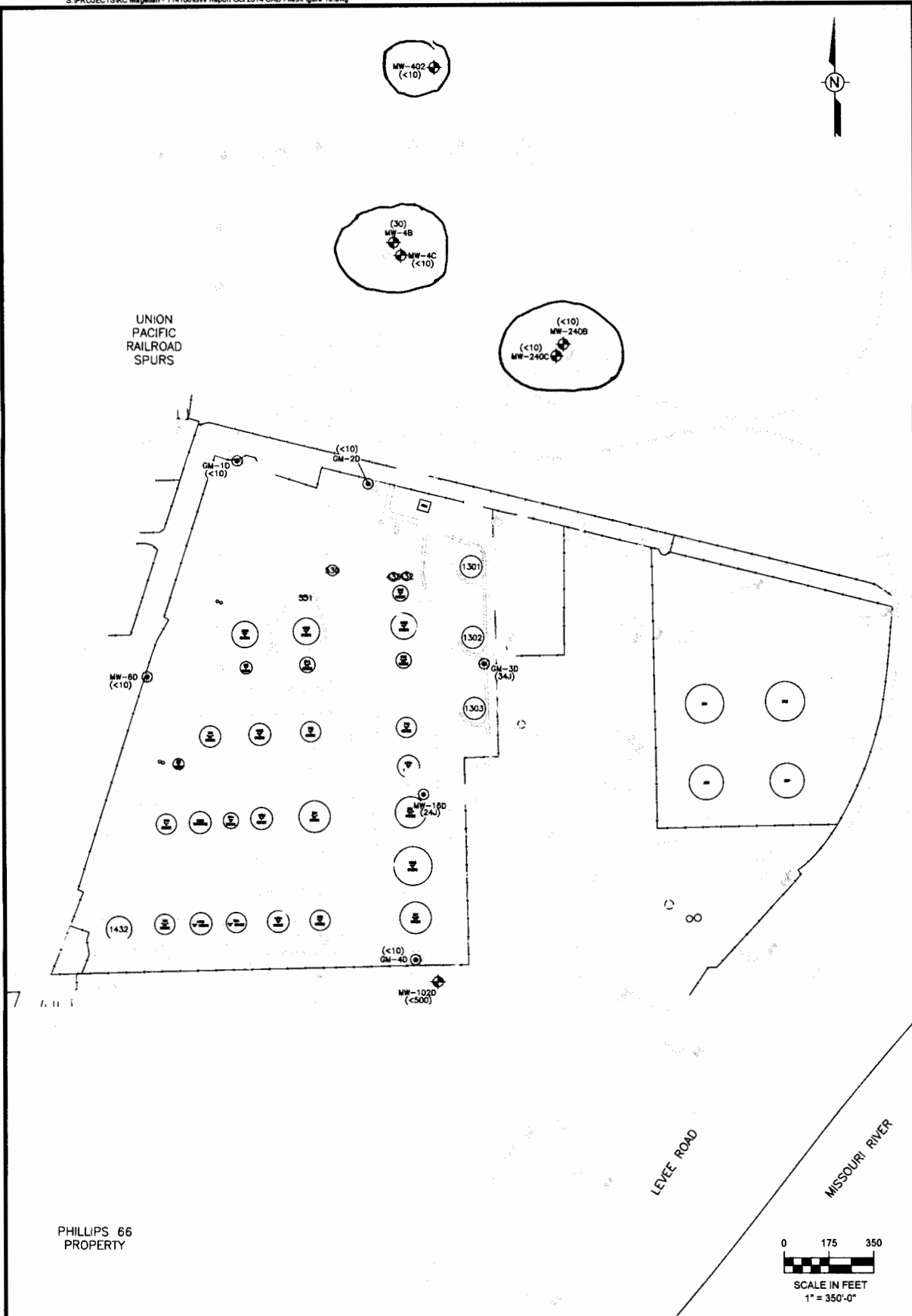

PHILLIPS 66
PROPERTY

LEGEND:	
	PERMANENT MONITORING WELL
	DIRECT PUSH
	ON-SITE WELL
	TEMPORARY PIEZOMETER
	TPH-GRO ISOCONCENTRATION CONTOUR
(<500)	TPH-GRO CONCENTRATION (IN ug/L)
(ns)	NOT SAMPLED
(e)	ESTIMATED CONCENTRATION

TPH-GRO CONCENTRATIONS - DEEP ZONE
OCTOBER 2014
MAGELLAN MAINSTREAM PARTNERS L.P.
KANSAS CITY TERMINAL
KANSAS CITY, KANSAS

DRAWN BY: MM/SPA	DATE: 1/28/2015
PROJECT NO: 114106	DWG FILE: Figure 10

415 SOUTH 18TH STREET, SUITE 105
ST. LOUIS, MO 63103
P: 314.241.2684
F: 314.241.2743

FIGURE
10



8110 Cole Pkwy. Shawnee, KS 66227

Office: 913-441-1088
Fax: 913-441-1086
e-mail: midwestbgs@sbcglobal.net
www.belowgroundsurface.com

January 8, 2017

Kansas Department of Health and Environment
Bureau of Water-Geology Section
1000 S.W. Jackson Street, Suite 420
Topeka, KS 66612-1367

Re: WWC-5P Forms for a Site in Kansas City, KS

Dear KDHE:

Enclosed are your copies of the KDHE WWC-5P Water Well Plugging Records for wells that were recently abandoned in Kansas City, KS. Please let us know if you have any questions or concerns.

If you have any questions, please call me at (913) 441-1088. Thank you.

Sincerely,
Below Ground Surface, Inc.

Mike Ocsody, PG

Enclosure

RECEIVED
JAN 17 2017
BUREAU OF WATER