

**1 LOCATION OF WATER WELL:** Fraction  $\frac{1}{4}$   $\frac{1}{4}$  SE  $\frac{1}{4}$  SE  $\frac{1}{4}$  Section Number 27 Township Number T 10 S Range Number 25  E  W

County: Wyandotte

Street/Rural Address of Well Location; if unknown, distance & direction from nearest town or intersection: If at owner's address, check here  wells located on GM-Fairfax Plant at Fairfax Trafficway and Kindleberger Road Kansas City, KS

**Global Positioning Systems (GPS) information:**  
 Latitude: 38.142153 (in decimal degrees)  
 Longitude: -94.598792 (in decimal degrees)  
 Elevation: \_\_\_\_\_  
 Horizontal Datum:  WGS84,  NAD83,  NAD27  
 Collection Method: \_\_\_\_\_

**2 WATER WELL OWNER:** Magellan Midstream Partners  
 RR#, St. Address, Box #: 401 E. Donovan Road  
 City, State ZIP Code: Kansas City, KS 66215

GPS unit (Make/Model: Garmin etrek)  
 Digital Map/Photo,  Topographic Map,  Land Survey

Est. Accuracy:  < 3 m,  3-5 m,  5-15 m,  > 15 m

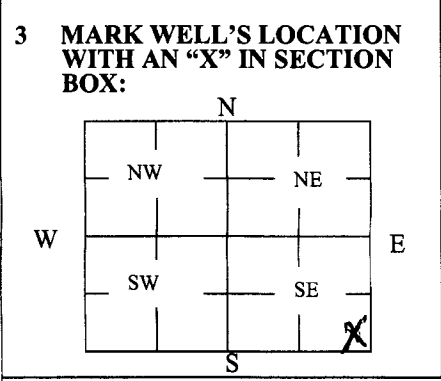

**4 DEPTH OF WELL** 118 ft.  
 WELL'S STATIC WATER LEVEL \_\_\_\_\_ ft.  
 WELL WAS USED AS:

<input type="checkbox"/> Domestic	<input type="checkbox"/> Public Water Supply	<input checked="" type="checkbox"/> Dewatering
<input type="checkbox"/> Irrigation	<input type="checkbox"/> Oil Field Water Supply	<input type="checkbox"/> Monitoring <u>MW-4C</u>
<input type="checkbox"/> Feedlot	<input type="checkbox"/> Domestic (Lawn & Garden)	<input type="checkbox"/> Injection Well
<input type="checkbox"/> Industrial	<input type="checkbox"/> Air Conditioning	<input type="checkbox"/> Other _____

Was a chemical/bacteriological sample submitted to Department? Yes  No

**5 TYPE OF BLANK CASING USED:**

<input checked="" type="checkbox"/> Steel	<input type="checkbox"/> RMP (SR)	<input type="checkbox"/> Wrought	<input type="checkbox"/> Fiberglass	<input type="checkbox"/> Other (Specify below) _____
<input checked="" type="checkbox"/> PVC	<input type="checkbox"/> ABS	<input type="checkbox"/> Asbestos-Cement	<input type="checkbox"/> Concrete Tile	

Blank casing diameter 2 in. Was casing pulled? Yes  No  If yes, how much 10 feet  
 Casing height above or below land surface 30 in.

**6 GROUT PLUG MATERIAL:**  Neat cement  Cement grout  Bentonite  Other Top Soil

Grout Plug Intervals: From 0 ft. to 3 ft., From 3 ft. to 118 ft., From \_\_\_\_\_ ft. to \_\_\_\_\_ ft.

What is the nearest source of possible contamination:

<input type="checkbox"/> Septic tank	<input type="checkbox"/> Seepage pit	<input checked="" type="checkbox"/> Fuel storage	<input type="checkbox"/> Other (specify below) _____
<input type="checkbox"/> Sewer lines	<input type="checkbox"/> Pit privy	<input type="checkbox"/> Fertilizer storage	
<input type="checkbox"/> Watertight sewer lines	<input type="checkbox"/> Sewage lagoon	<input type="checkbox"/> Insecticide storage	
<input type="checkbox"/> Lateral lines	<input type="checkbox"/> Feedyard	<input type="checkbox"/> Abandoned water well	Direction from well? <u>Southeast</u>
<input type="checkbox"/> Cess pool	<input type="checkbox"/> Livestock pens	<input type="checkbox"/> Oil well/Gas well	How many feet? <u>1800</u>

FROM	TO	PLUGGING MATERIALS	FROM	TO	PLUGGING MATERIALS
0	3	Top Soil			
3	118	Bentonite/Portland Grout			

**7 CONTRACTOR'S OR LANDOWNER'S CERTIFICATION:** This water well was plugged under my jurisdiction and was completed on (mo/day/year) 12/28/2016 and this record is true to the best of my knowledge and belief. Kansas Water Well Contractor's License No. 710. This Water Well Record was completed on (mo/day/year) 12/29/2016 under the business name of Below Ground Surface, Inc. by (signature) Clay K. Flaw

Send one white copy to Kansas Department of Health & Environment, Geology Section, 1000 SW Jackson Street, Ste. 420, Topeka, KS 66612-1367. Send one copy to WATER WELL OWNER and retain one for your records.  
 Visit us at <http://www.kdheks.gov/waterwell/index.html> Telephone 785-296-5524.

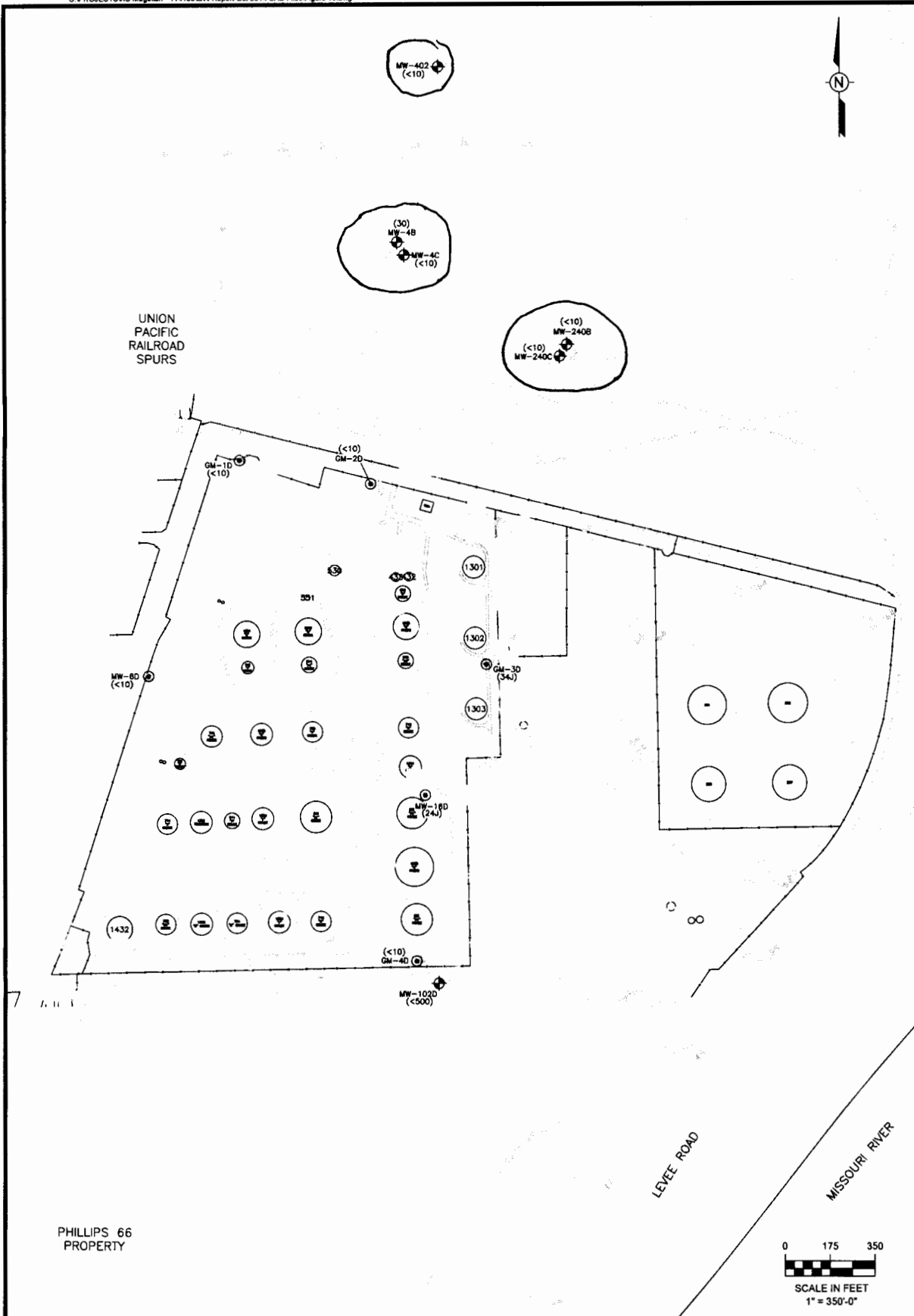

LEGEND:	
	PERMANENT MONITORING WELL
	DIRECT PUSH
	ON-SITE WELL
	TEMPORARY PIEZOMETER
	TPH-GRO ISOCONCENTRATION CONTOUR
(<300)	TPH-GRO CONCENTRATION (IN ug/L)
(NS)	NOT SAMPLED
(E)	ESTIMATED CONCENTRATION

**TPH-GRO CONCENTRATIONS - DEEP ZONE**  
**OCTOBER 2014**  
 MAGELLAN MAINSTREAM PARTNERS L.P.  
 KANSAS CITY TERMINAL  
 KANSAS CITY, KANSAS

DRAWN BY:	MM/BPA	DATE:	1/28/2015
PROJECT NO:	114106	DWG FILE:	Figure 10

**TRC**  
 415 SOUTH 18TH STREET, SUITE 105  
 ST. LOUIS, MO 63103  
 P: 314.241.2884  
 F: 314.241.2743

**FIGURE**  
10



8110 Cole Pkwy. Shawnee, KS 66227

---

Office: 913-441-1088  
Fax: 913-441-1086  
e-mail: [midwestbgs@sbcglobal.net](mailto:midwestbgs@sbcglobal.net)  
[www.belowgroundsurface.com](http://www.belowgroundsurface.com)

January 8, 2017

Kansas Department of Health and Environment  
Bureau of Water-Geology Section  
1000 S.W. Jackson Street, Suite 420  
Topeka, KS 66612-1367

Re: WWC-5P Forms for a Site in Kansas City, KS

Dear KDHE:

Enclosed are your copies of the KDHE WWC-5P Water Well Plugging Records for wells that were recently abandoned in Kansas City, KS. Please let us know if you have any questions or concerns.

If you have any questions, please call me at (913) 441-1088. Thank you.

Sincerely,  
**Below Ground Surface, Inc.**

Mike Ocsody, PG

Enclosure

RECEIVED  
JAN 17 2017  
BUREAU OF WATER