

**1 LOCATION OF WATER WELL:** Fraction  $\frac{1}{4}$   $\frac{1}{4}$  SE  $\frac{1}{4}$  SE  $\frac{1}{4}$  Section Number 27 Township Number T 10 S Range Number 25  E  W  
 County: Wyandotte

Street/Rural Address of Well Location; if unknown, distance & direction from nearest town or intersection: If at owner's address, check here  wells located on GM-Fairfax Plant at Fairfax Trafficway and Kindleberger Road Kansas City, KS

**Global Positioning Systems (GPS) information:**  
 Latitude: 38.143291 (in decimal degrees)  
 Longitude: -94.601179 (in decimal degrees)  
 Elevation: \_\_\_\_\_  
 Horizontal Datum:  WGS84,  NAD83,  NAD27  
 Collection Method: \_\_\_\_\_

**2 WATER WELL OWNER:** Magellan Midstream Partners  
 RR#, St. Address, Box #: 401 E. Donovan Road  
 City, State ZIP Code: Kansas City, KS 66215

GPS unit (Make/Model: Garmin etrek)  
 Digital Map/Photo,  Topographic Map,  Land Survey  
 Est. Accuracy:  < 3 m,  3-5 m,  5-15 m,  > 15 m

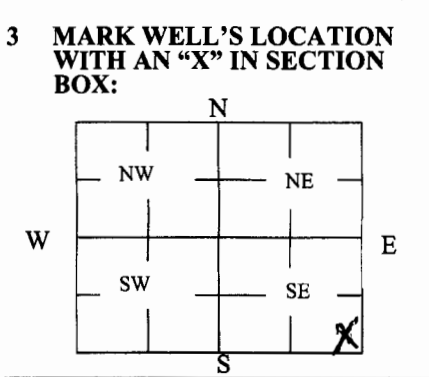

**4 DEPTH OF WELL** 100 ft.  
 WELL'S STATIC WATER LEVEL \_\_\_\_\_ ft.  
 WELL WAS USED AS:

Domestic  Public Water Supply  Dewatering  
 Irrigation  Oil Field Water Supply  Monitoring MMW-240C  
 Feedlot  Domestic (Lawn & Garden)  Injection Well  
 Industrial  Air Conditioning  Other \_\_\_\_\_

Was a chemical/bacteriological sample submitted to Department? Yes  No

**5 TYPE OF BLANK CASING USED:**

Steel  RMP (SR)  Wrought  Fiberglass  Other (Specify below)  
 PVC  ABS  Asbestos-Cement  Concrete Tile

Blank casing diameter 2 in. Was casing pulled? Yes  No  If yes, how much 10 feet  
 Casing height above or below land surface 30 in.

**6 GROUT PLUG MATERIAL:**  Neat cement  Cement grout  Bentonite  Other Top Soil

Grout Plug Intervals: From 0 ft. to 3 ft., From 3 ft. to 100 ft., From \_\_\_\_\_ ft. to \_\_\_\_\_ ft.

What is the nearest source of possible contamination:

Septic tank  Seepage pit  Fuel storage  Other (specify below) \_\_\_\_\_  
 Sewer lines  Pit privy  Fertilizer storage \_\_\_\_\_  
 Watertight sewer lines  Sewage lagoon  Insecticide storage \_\_\_\_\_  
 Lateral lines  Feedyard  Abandoned water well Direction from well? Southeast  
 Cess pool  Livestock pens  Oil well/Gas well How many feet? 1000

| FROM | TO  | PLUGGING MATERIALS       | FROM | TO | PLUGGING MATERIALS |
|------|-----|--------------------------|------|----|--------------------|
| 0    | 3   | Top Soil                 |      |    |                    |
| 3    | 100 | Bentonite/Portland Grout |      |    |                    |
|      |     |                          |      |    |                    |
|      |     |                          |      |    |                    |
|      |     |                          |      |    |                    |

**7 CONTRACTOR'S OR LANDOWNER'S CERTIFICATION:** This water well was plugged under my jurisdiction and was completed on (mo/day/year) 12/28/2016 and this record is true to the best of my knowledge and belief. Kansas Water Well Contractor's License No. 710. This Water Well Record was completed on (mo/day/year) 12/29/2016 under the business name of Below Ground Surface, Inc. by (signature) [Signature]

Send one white copy to Kansas Department of Health & Environment, Geology Section, 1000 SW Jackson Street, Ste. 420, Topeka, KS 66612-1367. Send one copy to WATER WELL OWNER and retain one for your records.  
 Visit us at <http://www.kdheks.gov/waterwell/index.html> Telephone 785-296-5524.

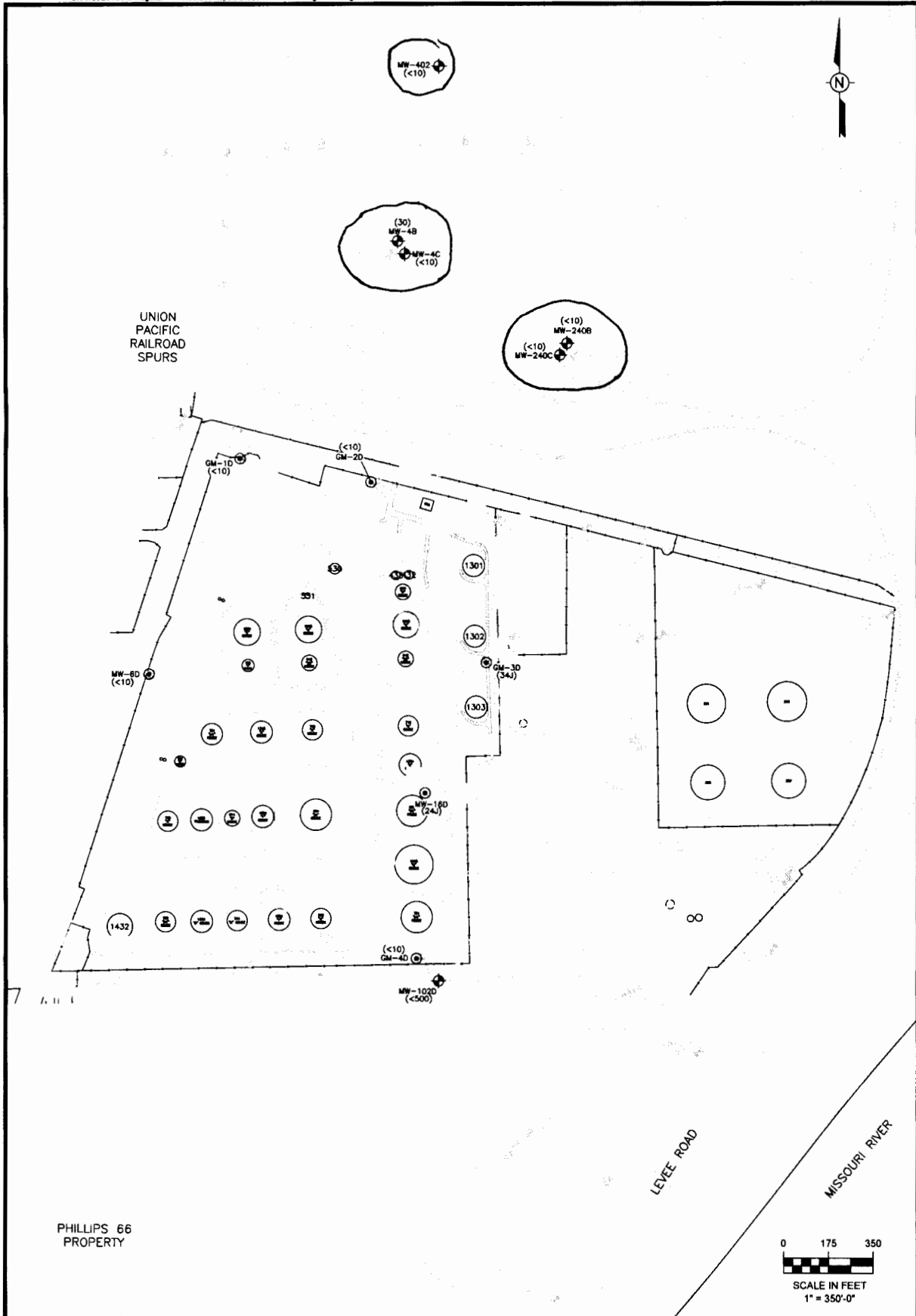

| LEGEND: |                                  |
|---------|----------------------------------|
|         | PERMANENT MONITORING WELL        |
|         | DIRECT PUSH                      |
|         | ON-SITE WELL                     |
|         | TEMPORARY PIEZOMETER             |
|         | TPH-GRO ISOCONCENTRATION CONTOUR |
| (<500)  | TPH-GRO CONCENTRATION (IN ug/L)  |
| (NS)    | NOT SAMPLED                      |
| (E)     | ESTIMATED CONCENTRATION          |

**TPH-GRO CONCENTRATIONS - DEEP ZONE**  
**OCTOBER 2014**  
 MAGELLAN MAINSTREAM PARTNERS L.P.  
 KANSAS CITY TERMINAL  
 KANSAS CITY, KANSAS

|             |        |           |           |
|-------------|--------|-----------|-----------|
| DRAWN BY:   | MM/SPA | DATE:     | 1/28/2015 |
| PROJECT NO: | 114106 | DWG FILE: | Figure 10 |

**TRC**  
 415 SOUTH 18TH STREET, SUITE 105  
 ST. LOUIS, MO 63103  
 P: 314.241.2684  
 F: 314.241.2743

**FIGURE**  
10



8110 Cole Pkwy. Shawnee, KS 66227

---

Office: 913-441-1088  
Fax: 913-441-1086  
e-mail: [midwestbgs@sbcglobal.net](mailto:midwestbgs@sbcglobal.net)  
[www.belowgroundsurface.com](http://www.belowgroundsurface.com)

January 8, 2017

Kansas Department of Health and Environment  
Bureau of Water-Geology Section  
1000 S.W. Jackson Street, Suite 420  
Topeka, KS 66612-1367

Re: WWC-5P Forms for a Site in Kansas City, KS

Dear KDHE:

Enclosed are your copies of the KDHE WWC-5P Water Well Plugging Records for wells that were recently abandoned in Kansas City, KS. Please let us know if you have any questions or concerns.

If you have any questions, please call me at (913) 441-1088. Thank you.

Sincerely,  
**Below Ground Surface, Inc.**

Mike Ocsody, PG

Enclosure

RECEIVED  
JAN 17 2017  
BUREAU OF WATER