

**WATER WELL PLUGGING RECORD Form WWC-5P**

KSA 82a-1212

ID NO.

**INX-14**

<b>1 LOCATION OF WATER WELL:</b> County: Wyandotte	Fraction ¼ sw ¼ sw ¼ ne ¼	Section Number 34	Township Number T 10 S	Range Number 25 <input checked="" type="checkbox"/> E <input type="checkbox"/> W
---	------------------------------	----------------------	---------------------------	---

Street/Rural Address of Well Location; if unknown, distance & direction from nearest town or intersection: If at owner's address, check here <input type="checkbox"/> Former INX Facility Stanley Rd. and Chrysler Kansas City, 66115	<b>Global Positioning Systems (GPS) information:</b> Latitude: <u>39.13635</u> (in decimal degrees) Longitude: <u>-94.61116</u> (in decimal degrees) Elevation: <u>733</u> Horizontal Datum: <input checked="" type="checkbox"/> WGS84, <input type="checkbox"/> NAD83, <input type="checkbox"/> NAD27 Collection Method: <input type="checkbox"/> GPS unit (Make/Model: _____) <input checked="" type="checkbox"/> Digital Map/Photo, <input type="checkbox"/> Topographic Map, <input type="checkbox"/> Land Survey Est. Accuracy: <input checked="" type="checkbox"/> < 3 m, <input type="checkbox"/> 3-5 m, <input type="checkbox"/> 5-15 m, <input type="checkbox"/> > 15 m
---	--

<b>2 WATER WELL OWNER:</b> INX International Ink Co. RR#, St. Address, Box #: 150 N. Martingale Rd., Ste. 700 City, State ZIP Code: Schaumburg, IL 60173	
--	--

<b>3 MARK WELL'S LOCATION WITH AN "X" IN SECTION BOX:</b> 	<b>4 DEPTH OF WELL</b> <u>29.45</u> ft. <b>WELL'S STATIC WATER LEVEL</b> <u>18.65</u> ft. <b>WELL WAS USED AS:</b> <table style="width:100%;"> <tr> <td><input type="checkbox"/> Domestic</td> <td><input type="checkbox"/> Public Water Supply</td> <td><input type="checkbox"/> Dewatering</td> </tr> <tr> <td><input type="checkbox"/> Irrigation</td> <td><input type="checkbox"/> Oil Field Water Supply</td> <td><input type="checkbox"/> Monitoring</td> </tr> <tr> <td><input type="checkbox"/> Feedlot</td> <td><input type="checkbox"/> Domestic (Lawn &amp; Garden)</td> <td><input type="checkbox"/> Injection Well</td> </tr> <tr> <td><input type="checkbox"/> Industrial</td> <td><input type="checkbox"/> Air Conditioning</td> <td><input type="checkbox"/> Other <u>INX-14</u></td> </tr> </table> Was a chemical/bacteriological sample submitted to Department? Yes <input type="checkbox"/> No <input checked="" type="checkbox"/>	<input type="checkbox"/> Domestic	<input type="checkbox"/> Public Water Supply	<input type="checkbox"/> Dewatering	<input type="checkbox"/> Irrigation	<input type="checkbox"/> Oil Field Water Supply	<input type="checkbox"/> Monitoring	<input type="checkbox"/> Feedlot	<input type="checkbox"/> Domestic (Lawn & Garden)	<input type="checkbox"/> Injection Well	<input type="checkbox"/> Industrial	<input type="checkbox"/> Air Conditioning	<input type="checkbox"/> Other <u>INX-14</u>
<input type="checkbox"/> Domestic	<input type="checkbox"/> Public Water Supply	<input type="checkbox"/> Dewatering											
<input type="checkbox"/> Irrigation	<input type="checkbox"/> Oil Field Water Supply	<input type="checkbox"/> Monitoring											
<input type="checkbox"/> Feedlot	<input type="checkbox"/> Domestic (Lawn & Garden)	<input type="checkbox"/> Injection Well											
<input type="checkbox"/> Industrial	<input type="checkbox"/> Air Conditioning	<input type="checkbox"/> Other <u>INX-14</u>											

**5 TYPE OF BLANK CASING USED:**

<input checked="" type="checkbox"/> Steel	<input type="checkbox"/> RMP (SR)	<input type="checkbox"/> Wrought	<input type="checkbox"/> Fiberglass	<input type="checkbox"/> Other (Specify below)
<input type="checkbox"/> PVC	<input type="checkbox"/> ABS	<input type="checkbox"/> Asbestos-Cement	<input type="checkbox"/> Concrete Tile	

Blank casing diameter 2 in. Was casing pulled? Yes  No  If yes, how much Top 3-feet  
 Casing height above or below land surface 0 in.

**6 GROUT PLUG MATERIAL:**  Neat cement  Cement grout  Bentonite  Other Topsoil and grass seed

Grout Plug Intervals: From 3 ft. to 29.45 ft., From N/A ft. to N/A ft., From N/A ft. to N/A ft.

What is the nearest source of possible contamination:

<input type="checkbox"/> Septic tank	<input type="checkbox"/> Seepage pit	<input checked="" type="checkbox"/> Fuel storage	<input type="checkbox"/> Other (specify below)
<input type="checkbox"/> Sewer lines	<input type="checkbox"/> Pit privy	<input type="checkbox"/> Fertilizer storage	
<input type="checkbox"/> Watertight sewer lines	<input type="checkbox"/> Sewage lagoon	<input type="checkbox"/> Insecticide storage	
<input type="checkbox"/> Lateral lines	<input type="checkbox"/> Feedyard	<input type="checkbox"/> Abandoned water well	Direction from well? <u>Adjacent</u>
<input type="checkbox"/> Cess pool	<input type="checkbox"/> Livestock pens	<input type="checkbox"/> Oil well/Gas well	How many feet? <u>0-feet</u>

FROM	TO	PLUGGING MATERIALS	FROM	TO	PLUGGING MATERIALS
0	3	Topsoil/grass seed			
3	29.45	Bentonite (hydrated)			

**7 CONTRACTOR'S OR LANDOWNER'S CERTIFICATION:** This water well was plugged under my jurisdiction and was completed on (mo/day/year) 8/30/2021 and this record is true to the best of my knowledge and belief. Kansas Water Well Contractor's License No. 759. This Water Well Record was completed on (mo/day/year) 9/23/2021 under the business name of RAZEK Environmental, LLC by (signature) *[Signature]*

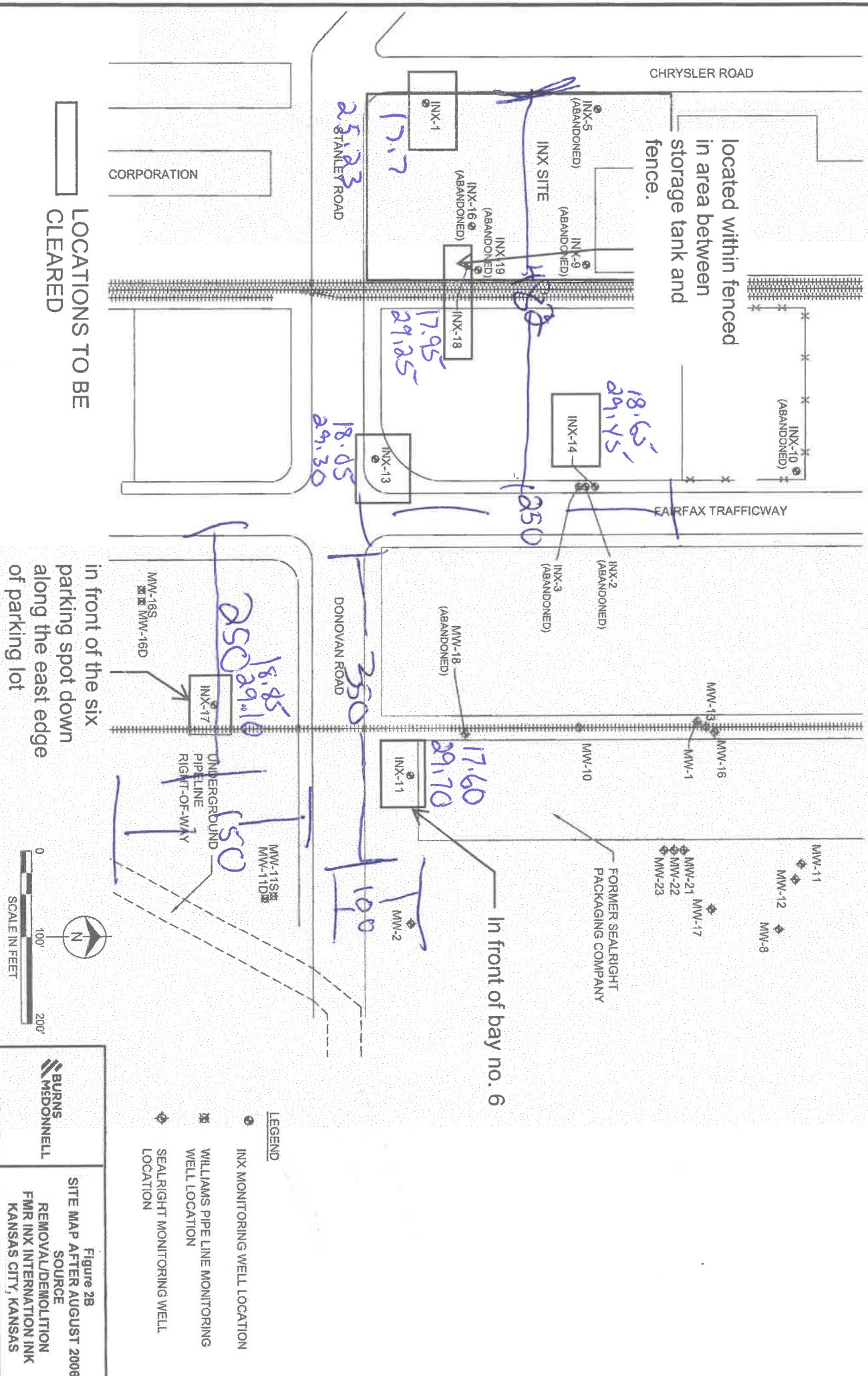

located within fenced  
in area between  
storage tank and  
fence.

LOCATIONS TO BE  
CLEARED

In front of the six  
parking spot down  
along the east edge  
of parking lot

In front of bay no. 6

0700-0815

Revised 0945 Change 10:45