

VBR1

USE TYPEWRITER OR BALL POINT PEN-PRESS FIRMLY, PRINT CLEARLY.

WATER WELL RECORD  
KSA 82a-1201-1215

Kansas Department of Health and Environment-Division of Environment  
(Water well Contractors)  
Topeka, Kansas 66620

1. Location of well:	County <b>WVANDOTTE</b>	Fraction <b>S<sup>W</sup> NW SE</b> <del>SW NE SW</del> / 4	Section number <b>27</b>	Township number T <b>10</b>	Range number S R <b>25 E</b> E/W
----------------------	----------------------------	---	-----------------------------	--------------------------------	-------------------------------------

2. Distance and direction from nearest town or city: Street address of well location if in city:	3. Owner of well: <b>OWENS - CORNING FIBERGLAS CORPORATION</b> R.R. or street: City, state, zip code: <b>KANSAS CITY, KANSAS</b>
---	--

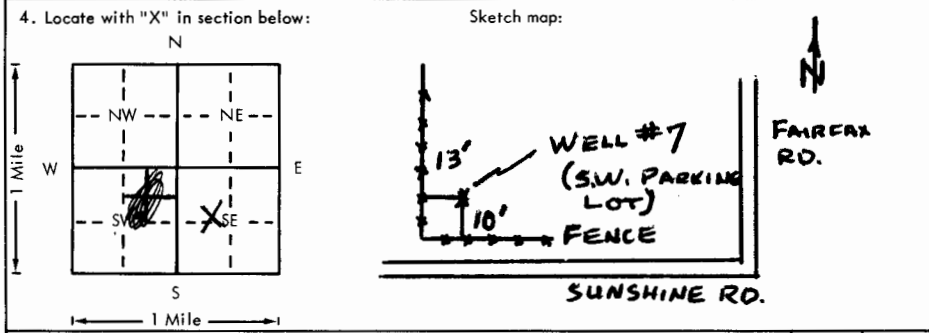

6. Bore hole dia. **48** in. Completion date **7-24-78**  
Well depth **121.5** ft.

7.  Cable tool  Rotary  Driven  Dug  
 Hollow rod  Jetted  Bored  Reverse rotary

8. Use:  Domestic  Public supply  Industry  
 Irrigation  Air conditioning  Stock  
 Lawn  Oil field water  Other

9. Casing: Material **STEEL** Height: Above or below  
Threaded  Welded  Surface **18** in.  
RMP  PVC  Weight \_\_\_\_\_ lbs./ft.  
Dia. **18** in. to **80** ft. depth Wall Thickness: inches or  
Dia. \_\_\_\_\_ in. to \_\_\_\_\_ ft. depth gage No. **.410"**

5. Type and color of material	From	To
ASPHALT	0'0"	0'3"
GRAVEL FILL	0'3"	0'6"
BRN. TO GRAY CLAYEY SILT	0'6"	13'0"
BRN FINE SAND	13'0"	25'0"
BRN MED TO FINE SAND	25'0"	37'0"
GRAY FINE SAND	40'0"	52'0"
GRAY COARSE TO MED. SAND W/TRACE GRAVEL	52'0"	66'0"
GRAY FINE TO MED. SAND	66'0"	70'0"
GRAY MED. TO COARSE SAND W/FINE SAND & TR. GRAVEL	70'0"	73'0"
GRAY COARSE TO MED. SAND W/ GRAVEL	73'0"	85'0"
GRAY COARSE TO MED. SAND W/ GRAVEL & FEW BOULDERS	85'0"	89'0"
BOULDER	89'0"	90'0"
GRAY COARSE TO MED. SAND W/ GRAVEL & FEW BOULDERS	90'0"	125'0"

10. Screen: Manufacturer's name **LAYNE**  
**S. STEEL**  
Type **SHUTTER** Dia. **18"**  
Slot/gauze **NO. 5** Length **40**  
Set between **80** ft. and **120** ft.  
Gravel pack?  Size range of material **QUADERS #25**

11. Static water level: \_\_\_\_\_ mo./day/yr.  
**20.7** ft. below land surface Date **8-3-78**

12. Pumping level below land surfaces:  
**24** ft. after **1** hrs. pumping **981** g.p.m.  
\_\_\_\_\_ ft. after \_\_\_\_\_ hrs. pumping \_\_\_\_\_ g.p.m.  
Estimated maximum yield \_\_\_\_\_ g.p.m.

13. Water sample submitted: \_\_\_\_\_ mo./day/yr.  
Yes  No  Date \_\_\_\_\_

14. Well head completion:  
 Pitless adapter \_\_\_\_\_ Inches above grade

15. Well grouted?   
With:  Neat cement  Bentonite  Concrete  
Depth: From **0** ft. to **20** ft.

16. Nearest source of possible contamination: \_\_\_\_\_ Direction \_\_\_\_\_ Type \_\_\_\_\_  
Well disinfected upon completion?  Yes  No

17. Pump: \_\_\_\_\_ Not installed  
Manufacturer's name **LAYNE**  
Model number **21834** HP **100** Volts **440**  
Length of drop pipe \_\_\_\_\_ ft. capacity \_\_\_\_\_ g.p.m.  
Type:  
 Submersible  Turbine  
 Jet  Reciprocating  
 Centrifugal  Other

18. Elevation: **747**  
Topography:  
 Hill  
 Slope  
 Upland  
 Valley

19. Remarks:  
  
(Use a second sheet if needed)

20. Water well contractor's certification:  
This well was drilled under my jurisdiction and this report is true to the best of my knowledge and belief.  
**LAYNE - WESTERN CO. INC. 102**  
Business name License No. \_\_\_\_\_  
Address **1010 W. 39th K.C. Mo.**  
Signed **WBR** Date **3-21-79**  
Authorized representative

10 250 27 S.W. 1/4 1/4 1/4

BR = 622 D = 726