

WATER WELL PLUGGING RECORD Form WWC-5P

KSA 82a-1212 ID NO.

6B-97-0992-2

1 LOCATION OF WATER WELL: Fraction SE 1/4 NW 1/4 NE 1/4 1/4 Section Number 33 Township Number T10 S Range Number 6 E W
 County: Riley

Street/Rural Address of Well Location; if unknown, distance & direction from nearest town or intersection: If at owner's address, check here

Global Positioning Systems (GPS) information:
 Latitude: 1663435.18 (in decimal degrees)
 Longitude: 297654.39 (in decimal degrees)
 Elevation: 1247.77
 Datum: WGS84, NAD83, NAD27

2 WATER WELL OWNER: Directorate of Public Works
 RR#, St. Address, Box #: CO: Dr. Richard Stredos
 City, State ZIP Code: 407 Main Post Ft. Riley Ks 66442

Collection Method:
 GPS unit (Make/Model: _____)
 Digital Map/Photo, Topographic Map, Land Survey
 Est. Accuracy: < 3 m, 3-5 m, 5-15 m, > 15 m

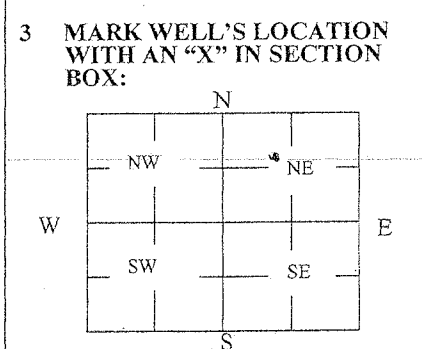

4 DEPTH OF WELL 89.31 ft.
 WELL'S STATIC WATER LEVEL Dry ft
 WELL WAS USED AS:
 Domestic Public Water Supply Dewatering
 Irrigation Oil Field Water Supply Monitoring
 Feedlot Domestic (Lawn & Garden) Injection Well
 Industrial Air Conditioning
 Was a chemical/bacteriological sample submitted to Department? Yes No

5 TYPE OF BLANK CASING USED:
 Steel RMP (SR) Wrought Fiberglass Other (Specify below)
 PVC ABS Asbestos-Cement Concrete Tile
 Blank casing diameter 1 in. Was casing pulled? Yes No If yes, how much 3'
 Casing height above or below and surface 36" in.

6 GROUT PLUG MATERIAL: Neat cement Cement grout Bentonite Other _____
 Grout Plug Intervals: From 89.31 ft. to 0' ft., From _____ ft. to _____ ft., From _____ to _____ ft.
 What is the nearest source of possible contamination:
 Septic tank Seepage pit Fuel Storage Other (specify below)
 Sewer lines Pit privy Fertilizer storage Range 16 FT Riley Ks
 Watertight sewer lines Sewage lagoon Insecticide storage
 Lateral lines Feedyard Abandoned water well Direction from well? N/A
 Cess pool Livestock pens Oil well/Gas well How many feet? N/A

FROM	TO	PLUGGING MATERIALS	FROM	TO	PLUGGING MATERIALS
89.31	0'	NEAT CEMENT			

7 CONTRACTOR'S OR LANDOWNER'S CERTIFICATION: This water well was plugged under my jurisdiction and was completed on (mo/day/year) 3-25-2012 and this record is true to the best of my knowledge and belief. Kansas Water Well Contractor's License No. 597. This Water Well Record was completed on (mo/day/year) 3-25-2012 under the business name of BOONT HONGYEAR by (signature) [Signature]

INSTRUCTIONS: Use typewriter or ballpoint pen. Please press firmly and print clearly. Please fill in blanks, underline or circle the correct answers. Send top three copies to Kansas Department of Health and Environment, Bureau of Water, Geology Section, 1000 SW Jackson St., Ste. 420, Topeka, Kansas 66612-1367. Telephone: 785/296-5524. Send one to Water Well Owner and retain one for your records. Visit us at <http://www.kdheks.gov/waterwell/index.html>.

Check one: White Copy Blue Copy Pink Copy