

1 LOCATION OF WATER WELL: Fraction NW 1/4 SE 1/4 NE 1/4 Section Number 33 Township Number T10 S Range Number 6 E W

County: Riley
 Street/Rural Address of Well Location; if unknown, distance & direction from nearest town or intersection: If at owner's address, check here
 Global Positioning Systems (GPS) information:
 Latitude: 1663711.58 (in decimal degrees)
 Longitude: 296988.82 (in decimal degrees)
 Elevation: 1182.30
 Datum: WGS84, NAD83, NAD27
 Collection Method:
 GPS unit (Make/Model: _____)
 Digital Map/Photo, Topographic Map, Land Survey
 Est. Accuracy: <3 m, 3-5 m, 5-15 m, >15 m

2 WATER WELL OWNER: Director of Public Works
 RR#, St. Address, Box #: Co: Dr Richard SHELDON
 City, State ZIP Code: 407 MAIN PAST FT Riley Ks 66440

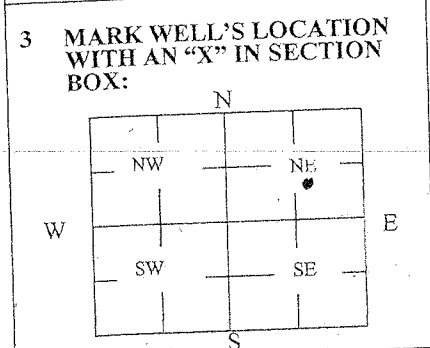

4 DEPTH OF WELL 45.22 ft.
 WELL'S STATIC WATER LEVEL 37.55 ft
 WELL WAS USED AS:
 Domestic Irrigation Public Water Supply Dewatering
 Feedlot Oil Field Water Supply Monitoring
 Industrial Domestic (Lawn & Garden) Injection Well
 Air Conditioning Other _____
 Was a chemical/bacteriological sample submitted to Department? Yes No

5 TYPE OF BLANK CASING USED:
 Steel RMP (SR) Wrought Fiberglass Other (Specify below) _____
 PVC ABS Asbestos-Cement Concrete Tile
 Blank casing diameter 1 in. Was casing pulled? Yes No If yes, how much 36"
 Casing height above or below land surface 36" in.

6 GROUT PLUG MATERIAL: Neat cement Cement grout Bentonite Other _____
 Grout Plug Intervals: From 45.22 ft. to 0' ft., From _____ ft. to _____ ft., From _____ to _____ ft.
 What is the nearest source of possible contamination:
 Septic tank Seepage pit Fuel Storage Other (specify below) Range 16 Ft Riley Ks
 Sewer lines Pit privy Fertilizer storage
 Watertight sewer lines Sewage lagoon Insecticide storage
 Lateral lines Feedyard Abandoned water well Oil well/Gas well
 Cess pool Livestock pens
 Direction from well? N/A
 How many feet? N/A

FROM	TO	PLUGGING MATERIALS	FROM	TO	PLUGGING MATERIALS
<u>45.22</u>	<u>0'</u>	<u>NEAT Cement</u>			

7 CONTRACTOR'S OR LANDOWNER'S CERTIFICATION: This water well was plugged under my jurisdiction and was completed on (mo/day/year) 2-25-2012 and this record is true to the best of my knowledge and belief. Kansas Water Well Contractor's License No. 597. This Water Well Record was completed on (mo/day/year) 3-15-2012 under the business name of Boart Hongyear Co by (signature) [Signature]

INSTRUCTIONS: Use typewriter or ballpoint pen. Please press firmly and print clearly. Please fill in blanks, underline or circle the correct answers. Send top three copies to Kansas Department of Health and Environment, Bureau of Water, Geology Section, 1000 SW Jackson St., Ste. 420, Topeka, Kansas 66612-1367. Telephone: 785/296-5524. Send one to Water Well Owner and retain one for your records. Visit us at <http://www.kdheks.gov/waterwell/index.html>.

Check one: White Copy Blue Copy Pink Copy