

1 LOCATION OF WATER WELL: County: Riley	Fraction 1/4 NW 1/4 NW 1/4 SW 1/4	Section Number 27	Township No. T 10 S	Range Number R 7 E W
---	--------------------------------------	----------------------	------------------------	-------------------------

Street/Rural Address of Well Location; if unknown, distance & direction from nearest town or intersection: If at owner's address, check here
Approximately 3 miles southwest of Manhattan

Global Positioning System (GPS) information:
Latitude: 39.152165 (in decimal degrees)
Longitude: -96.644033 (in decimal degrees)
Elevation: unknown
Datum: WGS 84, NAD 83, NAD 27
Collection Method:
 GPS unit (Make/Model: WAAS)
 Digital Map/Photo, Topographic Map, Land Survey
Est. Accuracy: <3 m, 3-5 m, 5-15 m, >15 m

2 WATER WELL OWNER: Wildcat Construction
RR#, Street Address, Box #: 4421 W. Harry
City, State, ZIP Code : Wichita, KS 67277

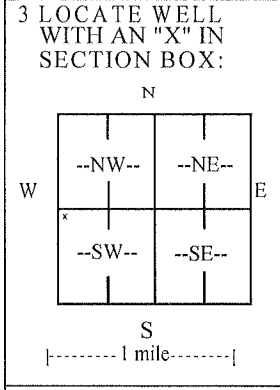

4 DEPTH OF COMPLETED WELL 41.50 ft.
Depth(s) Groundwater Encountered (1) _____ ft. (2) _____ ft. (3) _____ ft.
WELL'S STATIC WATER LEVEL 12.85 ft. below land surface measured on mo/day/yr 06/15/11
Pump test data: Well water was not checked ft. after _____ hours pumping _____ gpm
EST. YIELD _____ gpm. Well water was _____ ft. after _____ hours pumping _____ gpm
Bore Hole Diameter 12 in. to 43 ft., and _____ in. to _____ ft.
WELL WATER TO BE USED AS: Public water supply Geothermal Injection well
 Domestic Feedlot Oil field water supply Dewatering Other (Specify below)
 Irrigation Industrial Domestic-lawn & garden Monitoring well
Was a chemical/bacteriological sample submitted to Department? Yes No
If yes, mo/day/yr sample was submitted _____
Water well disinfected? Yes No

5 TYPE OF CASING USED: Steel PVC Other _____
CASING JOINTS: Glued Clamped Welded Threaded
Casing diameter 8 in. to 20 ft., Diameter _____ in. to _____ ft., Diameter _____ in. to _____ ft.
Casing height above land surface 18 in., Weight 5.59 lbs./ft., Wall thickness or gauge No. .332
TYPE OF SCREEN OR PERFORATION MATERIAL:
 Steel Stainless Steel PVC Other (Specify) _____
 Brass Galvanized Steel None used (open hole)
SCREEN OR PERFORATION OPENINGS ARE:
 Continuous slot Mill slot Gauze wrapped Torch cut Drilled holes None (open hole)
 Louvered shutter Key punched Wire wrapped Saw cut Other (specify) _____
SCREEN-PERFORATED INTERVALS: From 20 ft. to 40 ft., From _____ ft. to _____ ft.
From _____ ft. to _____ ft., From _____ ft. to _____ ft.
GRAVEL PACK INTERVALS: From 19 ft. to 43 ft., From _____ ft. to _____ ft.
From _____ ft. to _____ ft., From _____ ft. to _____ ft.

6 GROUT MATERIAL: Neat cement Cement grout Bentonite Other _____
Grout Intervals: From _____ ft. to _____ ft., From 0 ft. to 19 ft., From _____ ft. to _____ ft.
What is the nearest source of possible contamination:
 Septic tank Lateral lines Pit privy Livestock pens Insecticide storage Other (specify below)
 Sewer lines Cesspool Sewage lagoon Fuel storage Abandoned water well
 Watertight sewer lines Seepage pit Feedyard Fertilizer storage Oil well/gas well
None known
Direction from well _____ Distance from well _____

FROM	TO	LITHOLOGIC LOG	FROM	TO	LITHO. LOG (cont.) or PLUGGING INTERVALS
0	2	Topsoil, sandy			Note: please see attached letter from Richard Harper waiving the 20 ft grout requirement for this project.
2	15	Clay, sandy			
15	43	Sand & gravel, fine - medium			

7 CONTRACTOR'S OR LANDOWNER'S CERTIFICATION: This water well was constructed, reconstructed, or plugged under my jurisdiction and was completed on (mo/day/year) 06/15/11 and this record is true to the best of my knowledge and belief.
Kansas Water Well Contractor's License No. 185 This Water Well Record was completed on (mo/day/year) 06/24/11
under the business name of Clarke Well & Equipment, Inc. by (signature) [Signature]

INSTRUCTIONS: Use typewriter or ball point pen. PLEASE PRESS FIRMLY and PRINT clearly. Please fill in blanks and check the correct answers. Send three copies (white, blue, pink) to Kansas Department of Health and Environment, Bureau of Water, Geology Section, 1000 SW Jackson St., Suite 420, Topeka, Kansas 66612-1367. Telephone 785-296-5522. Send one copy to WATER WELL OWNER and retain one for your records. Include fee of \$5.00 for each constructed well. Visit us at <http://www.kdheks.gov/waterwell/index.html>.