

WATER WELL RECORD

Form WWC-5

Division of Water Resources App. No.

1 LOCATION OF WATER WELL: County: Riley, Fraction: 1/4 SW 1/4 SE 1/4 SE 1/4, Section Number: 22, Township No.: T 10 S, Range Number: R 7 E

Street/Rural Address of Well Location; if unknown, distance & direction from nearest town or intersection: 1/2 mile West of Manhattan, KS. Global Positioning System (GPS) information: Latitude, Longitude, Elevation, Datum, Collection Method.

2 WATER WELL OWNER: U.C. I. Inc., RR#, Street Address, Box #: PO Box 2079, City, State, ZIP Code: Wichita, KS 67201-2079

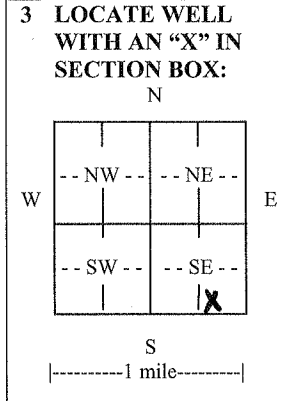

3 LOCATE WELL WITH AN 'X' IN SECTION BOX: N, W, E, S. 4 DEPTH OF COMPLETED WELL: 56 ft. Depth(s) Groundwater Encountered, WELL'S STATIC WATER LEVEL: 1.5 ft. below land surface, EST. YIELD: 1000 gpm, Bore Hole Diameter: 30 in. to 56 ft., WELL WATER TO BE USED AS: Dewatering, Was a chemical/bacteriological sample submitted? No, Water well disinfected? Yes

5 TYPE OF CASING USED: PVC, CASING JOINTS: Glued, Casing diameter: 16 in. to 36 ft., Casing height above land surface: 12 in., TYPE OF SCREEN OR PERFORATION MATERIAL: PVC, SCREEN OR PERFORATION OPENINGS ARE: Mill slot, SCREEN-PERFORATED INTERVALS: 36 ft. to 56 ft., GRAVEL PACK INTERVALS: 24 ft. to 56 ft.

6 GROUT MATERIAL: Bentonite, Grout Intervals: 4 ft. to 24 ft., What is the nearest source of possible contamination: Sewer Lift Station, Direction from well: Southwest, Distance from well: 25 ft.

Table with columns: FROM, TO, LITHOLOGIC LOG, FROM, TO, LITHO. LOG (cont.) or PLUGGING INTERVALS. Rows: 0-4 Sandy Top soil, 4-15 Clay, gray/silty, 15-25 Sand, fine, 25-56 Sand, fine to coarse w/gravel.

7 CONTRACTOR'S OR LANDOWNER'S CERTIFICATION: This water well was constructed, reconstructed, or plugged under my jurisdiction and was completed on (mo/day/year) 7/12/11 and this record is true to the best of my knowledge and belief. Kansas Water Well Contractor's License No. 138. This Water Well Record was completed on (mo/day/year) 7/21/11 under the business name of Peterson Irrigation, Inc. by (signature) Mike Peterson

INSTRUCTIONS: Use typewriter or ball point pen. PLEASE PRESS FIRMLY and PRINT clearly. Please fill in blanks and check the correct answers. Send three copies (white, blue, pink) to Kansas Department of Health and Environment, Bureau of Water, Geology Section, 1000 SW Jackson St., Suite 420, Topeka, Kansas 66612-1367. Telephone 785-296-5522. Send one copy to WATER WELL OWNER and retain one for your records. Include fee of \$5.00 for each constructed well. Visit us at http://www.kdheks.gov/waterwell/index.html.