

1 LOCATION OF WATER WELL: County: <u>Riley</u>	Fraction <u>NW ¼ NW ¼ NW ¼</u>	Section Number <u>33</u>	Township Number <u>10S</u>	Range Number <u>10E</u>
----------------------------------------------------------	-----------------------------------	-----------------------------	-------------------------------	----------------------------

Distance and direction from nearest town or city street address of well if located within city?
 5106 Murray Rd., Manhattan, KS

2 WATER WELL OWNER: KDHE RR#, St. Address, Box #: <u>1000 SW Jackson, Ste 410</u> City, State, ZIP Code: <u>Topeka, KS 66612</u>	Global Positioning System (decimal degrees, min. of 4 digits) Latitude: <u>NA</u> Longitude: <u>NA</u> Elevation: <u>NA</u> Datum: <u>NA</u> Data Collection Method: <u>NA</u>
-------------------------------------------------------------------------------------------------------------------------------------------------------	------------------------------------------------------------------------------------------------------------------------------------------------------------------------------------------------------

3 MARK WELL'S LOCATON WITH AN "X" IN SECTION BOX:

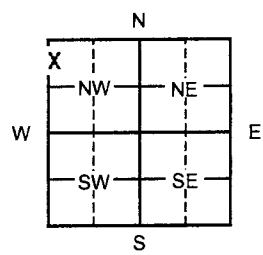

4 DEPTH OF WELL 22.6 ft. MW2

WELL'S STATIC WATER LEVEL NA ft.

WELL WAS USED AS:

1 Domestic	5 Public Water Supply	9 Dewatering
2 Irrigation	6 Oil Field Water Supply	<input checked="" type="radio"/> 10 Monitoring
3 Feedlot	7 Domestic (Lawn & Garden)	11 Injection Well
4 Industrial	8 Air Conditioning	12 Other _____

Was a chemical/bacteriological sample submitted to Department? Yes No

5 TYPE OF BLANK CASING USED:

1 Steel	3 RMP (SR)	5 Wrought	7 Fiberglass	9 Other (specify below)
<input checked="" type="radio"/> 2 PVC	4 ABS	6 Asbestos-Cement	8 Concrete Tile	

Blank casing diameter 2 in. Was casing pulled? Yes No If yes, how much 3'
 Casing height above or below land surface NA in.

6 GROUT PLUG MATERIAL: 1 Neat cement 2 Cement grout 3 Bentonite 4 Other Soil; 0-3'

Grout Plug Intervals: From 3 ft. to 22.6 ft., From _____ ft. to _____ ft., From _____ ft. to _____ ft.

What is the nearest source of possible contamination:

1 Septic tank	6 Seepage pit	11 Fuel storage	16 Other (specify below)
2 Sewer lines	7 Pit privy	12 Fertilizer storage	
3 Watertight sewer lines	8 Sewage lagoon	13 Insecticide storage	
4 Lateral lines	9 Feedyard	14 Abandoned water well	Direction from well?
5 Cess pool	10 Livestock pens	15 Oil well/Gas well	How many feet?

FROM	TO	PLUGGING MATERIALS	FROM	TO	PLUGGING MATERIALS
<u>0</u>	<u>3</u>	<u>Soil</u>			
<u>3</u>	<u>22.6</u>	<u>Bentonite</u>			

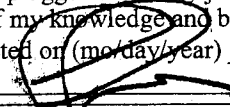
7 CONTRACTOR'S OR LANDOWNER'S CERTIFICATION: This water well was plugged under my jurisdiction and was completed on (mo/day/year) 9/3/14 and this record is true to the best of my knowledge and belief. Kansas Water Well Contractor's License No. 757. This Water Well Record was completed on (mo/day/year) 9/10/14 under the business name of Larsen and Associates, Inc. by (signature) 

INSTRUCTIONS: Please fill in blanks or circle the correct answers. Send top three copies to Kansas Department of Health and Environment, Bureau of Water, Geology Section, 1000 SW Jackson St., Ste. 420, Topeka, Kansas 66612-1367. Telephone: 785/296-5522. Send one to Water Well Owner and retain one for your records. Visit us at <http://www.kdheks.gov/waterwell>.

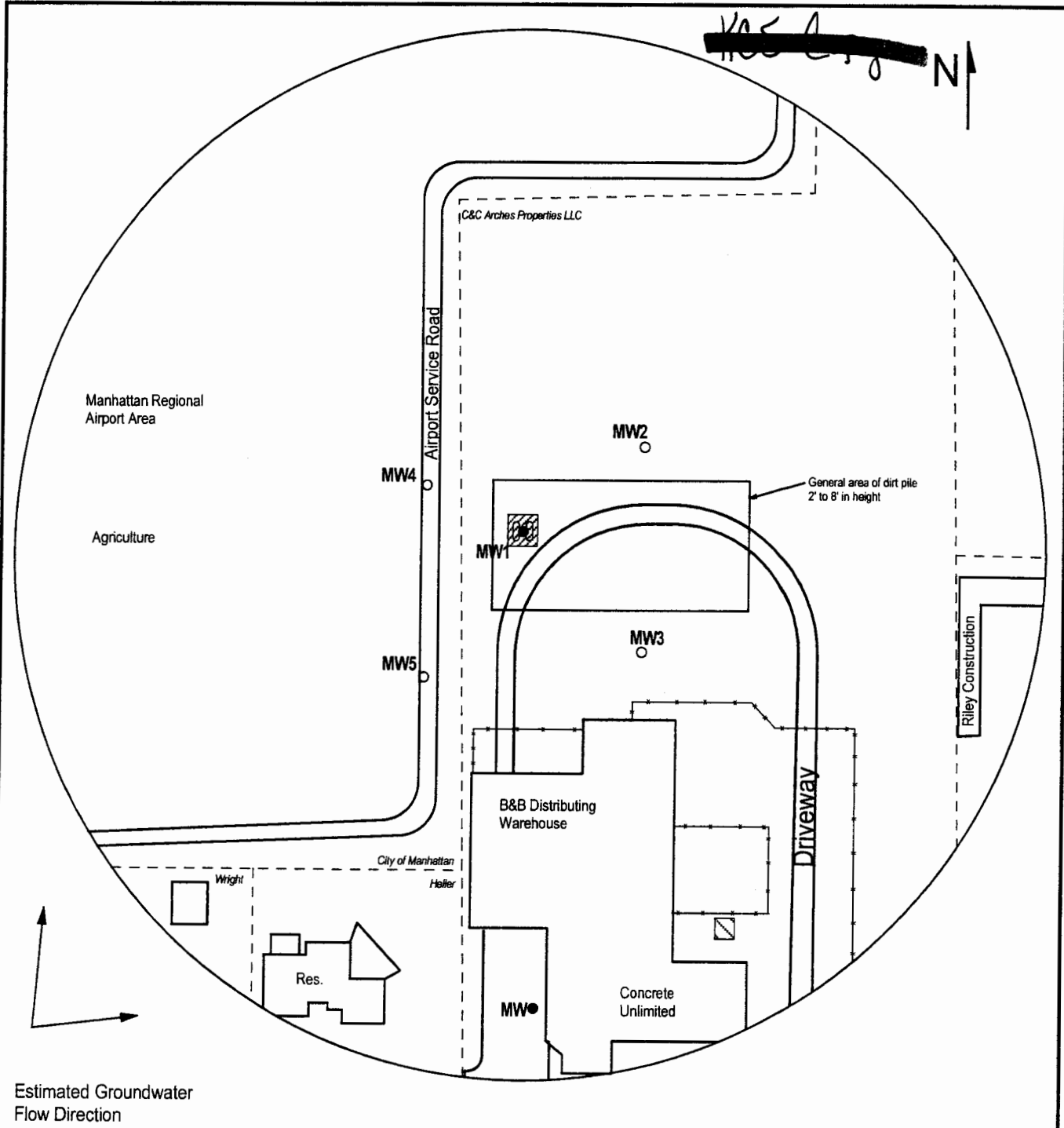

FIGURE 1 - 350 FT RADIUS AREA BASE MAP



PROJECT:
 B&B Distributing, Inc.
 5106 Murray Rd.
 Manhattan, KS
 KDHE ID: U5-081-00476
 Date: 9/3/14

LEGEND:

- Approximate Location of Former UST Basin and Pump Island
- Approximate Location of Former Waste Oil Tank
- Approximate Location of Property Line
- Monitoring Well
- Plugged Monitoring Well

1311 E 25th St., Suite B (785) 841-8707 office
 Lawrence, KS 66046 (785) 865-4282 fax

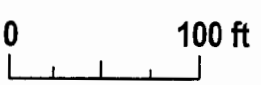

NOTE: Well MW1 was unable to be located under a pile of soil.
 NOTE: Location of product lines is unknown.

County: Riley Fraction NW NW NW Sec. 33 T 10 S R 7 (E)W

CORRECTION(S) TO WATER WELL COMPLETION RECORD (WWC-5)

(to rectify lacking or incorrect information)

Owner: KDHE

Location was listed as:

Section-Township-Range: 33-10S-10E

Fraction (1/4 1/4 1/4): NW NW NW

Location changed to:

33-10S-7E

NW NW NW

Other changes: Initial statements: _____

Changed to: _____

Comments: _____

Verification method: well site address, area road map, other monitoring well records for same owner at same location, and mapping tool & aerial photos on KGS website initials: DRJ date: 12/18/2014

Submitted by: Kansas Geological Survey, Data Resources Library, 1930 Constant Ave., Lawrence, KS 66047-3726

to: Kansas Dept of Health & Environment, Bureau of Water, 1000 SW Jackson, Suite 420, Topeka, KS 66612-1367.