

WATER WELL PLUGGING RECORD Form WWC-5P

KSA 82a-1212

ID NO.

1 LOCATION OF WATER WELL: County: Riley	Fraction NW ¼ NW ¼ NW ¼	Section Number 33	Township Number 10S	Range Number 10E
--	-----------------------------------	-----------------------------	-------------------------------	----------------------------

Distance and direction from nearest town or city street address of well if located within city?

5106 Murray Rd., Manhattan, KS

2 WATER WELL OWNER: KDHE RR#, St. Address, Box #: 1000 SW Jackson, Ste 410 City, State, ZIP Code: Topeka, KS 66612	Global Positioning System (decimal degrees, min. of 4 digits) Latitude: <u>NA</u> Longitude: <u>NA</u> Elevation: <u>NA</u> Datum: <u>NA</u> Data Collection Method: <u>NA</u>
---	--

3 MARK WELL'S LOCATON WITH AN "X" IN SECTION BOX:

4 DEPTH OF WELL 23.7 ft. MW5

WELL'S STATIC WATER LEVEL NA ft.

WELL WAS USED AS:

1 Domestic	5 Public Water Supply	9 Dewatering
2 Irrigation	6 Oil Field Water Supply	10 Monitoring
3 Feedlot	7 Domestic (Lawn & Garden)	11 Injection Well
4 Industrial	8 Air Conditioning	12 Other _____

Was a chemical/bacteriological sample submitted to Department? Yes No X

5 TYPE OF BLANK CASING USED:

1 Steel	3 RMP (SR)	5 Wrought	7 Fiberglass	9 Other (specify below)
2 PVC	4 ABS	6 Asbestos-Cement	8 Concrete Tile	

Blank casing diameter 2 in. Was casing pulled? Yes x No If yes, how much 3'

Casing height above or below land surface NA in.

6 GROUT PLUG MATERIAL: 1 Neat cement 2 Cement grout 3 Bentonite 4 Other Soil; 0-3'

Grout Plug Intervals: From 3 ft. to 23.7 ft., From _____ ft. to _____ ft., From _____ ft. to _____ ft.

What is the nearest source of possible contamination:

- | | | | |
|--------------------------|-------------------|-------------------------|--------------------------|
| 1 Septic tank | 6 Seepage pit | 11 Fuel storage | 16 Other (specify below) |
| 2 Sewer lines | 7 Pit privy | 12 Fertilizer storage | |
| 3 Watertight sewer lines | 8 Sewage lagoon | 13 Insecticide storage | |
| 4 Lateral lines | 9 Feedyard | 14 Abandoned water well | Direction from well? |
| 5 Cess pool | 10 Livestock pens | 15 Oil well/Gas well | How many feet? |

FROM	TO	PLUGGING MATERIALS	FROM	TO	PLUGGING MATERIALS
0	3	Soil			
3	23.7	Bentonite			

7 CONTRACTOR'S OR LANDOWNER'S CERTIFICATION: This water well was plugged under my jurisdiction and was completed on (mo/day/year) 9/3/14 and this record is true to the best of my knowledge and belief. Kansas Water Well Contractor's License No. 757. This Water Well Record was completed on (mo/day/year) 9/10/14 under the business name of Larsen and Associates, Inc. by (signature) _____

INSTRUCTIONS: Please fill in blanks or circle the correct answers. Send top three copies to Kansas Department of Health and Environment, Bureau of Water, Geology Section, 1000 SW Jackson St., Ste. 420, Topeka, Kansas 66612-1367. Telephone: 785/296-5522. Send one to Water Well Owner and retain one for your records. Visit us at <http://www.dhhs.gov/waterwell>.

~~105 2 8~~ N ↑

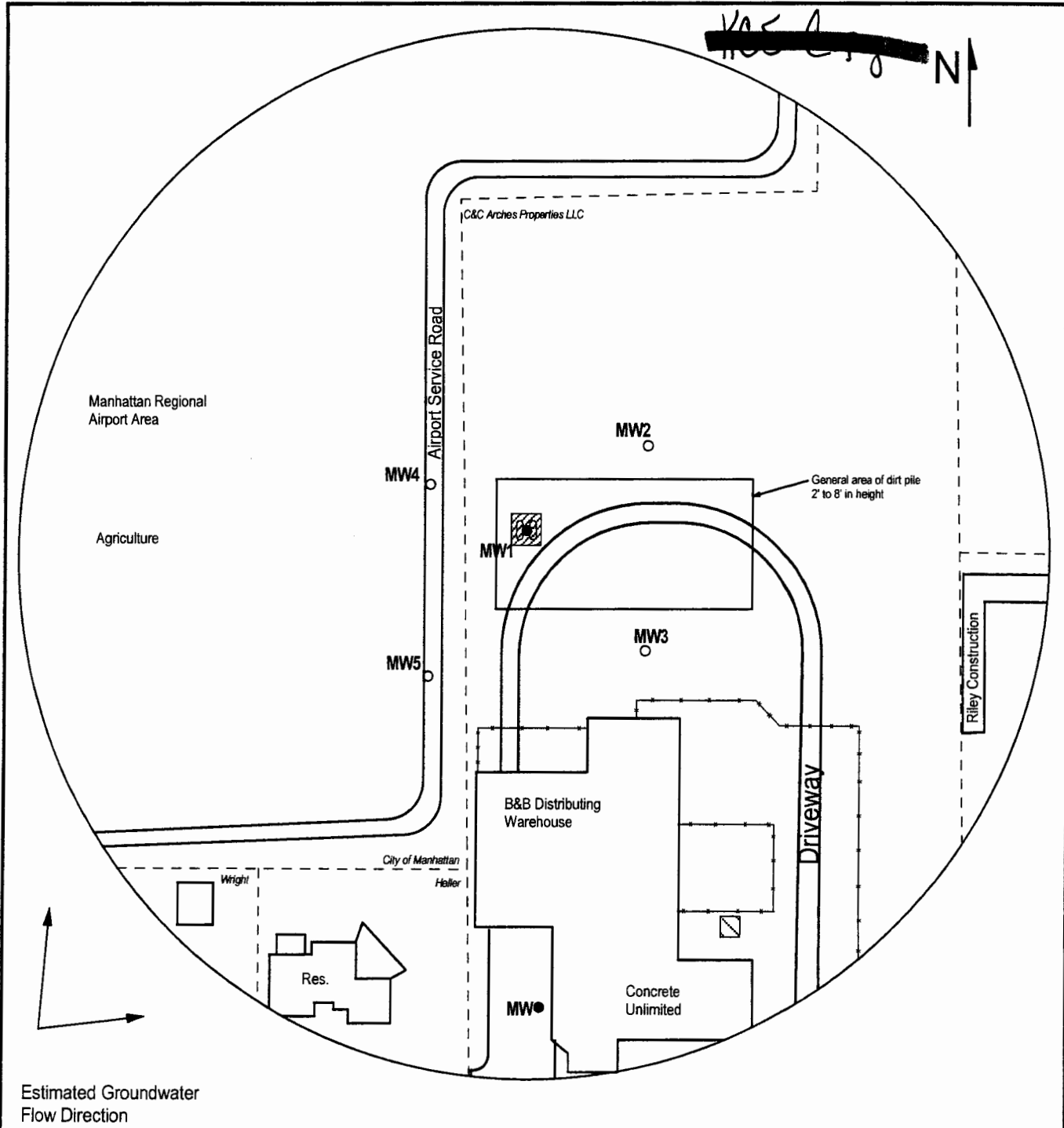

Estimated Groundwater Flow Direction

FIGURE 1 - 350 FT RADIUS AREA BASE MAP

LEGEND:

- Approximate Location of Former UST Basin and Pump Island
- Approximate Location of Former Waste Oil Tank
- Approximate Location of Property Line
- Monitoring Well
- Plugged Monitoring Well



PROJECT:
 B&B Distributing, Inc.
 5106 Murray Rd.
 Manhattan, KS
 KDHE ID: U5-081-00476
 Date: 9/3/14

1311 E 25th St., Suite B (785) 841-8707 office
 Lawrence, KS 66046 (785) 865-4282 fax

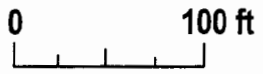

NOTE: Well MW1 was unable to be located under a pile of soil.
 NOTE: Location of product lines is unknown.

County: Riley Fraction NW NW NW Sec. 33 T 10 S R 7 (E)W

CORRECTION(S) TO WATER WELL COMPLETION RECORD (WWC-5)
(to rectify lacking or incorrect information)

Owner: KDHE

Location was listed as:	Location changed to:
Section-Township-Range: <u>33-10S-10E</u>	<u>33-10S-7E</u>
Fraction (1/4 1/4 1/4): <u>NW NW NW</u>	<u>NW NW NW</u>

Other changes: Initial statements: _____

Changed to: _____

Comments: _____

Verification method: well site address, area road map, other monitoring well records for same owner at same location, and mapping tool & aerial photos on KGS website. initials: DRJ date: 12/18/2014

Submitted by: Kansas Geological Survey, Data Resources Library, 1930 Constant Ave., Lawrence, KS 66047-3726
to: Kansas Dept of Health & Environment, Bureau of Water, 1000 SW Jackson, Suite 420, Topeka, KS 66612-1367.