

WATER WELL RECORD Form WWC-5

Division of Water Resources App. No.

Well ID **MW-26R**

Original Record Correction Change in Well Use

1 LOCATION OF WATER WELL:
 County: Riley Fraction NE 1/4 NE 1/4 SE 1/4 SE 1/4 Section Number 1 Township Number T 10 S Range Number R 7 E E W

2 WELL OWNER: Last Name: Kansas State University First:
 Business: Kansas State University Street or Rural Address where well is located (if unknown, distance and direction from nearest town or intersection): If at owner's address, check here:
 Address: 1604 Roof Drive Approximately 1000 ft. NW of intersection of Kimball Ave & Denison Ave, Manhattan, KS
 City: Manhattan State: KS ZIP: 66502

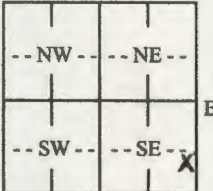
3 LOCATE WELL WITH "X" IN SECTION BOX:
 N

 W E
 S
 [----- 1 mile -----]

4 DEPTH OF COMPLETED WELL: 26.8 ft.
 Depth(s) Groundwater Encountered: 1) 23.0 ft.
 2) ft. 3) ft., or 4) Dry Well
 WELL'S STATIC WATER LEVEL: ft.
 below land surface, measured on (mo-day-yr).....
 above land surface, measured on (mo-day-yr).....
 Pump test data: Well water was ft. after..... hours pumping gpm
 Well water was ft. after..... hours pumping gpm
 Estimated Yield: gpm
 Bore Hole Diameter: 8.75 in. to 26.8 ft. and in. to ft.

5 Latitude: 39.206166 (decimal degrees)
Longitude: -96.589444 (decimal degrees)
 Horizontal Datum: WGS 84 NAD 83 NAD 27
 Source for Latitude/Longitude:
 GPS (unit make/model:) (WAAS enabled? Yes No)
 Land Survey Topographic Map
 Online Mapper: Google Earth

6 Elevation: NA ft. Ground Level TOC
 Source: Land Survey GPS Topographic Map
 Other

7 WELL WATER TO BE USED AS:

1. Domestic: <input type="checkbox"/> Household <input type="checkbox"/> Lawn & Garden <input type="checkbox"/> Livestock	2. <input type="checkbox"/> Irrigation	3. <input type="checkbox"/> Feedlot	4. <input type="checkbox"/> Industrial	5. <input type="checkbox"/> Public Water Supply: well ID <u> </u>	6. <input type="checkbox"/> Dewatering: how many wells? <u> </u>	7. <input type="checkbox"/> Aquifer Recharge: well ID <u> </u>	8. <input checked="" type="checkbox"/> Monitoring: well ID <u>MW-26R</u>	9. Environmental Remediation: well ID <u> </u> <input type="checkbox"/> Air Sparge <input type="checkbox"/> Soil Vapor Extraction <input type="checkbox"/> Recovery <input type="checkbox"/> Injection	10. <input type="checkbox"/> Oil Field Water Supply: lease <u> </u>	11. Test Hole: well ID <u> </u> <input type="checkbox"/> Cased <input type="checkbox"/> Uncased <input type="checkbox"/> Geotechnical	12. Geothermal: how many bores? <u> </u> a) Closed Loop <input type="checkbox"/> Horizontal <input type="checkbox"/> Vertical b) Open Loop <input type="checkbox"/> Surface Discharge <input type="checkbox"/> Inj. of Water	13. <input type="checkbox"/> Other (specify): <u> </u>
--	--	-------------------------------------	--	---	--	--	--	--	---	--	--	--

Was a chemical/bacteriological sample submitted to KDHE? Yes No If yes, date sample was submitted:
 Water well disinfected? Yes No

8 TYPE OF CASING USED: Steel PVC Other CASING JOINTS: Glued Clamped Welded Threaded
 Casing diameter 2 in. to 16.8 ft., Diameter in. to ft., Diameter in. to ft.
 Casing height above land surface 0 in. Weight lbs./ft. Wall thickness or gauge No. sch 40

TYPE OF SCREEN OR PERFORATION MATERIAL:
 Steel Stainless Steel Fiberglass PVC Other (Specify)
 Brass Galvanized Steel Concrete tile None used (open hole)

SCREEN OR PERFORATION OPENINGS ARE:
 Continuous Slot Mill Slot Gauze Wrapped Torch Cut Drilled Holes Other (Specify)
 Louvered Shutter Key Punched Wire Wrapped Saw Cut None (Open Hole)

SCREEN-PERFORATED INTERVALS: From 16.8 ft. to 26.8 ft., From ft. to ft., From ft. to ft.
 GRAVEL PACK INTERVALS: From 13 ft. to 26.8 ft., From ft. to ft., From ft. to ft.

9 GROUT MATERIAL: Neat cement Cement grout Bentonite Other cement pad
 Grout Intervals: From 1 ft. to 13 ft., From 0 ft. to 1 ft., From ft. to ft.

Nearest source of possible contamination:
 Septic Tank Lateral Lines Pit Privy Livestock Pens Insecticide Storage
 Sewer Lines Cess Pool Sewage Lagoon Fuel Storage Abandoned Water Well
 Watertight Sewer Lines Seepage Pit Feedyard Fertilizer Storage Oil Well/Gas Well
 Other (Specify)
 Direction from well? SW Distance from well? 75 ft.

10 FROM	TO	LITHOLOGIC LOG	FROM	TO	LITHO. LOG (cont.) or PLUGGING INTERVALS
0	5	Clay, black, soft, moist			
5	8	Clay, black, with gravel			
8	13	Silty Clay, gray, trace sand and gravel			
13	20	Clay, green gray, iron staining, stiff, sandy			
20	25	Sand, brown, coarse, with cobbles, wet			
25	26.8	Weathered Limestone, gray			

Notes:

11 CONTRACTOR'S OR LANDOWNER'S CERTIFICATION: This water well was constructed, reconstructed, or plugged under my jurisdiction and was completed on (mo-day-year) 11-4-2022 and this record is true to the best of my knowledge and belief. Kansas Water Well Contractor's License No. 604 This Water Well Record was completed on (mo-day-year) 11-7-22 under the business name of Environmental Priority Service, Inc. Signature PA [Signature]

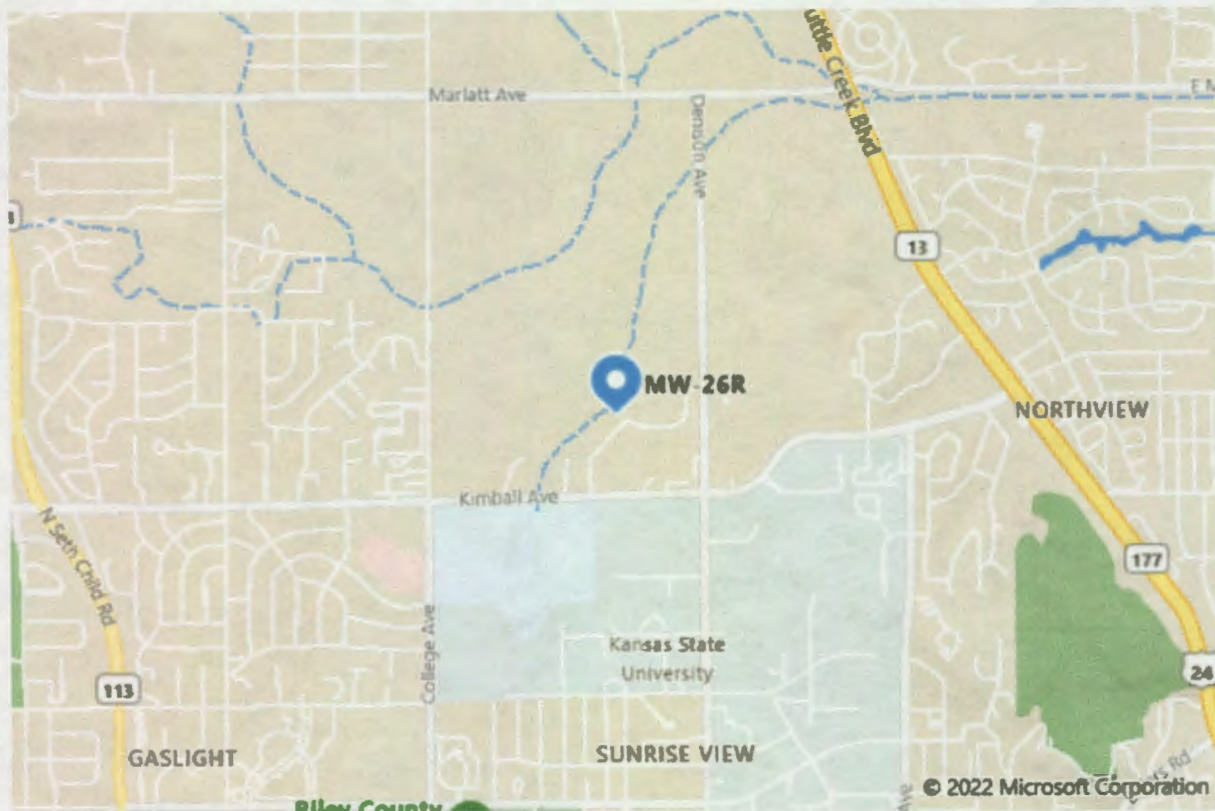

© 2022 Microsoft Corporation, © 2022 TomTom

MW-26R

1980 Kimball Ave, Manhattan, KS 66502, United States