

WATER WELL RECORD Form WWC-5

Division of Water Resources App. No.

Well ID MW16

Original Record Correction Change in Well Use

1 LOCATION OF WATER WELL: County: RILEY Fraction NW 1/4 NE 1/4 SW 1/4 Section Number 18 Township Number T 10 S Range Number R 8 E W

2 WELL OWNER: Last Name: Business: RVR PROPERTY, LLC Address: 1020 POYNTZ AVENUE City: MANHATTAN State: KS ZIP: 66502 Street or Rural Address where well is located SW CORNER OF PROPERTY AT 1018 HUMBOLDT ST.

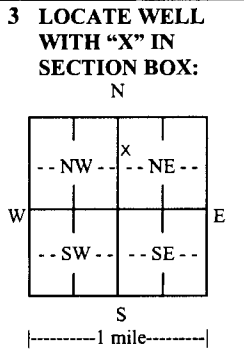

3 LOCATE WELL WITH 'X' IN SECTION BOX: 4 DEPTH OF COMPLETED WELL: 30 ft. Depth(s) Groundwater Encountered: 1) 25 ft. 2) 24.43 ft. WELL'S STATIC WATER LEVEL: 24.43 ft. below land surface, measured on (mo-day-yr) 7/18/16.

5 Latitude: 39.18059 Longitude: 96.57255 Horizontal Datum: WGS 84 NAD 83 NAD 27 Source for Latitude/Longitude: Land Survey Topographic Map Online Mapper. 6 Elevation: 1019.74 ft. Ground Level TOC Source: Land Survey GPS Topographic Map Other

7 WELL WATER TO BE USED AS: 1. Domestic: Household Lawn & Garden Livestock Irrigation Feedlot Industrial 2. Public Water Supply: well ID 3. Dewatering: how many wells? 4. Aquifer Recharge: well ID 5. Monitoring: well ID MW16 6. Environmental Remediation: well ID Air Sparge Soil Vapor Extraction Recovery Injection 7. Oil Field Water Supply: lease 8. Test Hole: well ID Cased Uncased Geotechnical 9. Geothermal: how many bores? a) Closed Loop Horizontal Vertical b) Open Loop Surface Discharge Inj. of Water 10. Other (specify):

Was a chemical/bacteriological sample submitted to KDHE? Yes No If yes, date sample was submitted: Water well disinfected? Yes No

8 TYPE OF CASING USED: Steel PVC Other CASING JOINTS: Glued Clamped Welded Threaded Casing diameter 2 in. to 30 ft. Diameter in. to ft. Diameter in. to ft. Casing height above land surface in. Weight lbs./ft. Wall thickness or gauge No. SCH 40 TYPE OF SCREEN OR PERFORATION MATERIAL: Steel Stainless Steel Fiberglass PVC Brass Galvanized Steel Concrete tile None used (open hole) Other (Specify) SCREEN OR PERFORATION OPENINGS ARE: Continuous Slot Mill Slot Gauze Wrapped Torch Cut Drilled Holes Other (Specify) Louvered Shutter Key Punched Wire Wrapped Saw Cut None (Open Hole) SCREEN-PERFORATED INTERVALS: From 20 ft. to 30 ft. From ft. to ft. From ft. to ft. GRAVEL PACK INTERVALS: From 18 ft. to 30 ft. From ft. to ft. From ft. to ft.

9 GROUT MATERIAL: Neat cement Cement grout Bentonite Other Grout Intervals: From 0.5 ft. to 16 ft. From 16 ft. to 18 ft. From ft. to ft. Nearest source of possible contamination: Septic Tank Lateral Lines Pit Privy Livestock Pens Insecticide Storage Sewer Lines Cess Pool Sewage Lagoon Fuel Storage Abandoned Water Well Watertight Sewer Lines Seepage Pit Feedyard Fertilizer Storage Oil Well/Gas Well Other (Specify) Direction from well? Distance from well? ft.

Table with columns: 10 FROM, TO, LITHOLOGIC LOG, FROM, TO, LITHO. LOG (cont.) or PLUGGING INTERVALS. Rows: 0-1 TOPSOIL, 1-30 SILTY CLAY. Includes a Notes section.

11 CONTRACTOR'S OR LANDOWNER'S CERTIFICATION: This water well was constructed, reconstructed, or plugged under my jurisdiction and was completed on (mo-day-year) and this record is true to the best of my knowledge and belief. Kansas Water Well Contractor's License No. 585. This Water Well Record was completed on day month year 8/1/16 under the business name of ASSOCIATED ENVIRONMENTAL INC. Signature

Mail 1 white copy along with a fee of \$5.00 for each constructed well to: Kansas Department of Health and Environment, Bureau of Water, GWTS Section, 1000 SW Jackson St., Suite 420, Topeka, Kansas 66612-1367. Mail one to Water Well Owner and retain one for your records. Telephone 785-296-5524. Visit us at http://www.kdheks.gov/waterwell/index.html KSA 82a-1212 Revised 7/10/2015

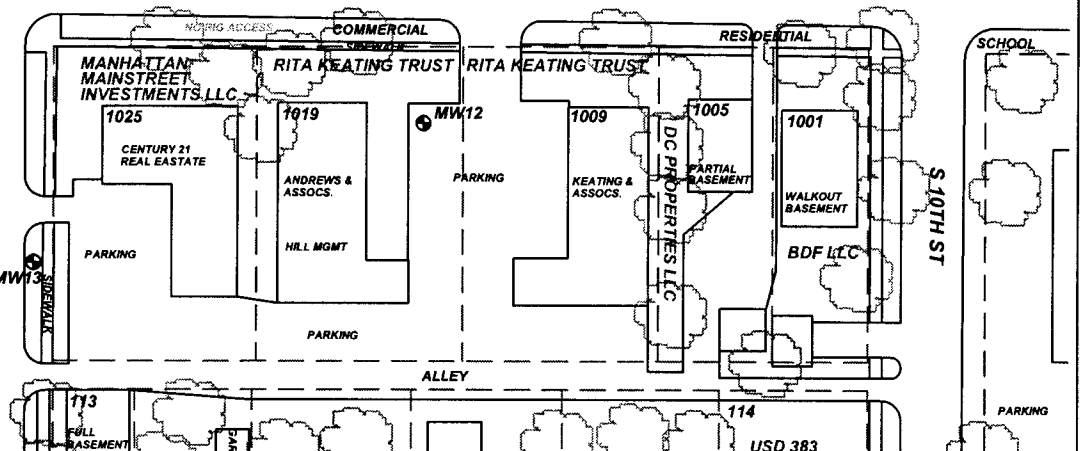
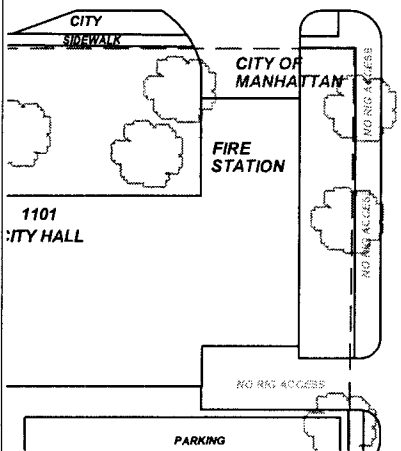
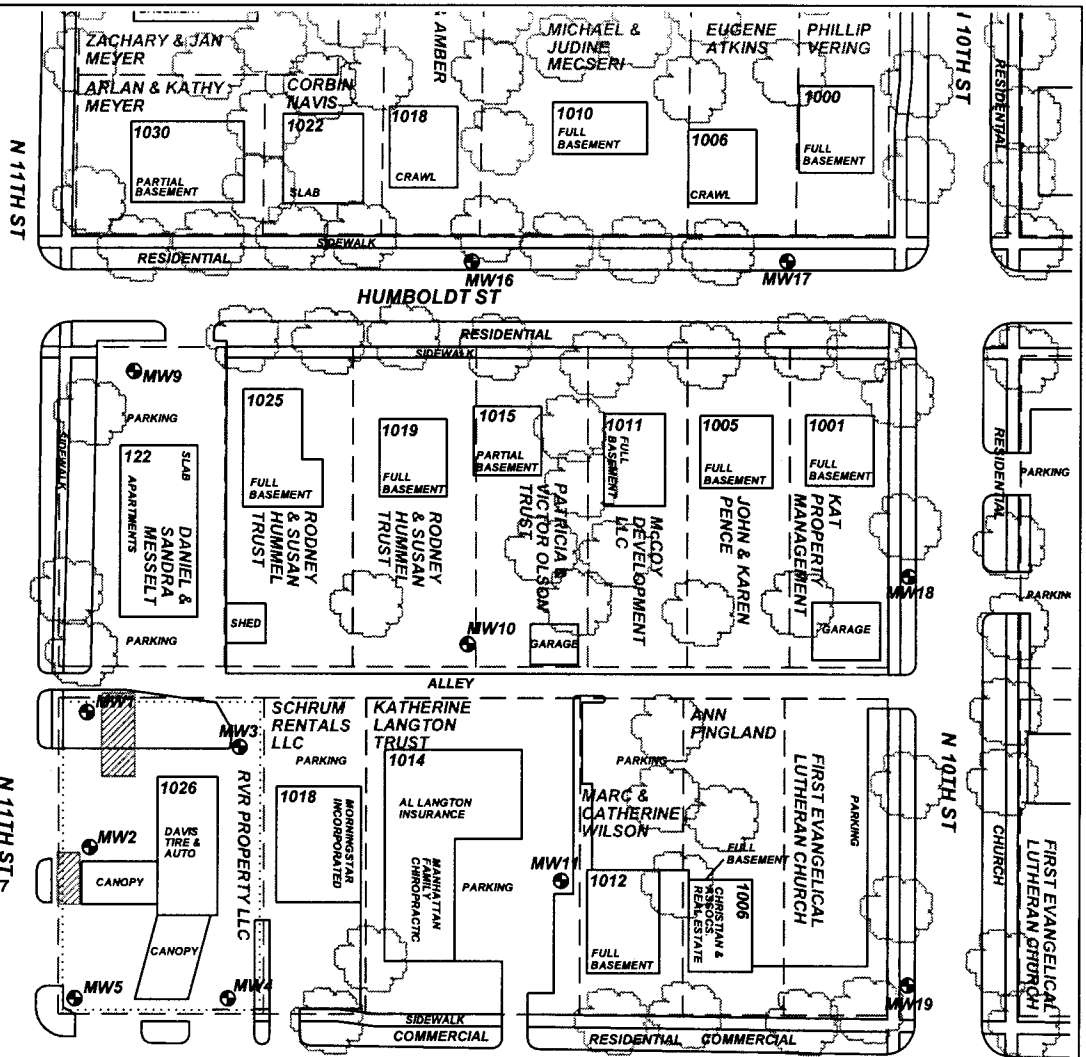
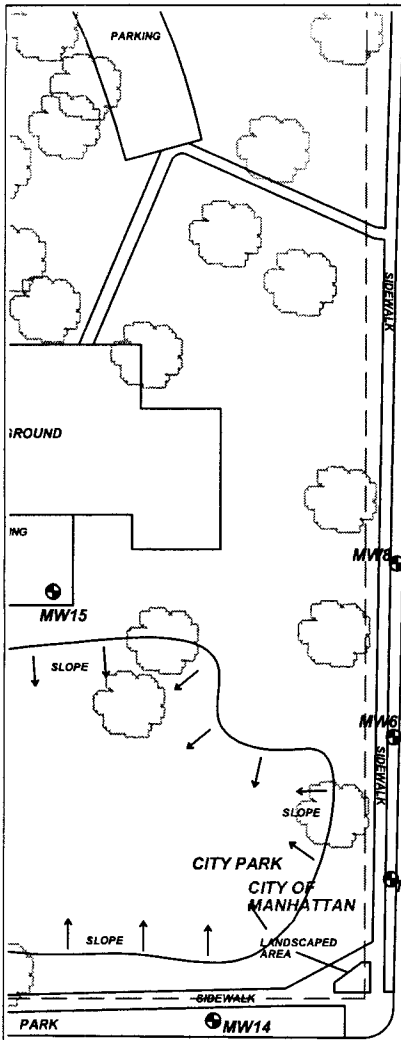

**PROJECT:** DAVIS TIRE & AUTO  
**ADDRESS:** 1026 POYNTZ AVENUE  
**LOCATION:** MANHATTAN, KS  
**DRAWN BY:** C. ROE **DATE:** 6/12/15  
**REVISED BY:** C. ROE **DATE:** 8/1/16  
**AEI JOB #:** TF485 **KDHE JOB #:** U5-081-14689

**TITLE:** Figure 2.1  
**Site Map**  
**350' Radius**  
**ASSOCIATED ENVIRONMENTAL INC.**

**LEGEND:**  
 = Excavation Zone  
 = Monitor Well  
 = Site Property Boundary  
 = Parcel Boundary Lines

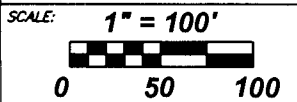

**NOTES:**