

WATER WELL RECORD Form WWC-5

Division of Water Resources App. No.

[Blank Box]

Well ID

MW19

Original Record Correction Change in Well Use

1 LOCATION OF WATER WELL: County: RILEY Fraction SE 1/4 NE 1/4 NW 1/4 SW 1/4 Section Number 18 Township Number T 10 S Range Number R 8 E W

2 WELL OWNER: Last Name: RVR PROPERTY, LLC Address: 1020 POYNTZ AVENUE City: MANHATTAN State: KS ZIP: 66502 Street or Rural Address where well is located: N. OF ALLEY AT 1015 HUMBOLDT ST.

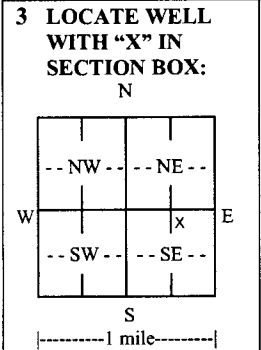

3 LOCATE WELL WITH 'X' IN SECTION BOX: 4 DEPTH OF COMPLETED WELL: 30 ft. Depth(s) Groundwater Encountered: 1) 25 ft. 2) 22.12 ft. 3) 7/18/16. Pump test data: Well water was ... after ... hours pumping ... gpm. Estimated Yield: ... gpm. Bore Hole Diameter: 8.5 in. to 30 ft.

5 Latitude: 39.17968 (decimal degrees) Longitude: 96.57176 (decimal degrees) Horizontal Datum: WGS 84 NAD 83 NAD 27 Source for Latitude/Longitude: GPS (unit make/model: ... (WAAS enabled? Yes No) Land Survey Topographic Map Online Mapper. 6 Elevation: 1017.37 ft. Ground Level TOC Source: Land Survey GPS Topographic Map Other

7 WELL WATER TO BE USED AS: 1. Domestic: Household Lawn & Garden Livestock Irrigation Feedlot Industrial 2. Public Water Supply: well ID 3. Dewatering: how many wells? 4. Aquifer Recharge: well ID 5. Monitoring: well ID MW19 6. Environmental Remediation: well ID Air Sparge Soil Vapor Extraction Recovery Injection 7. Oil Field Water Supply: lease 8. Test Hole: well ID Cased Uncased Geotechnical 9. Geothermal: how many bores? a) Closed Loop Horizontal Vertical b) Open Loop Surface Discharge Inj. of Water 10. Other (specify):

Was a chemical/bacteriological sample submitted to KDHE? Yes No If yes, date sample was submitted: Water well disinfected? Yes No

8 TYPE OF CASING USED: Steel PVC Other CASING JOINTS: Glued Clamped Welded Threaded Casing diameter 2 in. to 30 ft. Diameter in. to ft. Diameter in. to ft. Casing height above land surface in. Weight lbs./ft. Wall thickness or gauge No. SCH 40 TYPE OF SCREEN OR PERFORATION MATERIAL: Steel Stainless Steel Fiberglass PVC Other (Specify) Brass Galvanized Steel Concrete tile None used (open hole) SCREEN OR PERFORATION OPENINGS ARE: Continuous Slot Mill Slot Gauze Wrapped Torch Cut Drilled Holes Other (Specify) Louvered Shutter Key Punched Wire Wrapped Saw Cut None (Open Hole) SCREEN-PERFORATED INTERVALS: From 20 ft. to 30 ft. GRAVEL PACK INTERVALS: From 18 ft. to 30 ft.

9 GROUT MATERIAL: Neat cement Cement grout Bentonite Other Grout Intervals: From 5 ft. to 16 ft. From 16 ft. to 18 ft. Nearest source of possible contamination: Septic Tank Lateral Lines Pit Privy Livestock Pens Insecticide Storage Sewer Lines Cess Pool Sewage Lagoon Fuel Storage Abandoned Water Well Watertight Sewer Lines Seepage Pit Feedyard Fertilizer Storage Oil Well/Gas Well Other (Specify) Direction from well? Distance from well? ft.

Table with 6 columns: 10 FROM, TO, LITHOLOGIC LOG, FROM, TO, LITHO. LOG (cont.) or PLUGGING INTERVALS. Rows: 0-1 TOPSOIL, 1-8 SILTY CLAY, 8-30 SAND CLAY. Includes a Notes section.

11 CONTRACTOR'S OR LANDOWNER'S CERTIFICATION: This water well was constructed, reconstructed, or plugged under my jurisdiction and was completed on (mo-day-year) and this record is true to the best of my knowledge and belief. Kansas Water Well Contractor's License No. 585 This Water Well Record was completed on (mo-day-year) 8/1/16 under the business name of ASSOCIATED ENVIRONMENTAL INC. Signature [Signature] Mail 1 white copy along with a fee of \$5.00 for each constructed well to: Kansas Department of Health and Environment, Bureau of Water, GWTS Section, 1000 SW Jackson St., Suite 420, Topeka, Kansas 66612-1367. Mail one to Water Well Owner and retain one for your records. Telephone 785-296-5524. Visit us at http://www.kdheks.gov/waterwell/index.html KSA 82a-1212 Revised 7/10/2015

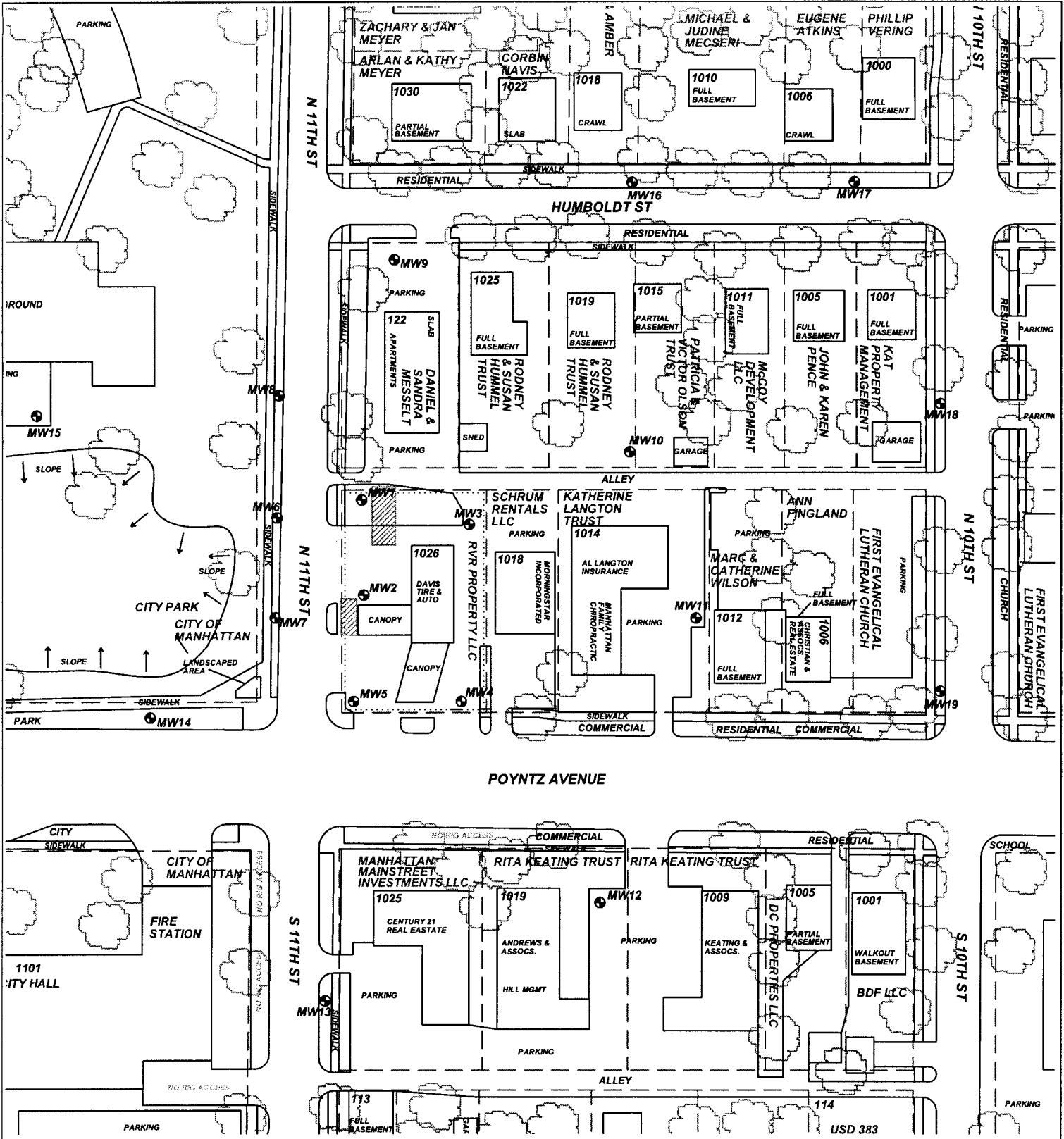

PROJECT: DAVIS TIRE & AUTO

ADDRESS: 1026 POYNTZ AVENUE

LOCATION: MANHATTAN, KS

DRAWN BY: C. ROE **DATE:** 6/12/15

REVISED BY: C. ROE **DATE:** 8/1/16

AEI JOB #: TF485 **KDHE JOB #:** U5-081-14689

SCALE: 1" = 100'

NOTES:

TITLE: Figure 2.1
Site Map
350' Radius

ASSOCIATED ENVIRONMENTAL INC.

LEGEND:

- = Excavation Zone
- = Monitor Well
- = Site Property Boundary
- = Parcel Boundary Lines