

WATER WELL RECORD Form WWC-5

Division of Water Resources App. No.

[]

Well ID MW10

Original Record Correction Change in Well Use

1 LOCATION OF WATER WELL: County: Riley Fraction SW 1/4 SE 1/4 NE 1/4 NW 1/4 Section Number 17 Township Number T 10 S Range Number R 8 E W

2 WELL OWNER: Last Name: Darrah First: Chris Street or Rural Address where well is located: 473 E Poyntz, Manhattan, Kansas

3 LOCATE WELL WITH 'X' IN SECTION BOX: [Diagram] 4 DEPTH OF COMPLETED WELL: 20 ft. Depth(s) Groundwater Encountered: 1) 17 ft. 2) 16.34 ft. WELL'S STATIC WATER LEVEL: 16.34 ft.

5 Latitude: 39.18568 Longitude: 96.54967 Horizontal Datum: WGS 84 NAD 83 NAD 27 Source for Latitude/Longitude: GPS Land Survey Topographic Map Online Mapper 6 Elevation: 1008.26 ft. Ground Level TOC Source: Land Survey GPS Topographic Map Other

7 WELL WATER TO BE USED AS: 1. Domestic: Household Lawn & Garden Livestock Irrigation Feedlot Industrial 5. Public Water Supply: well ID 6. Dewatering: how many wells? 7. Aquifer Recharge: well ID 8. Monitoring: well ID MW10 9. Environmental Remediation: well ID Air Sparge Soil Vapor Extraction Recovery Injection 10. Oil Field Water Supply: lease 11. Test Hole: well ID Cased Uncased Geotechnical 12. Geothermal: how many bores? a) Closed Loop Horizontal Vertical b) Open Loop Surface Discharge Inj. of Water 13. Other (specify):

Was a chemical/bacteriological sample submitted to KDHE? Yes No If yes, date sample was submitted: Water well disinfected? Yes No

8 TYPE OF CASING USED: Steel PVC Other CASING JOINTS: Glued Clamped Welded Threaded Casing diameter 2 in. to 10 ft. Diameter in. to ft. Diameter in. to ft. Casing height above land surface in. Weight lbs./ft. Wall thickness or gauge No. Schedule 40 TYPE OF SCREEN OR PERFORATION MATERIAL: Steel Stainless Steel Fiberglass PVC Brass Galvanized Steel Concrete tile None used (open hole) SCREEN OR PERFORATION OPENINGS ARE: Continuous Slot Mill Slot Gauze Wrapped Torch Cut Drilled Holes Other (Specify) Louvered Shutter Key Punched Wire Wrapped Saw Cut None (Open Hole) SCREEN-PERFORATED INTERVALS: From 10 ft. to 20 ft. From ft. to ft. From ft. to ft. GRAVEL PACK INTERVALS: From 8 ft. to 20 ft. From ft. to ft. From ft. to ft.

9 GROUT MATERIAL: Neat cement Cement grout Bentonite Other Grout Intervals: From 0.5 ft. to 6 ft. From 6 ft. to 8 ft. From ft. to ft. Nearest source of possible contamination: Septic Tank Lateral Lines Pit Privy Livestock Pens Insecticide Storage Sewer Lines Cess Pool Sewage Lagoon Fuel Storage Abandoned Water Well Watertight Sewer Lines Seepage Pit Feedyard Fertilizer Storage Oil Well/Gas Well Other (Specify) Direction from well? Distance from well? ft.

Table with columns: FROM, TO, LITHOLOGIC LOG, FROM, TO, LITHO. LOG (cont.) or PLUGGING INTERVALS. Rows: 0-25 Gravel, landscape bed; 25-7 Silty Clay (CL), dk brown; 7-20 Grades to Sandy Clay (CH) dk brown. Includes Notes section.

11 CONTRACTOR'S OR LANDOWNER'S CERTIFICATION: This water well was constructed, reconstructed, or plugged under my jurisdiction and was completed on (mo-day-year) 7/3/17 and this record is true to the best of my knowledge and belief. Kansas Water Well Contractor's License No. 585. This Water Well Record was completed on (mo-day-year) 7/31/17 under the business name of Associated Environmental, Inc. Signature [Signature] Mail 1 white copy along with a fee of \$5.00 for each constructed well to: Kansas Department of Health and Environment, Bureau of Water, GWTS Section, 1000 SW Jackson St., Suite 420, Topeka, Kansas 66612-1367. Mail one to Water Well Owner and retain one for your records. Telephone 785-296-5524. Visit us at http://www.kdheks.gov/waterwell/index.html KSA 82a-1212 Revised 7/10/2015

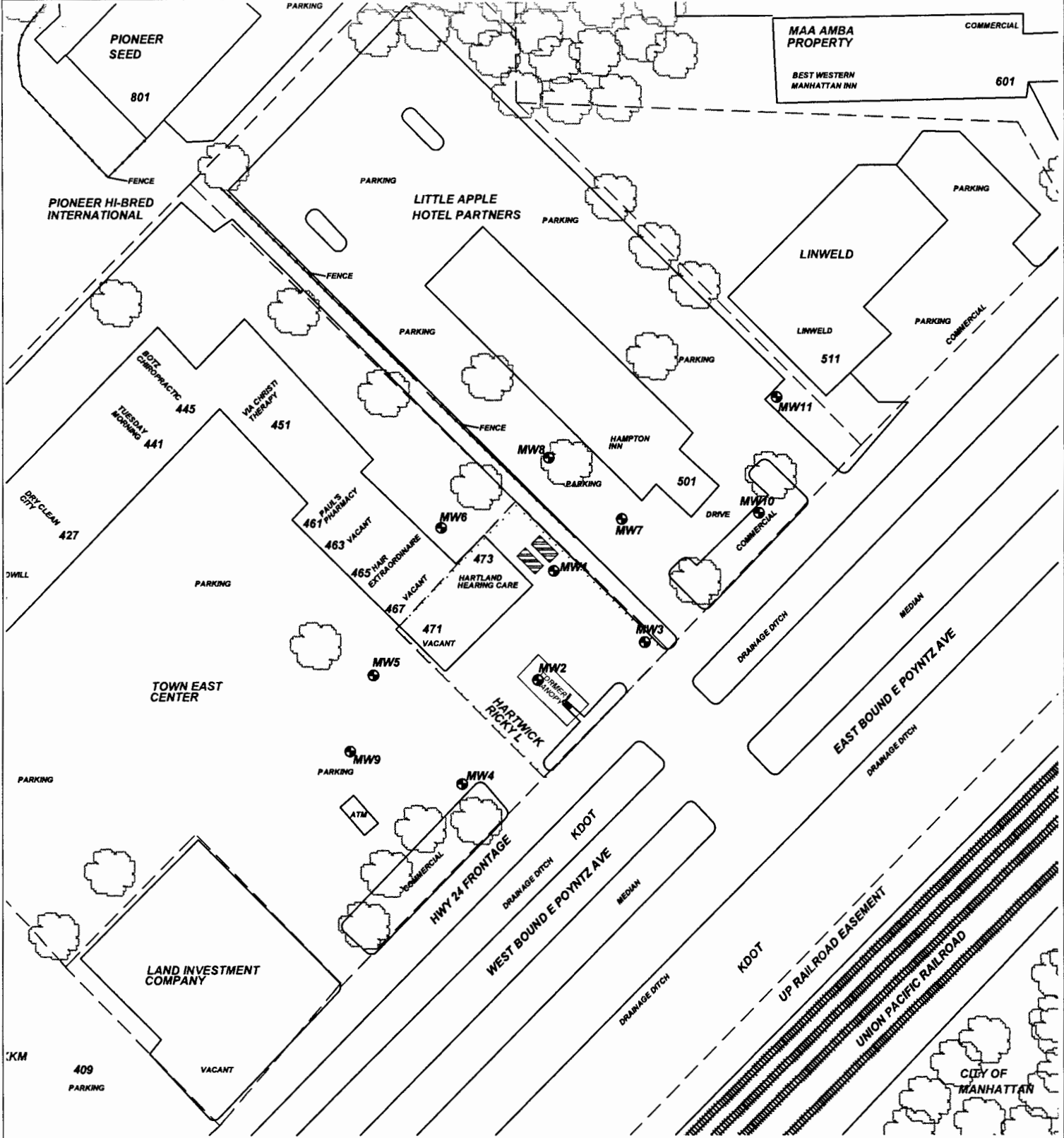

PROJECT: **DARA'S FASTLANE #3**

ADDRESS: **473 EAST POYNTZ**

LOCATION: **MANHATTAN, KS**

DRAWN BY: **B. STALNAKER** DATE: **8/15/16**

REVISED BY: **B. STALNAKER** DATE: **8/7/17**

AEI JOB #: **TF493** KDHE JOB #: **U4-075-14844**

TITLE: **FIGURE 2.1
AREA BASE MAP
350' RADIUS**

**ASSOCIATED
ENVIRONMENTAL
INC.**

- LEGEND:
- = (2) 10,000 G. GASOLINE USTs ABANDONED IN PLACE
 - = FORMER CANOPY & PUMP ISLAND
 - = MONITOR WELL
 - = PARCEL BOUNDARY

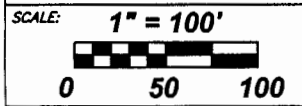

NOTES:
No basements observed within 500'.