

WATER WELL RECORD Form WWC-5

Division of Water Resources App. No.

MW10

Original Record Correction Change in Well Use

Well ID

1 LOCATION OF WATER WELL: County: RILEY Fraction SE 1/4 SE 1/4 SE 1/4 SW 1/4 Section Number 6 Township Number T 10 S Range Number R 8 E W

2 WELL OWNER: Last Name: Business: LEISZLER REAL ESTATE LLC Address: 2010 N. TUTTLE CREEK BLVD City: MANHATTAN State: KS ZIP: 67005 Street or Rural Address where well is located

3 LOCATE WELL WITH 'X' IN SECTION BOX: N W E S 4 DEPTH OF COMPLETED WELL: 20 ft. 5 Latitude: 39.20428 Longitude: 96.56716 6 Elevation: 1042.29 ft.

7 WELL WATER TO BE USED AS: 1. Domestic: 2. Irrigation 3. Feedlot 4. Industrial 5. Public Water Supply 6. Dewatering 7. Aquifer Recharge 8. Monitoring 9. Environmental Remediation 10. Oil Field Water Supply 11. Test Hole 12. Geothermal 13. Other

Was a chemical/bacteriological sample submitted to KDHE? Water well disinfected?

8 TYPE OF CASING USED: 2 in. to 20 ft. CASING JOINTS: Threaded TYPE OF SCREEN OR PERFORATION MATERIAL: PVC SCREEN OR PERFORATION OPENINGS ARE: Mill Slot SCREEN-PERFORATED INTERVALS: 10 ft. to 20 ft. GRAVEL PACK INTERVALS: 8 ft. to 20 ft.

9 GROUT MATERIAL: Neat cement Cement grout Bentonite Other Concrete Surface Completion 0-1 Grout Intervals: 1 ft. to 6 ft. Nearest source of possible contamination: SOUTH Direction from well? 120 ft.

Table with 6 columns: 10 FROM, TO, LITHOLOGIC LOG, FROM, TO, LITHO. LOG (cont.) or PLUGGING INTERVALS. Rows include CONCRETE and SILTY CLAY.

11 CONTRACTOR'S OR LANDOWNER'S CERTIFICATION: This water well was constructed, reconstructed, or plugged under my jurisdiction and was completed on (mo-day-year) 11/21/19 and this record is true to the best of my knowledge and belief.

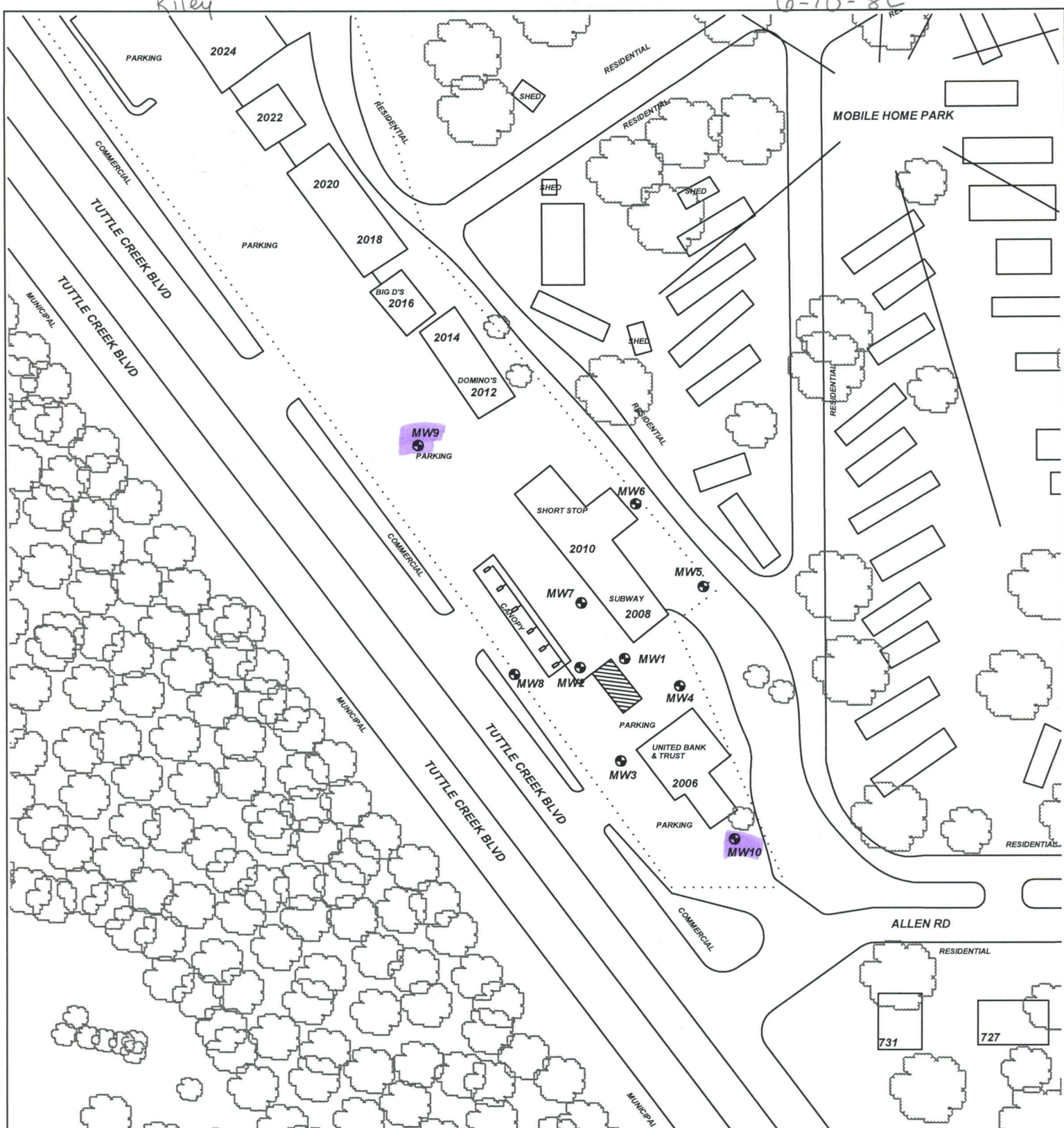

PROJECT: **SHORT STOP #12**

ADDRESS: **2010 N TUTTLE CREEK BLVD**

LOCATION: **MANHATTAN, KS**

DRAWN BY: **B. STALNAKER** DATE: **2/27/19**

REVISED BY: **B. STALNAKER** DATE: **11/21/19**

AEI JOB #: **TF518** KDHE JOB #: **U5-081-15128**

TITLE: **FIGURE 2.1
AREA BASE MAP
350' RADIUS**

AEI ASSOCIATED ENVIRONMENTAL INC.

LEGEND:

- = EXISTING BASIN, PRODUCT LINES AND PUMP ISLANDS
- = MONITORING WELL
- = SUBJECT PROPERTY

SCALE: **1" = 100'**

NOTES:
No basements observed within 500'.