

WATER WELL RECORD

Form WWC-5

Division of Water Resources App. No.

Well ID

MW4R

Original Record Correction Change in Well Use

1 LOCATION OF WATER WELL: County Riley Fraction SW 1/4 SE 1/4 NE 1/4 Section Number 18 Township Number T 10 S Range Number 8 E

2 WELL OWNER: Last Name: Business: KDHE (Goetsch-Irvine Motors Co., Inc.) Address: 1000 SW Jackson City Topeka State: KS ZIP: 66612 Street or Rural Address where well is located (if unknown, distance and direction from nearest town or intersection): ~465' E-NE of 4th & Leavenworth, Manhattan, KS

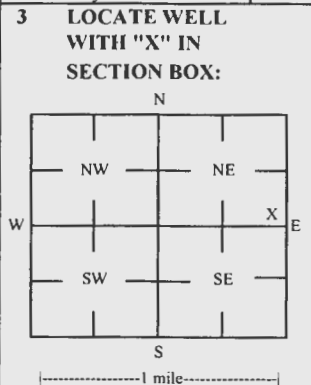

4 DEPTH OF COMPLETED WELL: 30 ft Depth(s) Groundwater Encountered: 1) 30 ft 2) ft 3) ft or 4) Dry Well WELL'S STATIC WATER LEVEL: 18.20 ft below land surface, measured on (mo-day-yr) 8/18/22

5 Latitude: 39.18163 (decimal degrees) Longitude: 96.56026 (decimal degrees) Horizontal Datum: X WGS 84 Source for Latitude/Longitude: X Land Survey

6 Elevation 1010.88 ft Ground Level X TOC Source X Land Survey GPS Topographic Map

7 WELL WATER TO BE USED AS: 1 Domestic: Household, Lawn & Garden, Livestock, Irrigation, Feedlot, Industrial 5 Public Water Supply: well ID 6 Dewatering: how many wells? 7 Aquifer Recharge: well ID 8 X Monitoring: well ID MW4R 9 Environmental Remediation: well ID 10 Oil Field Water Supply: lease 11 Test Hole: well ID 12 Geothermal: How many bores?

Was a chemical/bacteriological sample submitted to KDHE? Water well disinfected? Yes No If yes, date sample was submitted:

8 TYPE OF CASING USED: Steel PVC Other CASING JOINTS: Glued Clamped Welded X Threaded Casing diameter 2 in. to 15 ft. Diameter in. to ft. Casing height above land surface -0.43 in. Weight lbs./ft. Well thickness or gauge No

9 GROUT MATERIAL: Neat cement Cement grout X Bentonite X Other Concrete: 0-0.5' Grout intervals: From 0.5 ft. to 13 ft. From ft. to ft. From ft. to ft.

Nearest source of possible contamination: Septic Tank Lateral Lines Pit Privy Livestock Pens Insecticide Storage Sewer Lines Cess Pool Sewage Lagoon Fuel Storage Abandoned Water Well Watertight Sewer Lines Seepage Pit Feedyard Fertilizer Storage Oil Well / Gas Well

Table with columns: 10 FROM, TO, LITHOLOGIC LOG, FROM, TO, LITHO. LOG (cont.) or PLUGGING INTERVALS. Rows: 0-0.5 Topsoil, clay; 0.5-14 Silt; 14-30 Sand

KDHE ID: Goetsch-Irvine Motors Co., Inc.; U5-081-00208 Target of monitoring well is shallow groundwater, <20' of grout was installed at the direction of KDHE.

11 CONTRACTOR'S OR LANDOWNER'S CERTIFICATION: This water well was X constructed, reconstructed or plugged under my jurisdiction and was completed on (mo-day-yr) 8/9/22 and this record is true to the best of my knowledge and belief. Kansas Water Well Contractor's License No 757 This Water Well Record was completed on (mo-day-yr) 9/7/22 under the business name of Larsen & Associates, Inc. Signature

Mail 1 white copy along with a fee of \$5.00 for each constructed well to: Kansas Department of Health and Environment, Bureau of Water, GW Section, 1000 SW Jackson St., Suite 420, Topeka, Kansas 66612-1367. Mail one to Water Well Owner and retain one for your records. Telephone 785-296-5524.

NOTE: Figures exhibited within this report are only to be used within the context of this report. Placement of property lines, wells, structures, and roads is based on the available information from county appraiser maps, surveys, site visits, and/or previous vendor reports and should be considered approximate.

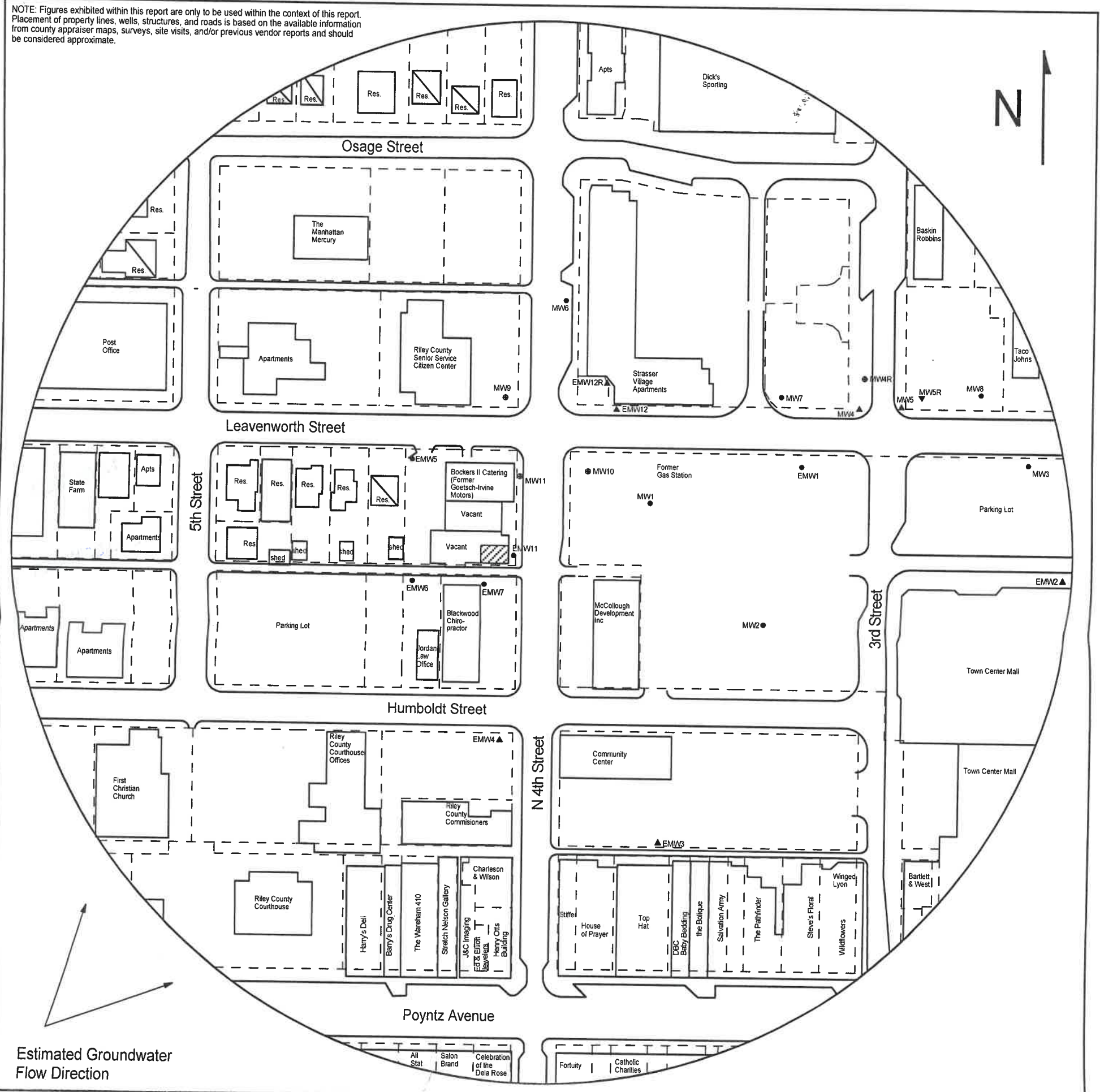

FIGURE 1 - 700 FT RADIUS AREA BASE MAP

- LEGEND**
- Approximate Location of Former UST Basin
 - Building with Basement
 - Approximate Location of Property Line
 - Existing Monitoring Well
 - Plugged Well
 - Destroyed Well
 - New Monitoring Well



PROJECT:
 Goetsch-Irvine Motors Co., Inc.
 4th & Leavenworth
 Manhattan, KS
 KDHE ID: U5-081-00208
 Date: 8/9-10/22



1311 E 25th St., Suite B 785-841-8707 office
 Lawrence, KS 66046 785-865-4282 fax

T108-R8E-Sec-18
Riley KSA 82a-1212

DENNIS L HANDKE

1820 NW 59th Terrace
TOPEKA, KANSAS 66618
785-286-4047 Home

Jess Chapman
Larsen & Associates
1311 E. 25th Street, Suite B
Lawrence, Kansas, 66046

September 1, 2022

RE: Monitor Well Elevation Survey
4th & Leavenworth, Manhattan, Kansas

Proj. 22-00SS
Geotech-Irving Motors Co., Inc.
U5-081-00208

Bench Mark: Chiseld "X" on North bolt on top of fire hydrant on the NE Corner of 4th & Leavenworth.
Elev: 1014.87 North 2680.05 West 1284.70 (from SE Cor. Sec. 18-10-08E)

MW-4R	rim	1011.31	North	2718.75	SW1/4,SE1/4,SE1/4,NE1/4
	top pipe	1010.88	West	888.43	Lat = 39.18163 Long = 96.56026
MW-9	rim	1013.73	North	2693.78	SE1/4,SE1/4,SW1/4,NE1/4
	top pipe	1013.32	West	1367.11	Lat = 39.18163 Long = 96.56195
MW-10	rim	1013.22	North	2584.67	NW1/4,NW1/4,NE1/4,SE1/4
	top pipe	1012.80	West	1243.67	Lat = 39.18131 Long = 96.56153
MW-11	rim	1012.80	North	2587.27	NE1/4,NE1/4,NW1/4,SE1/4
	top pipe	1012.45	West	1336.11	Lat = 39.18133 Long = 96.56186

Lat & Long derived from Manhattan 7.5 quad map. WGS84

Elevation established from existing project. NAVD 88

If you have any questions, please feel free to call me. Thank you for the opportunity to be

