

**WATER WELL PLUGGING RECORD Form WWC-5P**

**KSA 82a-1212**

**ID NO.**

**Well #7**

<b>1 LOCATION OF WATER WELL:</b> County: <u>Riley</u>	Fraction <u>¼ SW ¼ NW ¼ SE ¼</u>	Section Number <u>16</u>	Township Number <u>T 10 S</u>	Range Number <u>8</u> <input checked="" type="checkbox"/> E <input type="checkbox"/> W
--	-------------------------------------	-----------------------------	----------------------------------	---

Street/Rural Address of Well Location; if unknown, distance & direction from nearest town or intersection: If at owner's address, check here  City of Manhattan's Biosolids Farm  
520 Harwood Road  
Manhattan KS, 66502

**Global Positioning Systems (GPS) information:**  
Latitude: 39.178378 (in decimal degrees)  
Longitude: -96.528640 (in decimal degrees)  
Elevation: 997'  
Horizontal Datum:  WGS84,  NAD83,  NAD27  
Collection Method:

**2 WATER WELL OWNER:** City of Manhattan, PW Dept.  
RR#, St. Address, Box #: 1101 Poyntz Avenue  
City, State ZIP Code: Manhattan Kansas 66502

GPS unit (Make/Model: \_\_\_\_\_)  
 Digital Map/Photo,  Topographic Map,  Land Survey  
Est. Accuracy:  < 3 m,  3-5 m,  5-15 m,  > 15 m

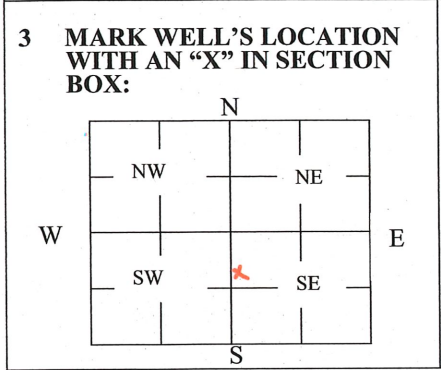

**4 DEPTH OF WELL** 30 ft.  
WELL'S STATIC WATER LEVEL Dry ft.  
WELL WAS USED AS:  
 Domestic  Public Water Supply  Dewatering  
 Irrigation  Oil Field Water Supply  Monitoring  
 Feedlot  Domestic (Lawn & Garden)  Injection Well  
 Industrial  Air Conditioning  Other \_\_\_\_\_  
Was a chemical/bacteriological sample submitted to Department? Yes  No

**5 TYPE OF BLANK CASING USED:**  
 Steel  RMP (SR)  Wrought  Fiberglass  Other (Specify below)  
 PVC  ABS  Asbestos-Cement  Concrete Tile \_\_\_\_\_

Blank casing diameter 5 in. Was casing pulled? Yes  No  If yes, how much 4'  
Casing height above or below land surface 48 in.

**6 GROUT PLUG MATERIAL:**  Neat cement  Cement grout  Bentonite  Other Rockite Cement

Grout Plug Intervals: From \_\_\_\_\_ ft. to \_\_\_\_\_ ft., From 30 ft. to 1 ft., From 1 ft. to 0 ft.

What is the nearest source of possible contamination:  
 Septic tank  Seepage pit  Fuel storage  Other (specify below)  
 Sewer lines  Pit privy  Fertilizer storage  
 Watertight sewer lines  Sewage lagoon  Insecticide storage  
 Lateral lines  Feedyard  Abandoned water well Direction from well? SE  
 Cess pool  Livestock pens  Oil well/Gas well How many feet? 192

FROM	TO	PLUGGING MATERIALS	FROM	TO	PLUGGING MATERIALS
0'	1'	Rockite Cement			
1'	30'	Bentonite Chips			
					Well # 7 is 5 ft From -
					Well # 6 BA

**7 CONTRACTOR'S OR LANDOWNER'S CERTIFICATION:** This water well was plugged under my jurisdiction and was completed on (mo/day/year) 10/10/2023 and this record is true to the best of my knowledge and belief. Kansas Water Well Contractor's License No. \_\_\_\_\_ This Water Well Record was completed on (mo/day/year) 10/16/2023 under the business name of City of Manhattan, Public Works Department by (signature) Daniel Tidwell

Send one white copy to Kansas Department of Health & Environment, Geology Section, 1000 SW Jackson Street, Ste. 420, Topeka, KS 66612-1367. Send one copy to WATER WELL OWNER and retain one for your records.  
Visit us at <http://www.kdheks.gov/waterwell/index.html> Telephone 785-296-5524.