

**WATER WELL PLUGGING RECORD Form WWC-5P KSA 82a-1212 ID NO.**

Well #8

<b>1 LOCATION OF WATER WELL:</b> County: <u>Riley</u>	Fraction <u>¼ NW ¼ SE ¼ NW ¼</u>	Section Number <u>22</u>	Township Number <u>T 10 S</u>	Range Number <u>8</u> <input checked="" type="checkbox"/> E <input type="checkbox"/> W
--	-------------------------------------	-----------------------------	----------------------------------	---

Street/Rural Address of Well Location; if unknown, distance & direction from nearest town or intersection: If at owner's address, check here  City of Manhattan's Biosolids Farm  
160 Moore's Lane  
Manhattan Kansas, 66502

**Global Positioning Systems (GPS) information:**  
 Latitude: 39.168916 (in decimal degrees)  
 Longitude: -96.514402 (in decimal degrees)  
 Elevation: \_\_\_\_\_  
 Horizontal Datum:  WGS84,  NAD83,  NAD27  
 Collection Method: \_\_\_\_\_

**2 WATER WELL OWNER:** City of Manhattan, PW Dept.  
RR#, St. Address, Box #: 1101 Poyntz Avenue  
City, State ZIP Code: Manhattan Kansas, 66502

GPS unit (Make/Model: \_\_\_\_\_)  
 Digital Map/Photo,  Topographic Map,  Land Survey  
 Est. Accuracy:  < 3 m,  3-5 m,  5-15 m,  > 15 m

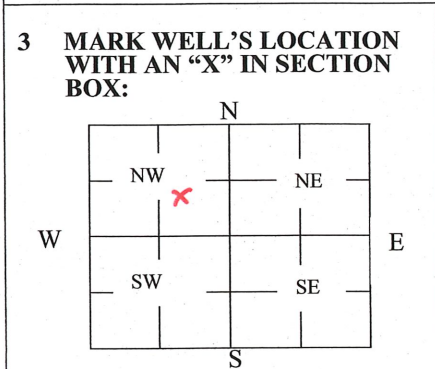

**4 DEPTH OF WELL** 47' ft.  
 WELL'S STATIC WATER LEVEL 18' ft.  
 WELL WAS USED AS:

<input type="checkbox"/> Domestic	<input type="checkbox"/> Public Water Supply	<input type="checkbox"/> Dewatering
<input checked="" type="checkbox"/> Irrigation	<input type="checkbox"/> Oil Field Water Supply	<input type="checkbox"/> Monitoring
<input checked="" type="checkbox"/> Feedlot	<input type="checkbox"/> Domestic (Lawn & Garden)	<input type="checkbox"/> Injection Well
<input type="checkbox"/> Industrial	<input type="checkbox"/> Air Conditioning	<input type="checkbox"/> Other _____

Was a chemical/bacteriological sample submitted to Department? Yes  No

**5 TYPE OF BLANK CASING USED:**

<input type="checkbox"/> Steel	<input type="checkbox"/> RMP (SR)	<input type="checkbox"/> Wrought	<input type="checkbox"/> Fiberglass	<input type="checkbox"/> Other (Specify below) _____
<input checked="" type="checkbox"/> PVC	<input type="checkbox"/> ABS	<input type="checkbox"/> Asbestos-Cement	<input type="checkbox"/> Concrete Tile	

Blank casing diameter 5 in. Was casing pulled? Yes  No  If yes, how much \_\_\_\_\_  
 Casing height above or below land surface 48 below in.

**6 GROUT PLUG MATERIAL:**  Neat cement  Cement grout  Bentonite  Other Rockite Cement

Grout Plug Intervals: From \_\_\_\_\_ ft. to \_\_\_\_\_ ft., From 29' ft. to 1' ft., From 1' ft. to 0' ft.

What is the nearest source of possible contamination:

<input checked="" type="checkbox"/> Septic tank	<input type="checkbox"/> Seepage pit	<input type="checkbox"/> Fuel storage	<input type="checkbox"/> Other (specify below) _____
<input type="checkbox"/> Sewer lines	<input type="checkbox"/> Pit privy	<input type="checkbox"/> Fertilizer storage	
<input type="checkbox"/> Watertight sewer lines	<input type="checkbox"/> Sewage lagoon	<input type="checkbox"/> Insecticide storage	
<input checked="" type="checkbox"/> Lateral lines	<input type="checkbox"/> Feedyard	<input type="checkbox"/> Abandoned water well	Direction from well? <u>S</u>
<input type="checkbox"/> Cess pool	<input type="checkbox"/> Livestock pens	<input type="checkbox"/> Oil well/Gas well	How many feet? <u>1000</u>

FROM	TO	PLUGGING MATERIALS	FROM	TO	PLUGGING MATERIALS
0'	1'	Rockite Cement			Well in pit. Collapsed pit after plugging
1'	29'	Bentonite Chips			and capped with three feet of soil.
29'	47'	Sand			

**7 CONTRACTOR'S OR LANDOWNER'S CERTIFICATION:** This water well was plugged under my jurisdiction and was completed on (mo/day/year) 10/13/2023 and this record is true to the best of my knowledge and belief. Kansas Water Well Contractor's License No. \_\_\_\_\_. This Water Well Record was completed on (mo/day/year) 10/16/2023 under the business name of City of Manhattan, Public Works Department by (signature) Daniel Tidwell

Send one white copy to Kansas Department of Health & Environment, Geology Section, 1000 SW Jackson Street, Ste. 420, Topeka, KS 66612-1367. Send one copy to WATER WELL OWNER and retain one for your records.  
 Visit us at <http://www.kdheks.gov/waterwell/index.html> Telephone 785-296-5524.