

County: Shawnee Fraction SW SE SE SE Sec. 26 T. 11 S R. 15 E/W

**CORRECTION(S) TO WATER WELL COMPLETION RECORD (WWC-5)**  
(to rectify lacking or incorrect information)

Owner: Terracon Consultants, Inc.

Location was listed as:	Location changed to:
Section-Township-Range: <u>26-11S-15E</u>	<u>26-11S-15E</u>
Fraction (1/4 1/4 1/4): <u>None Given</u>	<u>SW SE SE SE</u>

Other changes: Initial statements: \_\_\_\_\_

Changed to: \_\_\_\_\_

Comments: \_\_\_\_\_

Verification method: Latitude & Longitude, KGS' "LEO" conversion tool, written description, city street map, and mapping tool on KGS website.

initials: DRJ date: 6/12/2014

Submitted by: Kansas Geological Survey, Data Resources Library, 1930 Constant Ave., Lawrence, KS 66047-3726  
to: Kansas Dept of Health & Environment, Bureau of Water, 1000 SW Jackson, Suite 420, Topeka, KS 66612-1367.

<b>1 LOCATION OF WATER WELL:</b> County: <u>Shawnee</u>	Fraction <u>1/4</u> <u>1/4</u> <u>1/4</u> <u>1/4</u>	Section Number <u>26</u>	Township Number <u>T 11 S</u>	Range Number <u>15</u> <input checked="" type="checkbox"/> E <input type="checkbox"/> W
--	---	-----------------------------	----------------------------------	--

Street/Rural Address of Well Location; if unknown, distance & direction from nearest town or intersection: If at owner's address, check here

NW of SW 6th Avenue and SW MacVicar Avenue

**Global Positioning Systems (GPS) information:**  
 Latitude: 39.059408 (in decimal degrees)  
 Longitude: -95.707869 (in decimal degrees)  
 Elevation: \_\_\_\_\_  
 Datum:  WGS84,  NAD83,  NAD27  
 Collection Method: \_\_\_\_\_  
 GPS unit (Make/Model: \_\_\_\_\_)  
 Digital Map/Photo,  Topographic Map,  Land Survey  
 Est. Accuracy:  < 3 m,  3-5 m,  5-15 m,  > 15 m

**2 WATER WELL OWNER:** Terracon Consultants, Inc  
 RR#, St. Address, Box #: 3113 SW Van Buren Street  
 City, State ZIP Code: Topeka, Kansas 66611

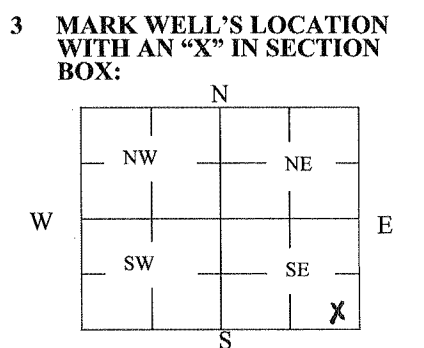

**4 DEPTH OF WELL** 15 ft.  
 WELL'S STATIC WATER LEVEL 6.9 ft  
 WELL WAS USED AS:  
 Domestic Irrigation Feedlot Industrial  
 Public Water Supply Oil Field Water Supply Air Conditioning  
 Dewatering Monitoring Injection Well Other B-10  
 Was a chemical/bacteriological sample submitted to Department? Yes  No

**5 TYPE OF BLANK CASING USED:**

Steel  PVC  RMP (SR)  ABS  Wrought Asbestos-Cement  Fiberglass Concrete Tile  Other (Specify below) \_\_\_\_\_

Blank casing diameter 2 in. Was casing pulled? Yes  No  If yes, how much 15 ft  
 Casing height above or below land surface \_\_\_\_\_ in.

**6 GROUT PLUG MATERIAL:**  Neat cement  Cement grout  Bentonite  Other \_\_\_\_\_

Grout Plug Intervals: From 0 ft. to 15 ft., From \_\_\_\_\_ ft. to \_\_\_\_\_ ft., From \_\_\_\_\_ to \_\_\_\_\_ ft.

What is the nearest source of possible contamination:

<input type="checkbox"/> Septic tank	<input type="checkbox"/> Seepage pit	<input checked="" type="checkbox"/> Fuel Storage	<input type="checkbox"/> Other (specify below) _____
<input type="checkbox"/> Sewer lines	<input type="checkbox"/> Pit privy	<input type="checkbox"/> Fertilizer storage	
<input type="checkbox"/> Watertight sewer lines	<input type="checkbox"/> Sewage lagoon	<input type="checkbox"/> Insecticide storage	
<input type="checkbox"/> Lateral lines	<input type="checkbox"/> Feedyard	<input type="checkbox"/> Abandoned water well	
<input type="checkbox"/> Cess pool	<input type="checkbox"/> Livestock pens	<input type="checkbox"/> Oil well/Gas well	

Direction from well? \_\_\_\_\_  
 How many feet? \_\_\_\_\_

FROM	TO	PLUGGING MATERIALS	FROM	TO	PLUGGING MATERIALS
0	15	bentonite chips			

**7 CONTRACTOR'S OR LANDOWNER'S CERTIFICATION:** This water well was plugged under my jurisdiction and was completed on (mo/day/year) 5/1/2014 and this record is true to the best of my knowledge and belief. Kansas Water Well Contractor's License No. 416. This Water Well Record was completed on (mo/day/year) 5/5/2014 under the business name of Terracon Consultants, Inc. by (signature)

**INSTRUCTIONS:** Use typewriter or ballpoint pen. Please press firmly and print clearly. Please fill in blanks, underline or circle the correct answers. Send one copy to Kansas Department of Health and Environment, Bureau of Water, Geology Section, 1000 SW Jackson St., Ste. 420, Topeka, Kansas 66612-1367. Telephone: 785/296-5524. Send one to Water Well Owner and retain one for your records. Visit us at <http://www.kdheks.gov/waterwell/index.html>.