

County: Shawnee Fraction NE SE SE SE Sec. 26 T. 11 S R. 15 EW

**CORRECTION(S) TO WATER WELL COMPLETION RECORD (WWC-5)**

(to rectify lacking or incorrect information)

Owner: Terracon Consultants, Inc.

Location was listed as:

Section-Township-Range: 26-11S-15E

Fraction (1/4 1/4 1/4): None Given

Location changed to:

26-11S-15E

NE SE SE SE

Other changes: Initial statements: \_\_\_\_\_

Changed to: \_\_\_\_\_

Comments: \_\_\_\_\_

Verification method: Latitude & Longitude, KGS' "LEO" conversion tool, written description, city street map, and mapping tool on KGS website.

initials: DRL date: 6/12/2014

Submitted by: Kansas Geological Survey, Data Resources Library, 1930 Constant Ave., Lawrence, KS 66047-3726  
to: Kansas Dept of Health & Environment, Bureau of Water, 1000 SW Jackson, Suite 420, Topeka, KS 66612-1367.

**WATER WELL PLUGGING RECORD Form WWC-5P KSA 82a-1212 ID NO.**

<b>1 LOCATION OF WATER WELL:</b> County: <u>Shawnee</u>	Fraction $\frac{1}{4}$ $\frac{1}{4}$ $\frac{1}{4}$ $\frac{1}{4}$	Section Number <u>26</u>	Township Number <u>T 11 S</u>	Range Number <u>15</u> <input checked="" type="checkbox"/> E <input type="checkbox"/> W
--	---	-----------------------------	----------------------------------	--

Street/Rural Address of Well Location; if unknown, distance & direction from nearest town or intersection: If at owner's address, check here

NW of SW 6th Avenue and SW MacVicar Avenue

**Global Positioning Systems (GPS) information:**  
 Latitude: 39.060284 (in decimal degrees)  
 Longitude: -95.706716 (in decimal degrees)  
 Elevation: \_\_\_\_\_  
 Datum:  WGS84,  NAD83,  NAD27  
 Collection Method:  
 GPS unit (Make/Model: \_\_\_\_\_)  
 Digital Map/Photo,  Topographic Map,  Land Survey  
 Est. Accuracy:  < 3 m,  3-5 m,  5-15 m,  > 15 m

**2 WATER WELL OWNER:** Terracon Consultants, Inc  
 RR#, St. Address, Box #: 3113 SW Van Buren Street  
 City, State ZIP Code: Topeka, Kansas 66611

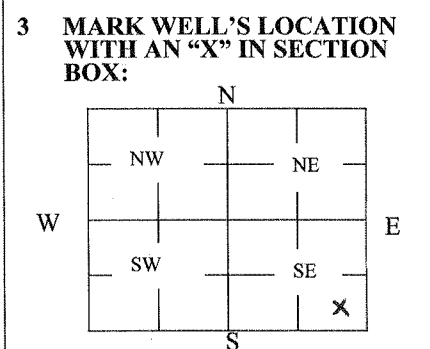

**4 DEPTH OF WELL** 15 ft.  
 WELL'S STATIC WATER LEVEL 8.03 ft.  
 WELL WAS USED AS:  
 Domestic  Public Water Supply  Dewatering  
 Irrigation  Oil Field Water Supply  Monitoring  
 Feedlot  Domestic (Lawn & Garden)  Injection Well  
 Industrial  Air Conditioning  Other B-19  
 Was a chemical/bacteriological sample submitted to Department? Yes  No

**5 TYPE OF BLANK CASING USED:**

Steel  RMP (SR)  Wrought  Fiberglass  Other (Specify below) \_\_\_\_\_  
 PVC  ABS  Asbestos-Cement  Concrete Tile

Blank casing diameter 2 in. Was casing pulled? Yes  No  If yes, how much 4 ft  
 Casing height above or below land surface 48 in.

**6 GROUT PLUG MATERIAL:**  Neat cement  Cement grout  Bentonite  Other \_\_\_\_\_

Grout Plug Intervals: From 0 ft. to 15 ft., From \_\_\_\_\_ ft. to \_\_\_\_\_ ft., From \_\_\_\_\_ to \_\_\_\_\_ ft.

What is the nearest source of possible contamination:  
 Septic tank  Seepage pit  Fuel Storage  Other (specify below) \_\_\_\_\_  
 Sewer lines  Pit privy  Fertilizer storage  
 Watertight sewer lines  Sewage lagoon  Insecticide storage  
 Lateral lines  Feedyard  Abandoned water well Direction from well? \_\_\_\_\_  
 Cess pool  Livestock pens  Oil well/Gas well How many feet? \_\_\_\_\_

FROM	TO	PLUGGING MATERIALS	FROM	TO	PLUGGING MATERIALS
0	15	bentonite chips			

**7 CONTRACTOR'S OR LANDOWNER'S CERTIFICATION:** This water well was plugged under my jurisdiction and was completed on (mo/day/year) 5/1/2014 and this record is true to the best of my knowledge and belief. Kansas Water Well Contractor's License No. 416. This Water Well Record was completed on (mo/day/year) 5/5/2014 under the business name of Terracon Consultants, Inc. by (signature)

**INSTRUCTIONS:** Use typewriter or ballpoint pen. Please press firmly and print clearly. Please fill in blanks, underline or circle the correct answers. Send one copy to Kansas Department of Health and Environment, Bureau of Water, Geology Section, 1000 SW Jackson St., Ste. 420, Topeka, Kansas 66612-1367. Telephone: 785/296-5524. Send one to Water Well Owner and retain one for your records. Visit us at <http://www.kdheks.gov/waterwell/index.html>.