

County: Shawnee Fraction NW SE SE SE Sec. 26 T 11 S R 15 E/W

CORRECTION(S) TO WATER WELL COMPLETION RECORD (WWC-5)

(to rectify lacking or incorrect information)

Owner: Terracon Consultants, Inc.

Location was listed as:

Section-Township-Range: 26-11S-15E

Fraction (1/4 1/4 1/4): None Given

Location changed to:

26-11S-15E

NW SE SE SE

Other changes: Initial statements: _____

Changed to: _____

Comments: _____

Verification method: Latitude & Longitude, KGS' "LEO" conversion tool, written description, city street map, and mapping tool on KGS website.

initials: DR date: 6/12/2014

Submitted by: Kansas Geological Survey, Data Resources Library, 1930 Constant Ave., Lawrence, KS 66047-3726

to: Kansas Dept of Health & Environment, Bureau of Water, 1000 SW Jackson, Suite 420, Topeka, KS 66612-1367.

WATER WELL PLUGGING RECORD Form WWC-5P KSA 82a-1212 ID NO.

1 LOCATION OF WATER WELL: County: Shawnee	Fraction $\frac{1}{4}$ $\frac{1}{4}$ $\frac{1}{4}$ $\frac{1}{4}$	Section Number 26	Township Number T 11 S	Range Number 15 <input checked="" type="checkbox"/> E <input type="checkbox"/> W
--	---	-----------------------------	----------------------------------	--

Street/Rural Address of Well Location; if unknown, distance & direction from nearest town or intersection: If at owner's address, check here

NW of SW 6th Avenue and SW MacVicar Avenue

Global Positioning Systems (GPS) information:
 Latitude: **39.059833** (in decimal degrees)
 Longitude: **-95.707641** (in decimal degrees)
 Elevation: _____
 Datum: WGS84, NAD83, NAD27
 Collection Method:
 GPS unit (Make/Model: _____)
 Digital Map/Photo, Topographic Map, Land Survey
 Est. Accuracy: < 3 m, 3-5 m, 5-15 m, > 15 m

2 WATER WELL OWNER: Terracon Consultants, Inc
 RR#, St. Address, Box #: **3113 SW Van Buren Street**
 City, State ZIP Code: **Topeka, Kansas 66611**

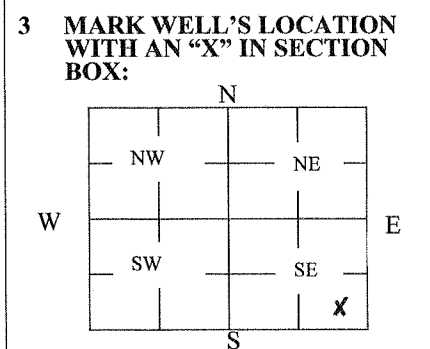

4 DEPTH OF WELL 15 ft.
 WELL'S STATIC WATER LEVEL 3.62 ft.
 WELL WAS USED AS:
 Domestic Public Water Supply Dewatering
 Irrigation Oil Field Water Supply Monitoring
 Feedlot Domestic (Lawn & Garden) Injection Well
 Industrial Air Conditioning Other B-15R
 Was a chemical/bacteriological sample submitted to Department? Yes No

5 TYPE OF BLANK CASING USED:

Steel RMP (SR) Wrought Fiberglass Other (Specify below) _____
 PVC ABS Asbestos-Cement Concrete Tile

Blank casing diameter 2 in. Was casing pulled? Yes No If yes, how much 4 ft
 Casing height above or below land surface 48 in.

6 GROUT PLUG MATERIAL: Neat cement Cement grout Bentonite Other _____

Grout Plug Intervals: From 0 ft. to 15 ft., From _____ ft. to _____ ft., From _____ to _____ ft.

What is the nearest source of possible contamination:
 Septic tank Seepage pit Fuel Storage Other (specify below) _____
 Sewer lines Pit privy Fertilizer storage _____
 Watertight sewer lines Sewage lagoon Insecticide storage _____
 Lateral lines Feedyard Abandoned water well Direction from well? _____
 Cess pool Livestock pens Oil well/Gas well How many feet? _____

FROM	TO	PLUGGING MATERIALS	FROM	TO	PLUGGING MATERIALS
0	15	bentonite chips			

7 CONTRACTOR'S OR LANDOWNER'S CERTIFICATION: This water well was plugged under my jurisdiction and was completed on (mo/day/year) 5/1/2014 and this record is true to the best of my knowledge and belief. Kansas Water Well Contractor's License No. 416. This Water Well Record was completed on (mo/day/year) 5/5/2014 under the business name of Terracon Consultants, Inc. by (signature)

INSTRUCTIONS: Use typewriter or ballpoint pen. Please press firmly and print clearly. Please fill in blanks, underline or circle the correct answers. Send one copy to Kansas Department of Health and Environment, Bureau of Water, Geology Section, 1000 SW Jackson St., Ste. 420, Topeka, Kansas 66612-1367. Telephone: 785/296-5524. Send one to Water Well Owner and retain one for your records. Visit us at <http://www.kdheks.gov/waterwell/index.html>.