

EMW1

1 LOCATION OF WATER WELL:
 County: Shawnee Fraction SW 1/4 SE 1/4 NE 1/4 Section Number 13 Township Number T 11 S Range Number 15 E W

Street/Rural Address of Well Location; if unknown, distance & direction from nearest town or intersection: If at owner's address, check here
 2000 NW Hwy 24, Topeka

Global Positioning Systems (GPS) information:
 Latitude: _____ (in decimal degrees)
 Longitude: _____ (in decimal degrees)
 Elevation: _____

Horizontal Datum WGS84, NAD83, NAVD27
 Collection Method:
 GPS unit (Make/model: _____)
 Digital Map/Photo, Topographic Map Land Survey
 Est. Accuracy: <3 m, 3-5 m, 5-15 m, >15 m

2 WATER WELL OWNER: Goodyear Tire Company
 RR#, St. Address, Box #: P.O. Box 1069
 City, State ZIP Code: Topeka, KS 66618

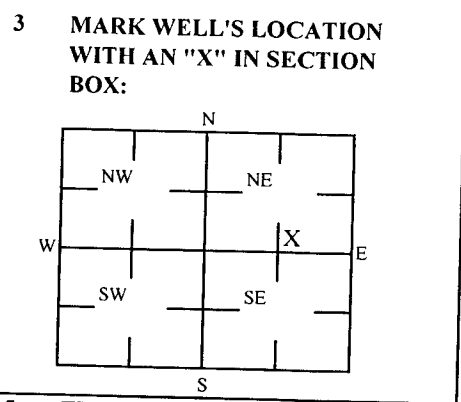

4 DEPTH OF WELL 39.9 ft. EMW1
 WELL'S STATIC WATER LEVEL _____ ft
 WELL WAS USED AS:
 Domestic Public Water Supply Dewatering
 Irrigation Oil Field Water Supply Monitoring
 Feedlot Domestic (Lawn & Garden) Injection Well
 Industrial Air Conditioning Other _____
 Was a chemical/bacteriological sample submitted to Department? Yes No

5 TYPE OF BLANK CASING USED:
 Steel RMP (SR) Wrought Fiberglass Other (Specific below)
 PVC ABS Asbestos-Cement Concrete Tile
 Blank casing diameter 2 in. Was casing pulled? Yes No If yes, how much 3 ft
 Casing height above or below land surface NA in.

6 GROUT PLUG MATERIAL: Neat cement Cement grout Bentonite Other Soil: 0-3'
 Grout Plug Intervals: From 3 ft to 39.9 ft, From _____ ft to _____ ft, From _____ ft to _____ ft.
 What is the nearest source of possible contamination:
 Septic tank Seepage pit Fuel storage Other (specify below) _____
 Sewer lines Pit privy Fertilizer storage
 Watertight sewer lines Sewage lagoon Insecticide storage
 Lateral lines Feed yard Abandoned water well
 Cess pool Livestock pens Oil well/Gas well
 Direction from well? _____
 How many feet? _____

FROM	TO	PLUGGING MATERIALS	FROM	TO	PLUGGING MATERIALS
0	3	Soil			
3	39.9	Bentonite			

KDHE ID: Goodyear Tire and Rubber; U4-089-00539

7 CONTRACTOR'S OR LANDOWNER'S CERTIFICATION: This water well was plugged under my jurisdiction and was completed on (mo/day/year) 7/21/22 and this record is true to the best of my knowledge and belief. Kansas Water Contractor's License No. 757. This Water Well Record was completed on (mo/day/year) 7/22/22 under the business name of Larsen & Associates, Inc. By (signature) _____

Send one white copy to Kansas Department of Health & Environment, Geology Section, 1000 SW Jackson Street, Ste 200, Topeka, KS 66612-1367. Send one copy to WATER WELL OWNER and retain one for your records
 Visit us at <http://www.kdheks.gov/waterwell/index.html> Telephone 785-296-5524.

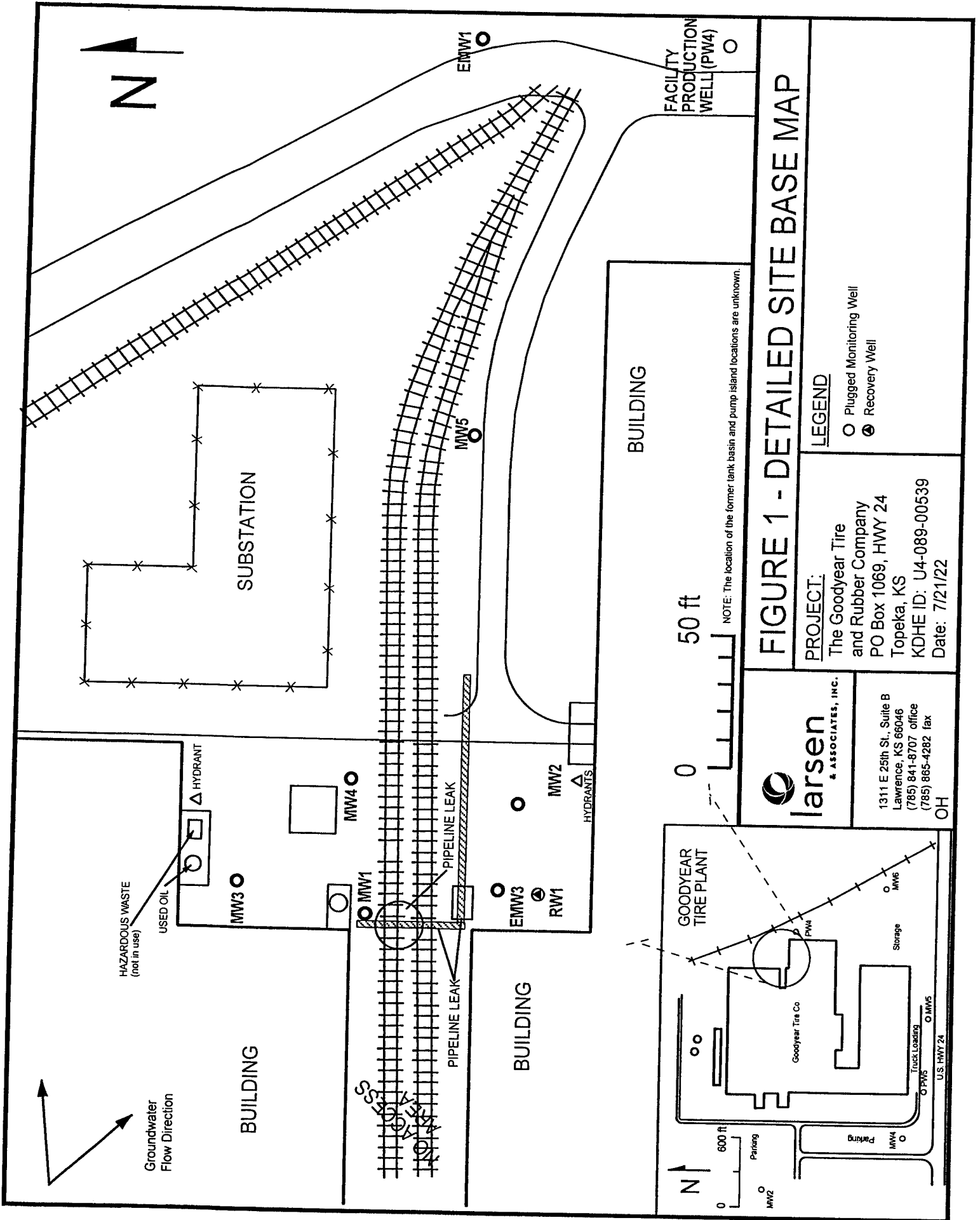

NOTE: The location of the former tank basin and pump island locations are unknown.

FIGURE 1 - DETAILED SITE BASE MAP

LEGEND

- Plugged Monitoring Well
- Recovery Well

PROJECT:

The Goodyear Tire and Rubber Company
 PO Box 1069, HWY 24
 Topeka, KS
 KDHE ID: U4-089-00539
 Date: 7/21/22

larsen
 & ASSOCIATES, INC.

1311 E 25th St., Suite B
 Lawrence, KS 66046
 (785) 841-8707 office
 (785) 865-4282 fax

OH