

snawnee

13-11-150

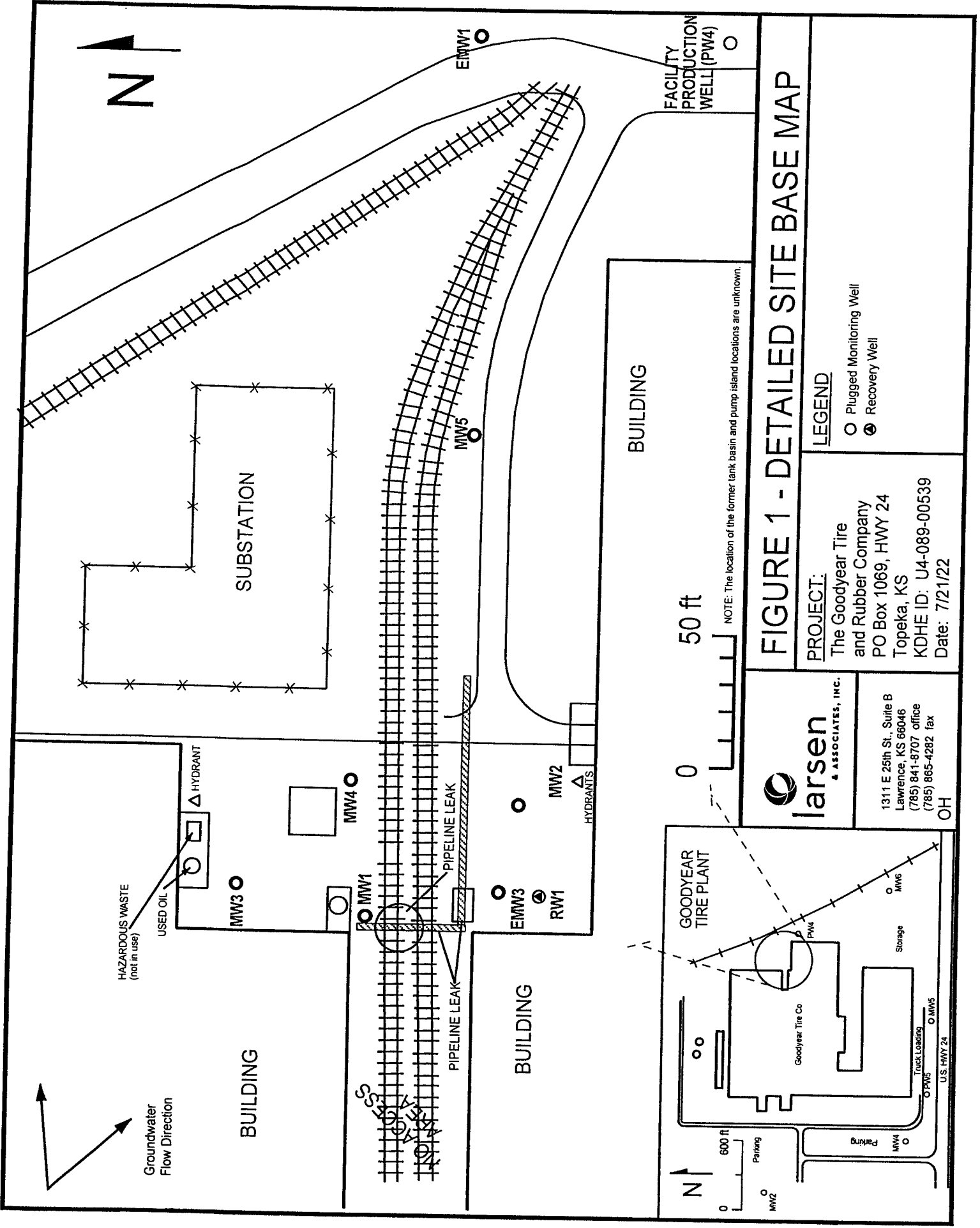

FIGURE 1 - DETAILED SITE BASE MAP

LEGEND

- Plugged Monitoring Well
- Recovery Well

PROJECT:

The Goodyear Tire and Rubber Company
 PO Box 1069, HWY 24
 Topeka, KS
 KDHE ID: U4-089-00539
 Date: 7/21/22



1311 E 25th St., Suite B
 Lawrence, KS 66046
 (785) 841-8707 office
 (785) 865-4282 fax

OH