

WATER WELL PLUGGING RECORD Form WWC-5P KSA 82a-1212 ID NO.

MW4

1 LOCATION OF WATER WELL: Fraction SW 1/4 SE 1/4 NE 1/4 Section Number 13 Township Number T 11 S Range Number 15 E W

Street/Rural Address of Well Location; if unknown, distance & direction from nearest town or intersection: If at owner's address, check here
 2000 NW Hwy 24, Topeka

Global Positioning Systems (GPS) information:
 Latitude: _____ (in decimal degrees)
 Longitude: _____ (in decimal degrees)
 Elevation: _____

2 WATER WELL OWNER: Goodyear Tire Company
 RR#, St. Address, Box #: P.O. Box 1069
 City, State ZIP Code: Topeka, KS 66618

Horizontal Datum WGS84, NAD83, NAVD27
 Collection Method:
 GPS unit (Make/model: _____)
 Digital Map/Photo, Topographic Map Land Survey
 Est. Accuracy: <3 m, 3-5 m, 5-15 m, >15 m

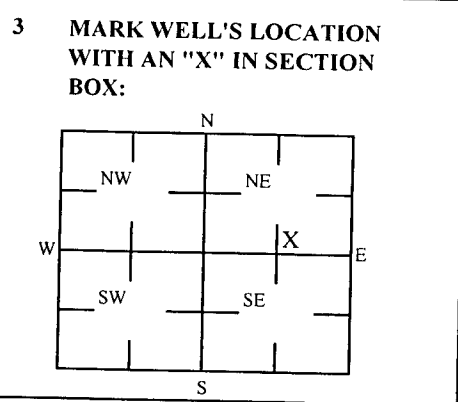

4 DEPTH OF WELL 32.9 ft. MW4
 WELL'S STATIC WATER LEVEL _____ ft
 WELL WAS USED AS:
 Domestic Public Water Supply Dewatering
 Irrigation Oil Field Water Supply Monitoring
 Feedlot Domestic (Lawn & Garden) Injection Well
 Industrial Air Conditioning Other _____
 Was a chemical/bacteriological sample submitted to Department? Yes No

5 TYPE OF BLANK CASING USED:

Steel RMP (SR) Wrought Fiberglass Other (Specific below)
 PVC ABS Asbestos-Cement Concrete Tile

Blank casing diameter 2 in. Was casing pulled? Yes No If yes, how much 1 ft
 Casing height above or below land surface NA in.

6 GROUT PLUG MATERIAL: Neat cement Cement grout Bentonite Other Concrete: 0-0.5'; Soil: 0.5-3'
 Grout Plug Intervals: From 3 ft to 32.9 ft, From _____ ft to _____ ft, From _____ ft to _____ ft.

What is the nearest source of possible contamination:

Septic tank Seepage pit Fuel storage Other (specify below)
 Sewer lines Pit privy Fertilizer storage
 Watertight sewer lines Sewage lagoon Insecticide storage
 Lateral lines Feed yard Abandoned water well
 Cess pool Livestock pens Oil well/Gas well
 Direction from well? _____
 How many feet? _____

FROM	TO	PLUGGING MATERIALS	FROM	TO	PLUGGING MATERIALS
0	0.5	Concrete			
0.5	3	Soil			
3	32.9	Bentonite			
KDHE ID: Goodyear Tire and Rubber; U4-089-00539					

7 CONTRACTOR'S OR LANDOWNER'S CERTIFICATION: This water well was plugged under my jurisdiction and was completed on (mo/day/year) 7/21/22 and this record is true to the best of my knowledge and belief. Kansas Water Contractor's License No. 757. This Water Well Record was completed on (mo/day/year) 7/22/22 under the business name of Larsen & Associates, Inc. By (signature) _____

Send one white copy to Kansas Department of Health & Environment, Geology Section, 1000 SW Jackson Street, Ste. 420, Topeka, KS 66612-1367. Send one copy to WATER WELL OWNER and retain one for your records
 Visit us at <http://www.kdheks.gov/waterwell/index.html> Telephone 785-296-5524.

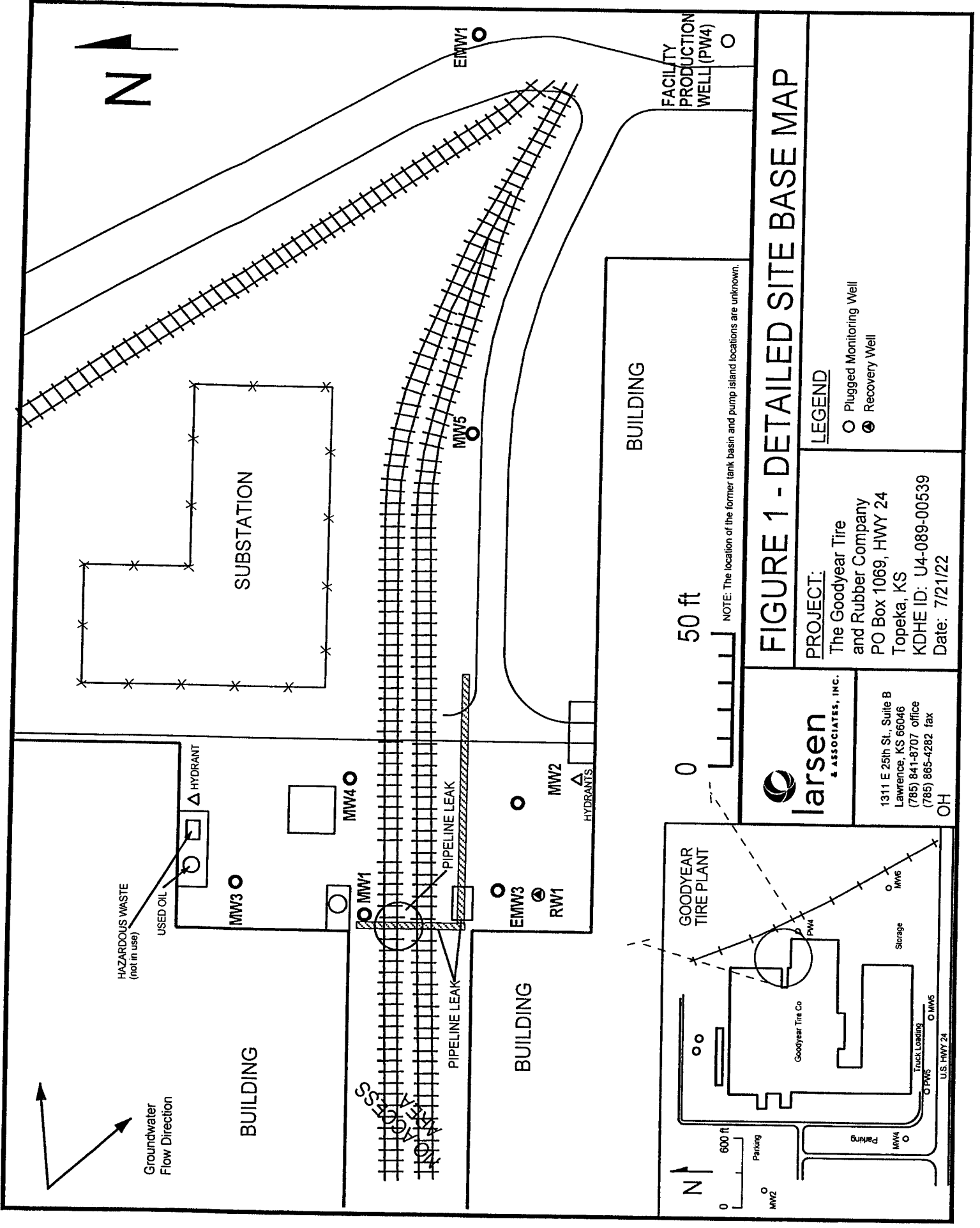

FIGURE 1 - DETAILED SITE BASE MAP

LEGEND

- Plugged Monitoring Well
- ⊙ Recovery Well

PROJECT:

The Goodyear Tire and Rubber Company
 PO Box 1069, HWY 24
 Topeka, KS
 KDHE ID: U4-089-00539
 Date: 7/21/22



1311 E 25th St., Suite B
 Lawrence, KS 66046
 (785) 841-8707 office
 (785) 865-4282 fax

OH