

WATER WELL RECORD

Form WWC-5

Division of Water Resources App. No.

Well ID

MWIR

Original Record Correction Change in Well Use

1 LOCATION OF WATER WELL: County Shawnee Fraction SE 1/4 SE 1/4 SE 1/4 SE 1/4 Section Number 34 Township Number T 11 S Range Number R 16 E W

2 WELL OWNER: Last Name: First: Street or Rural Address where well is located (if unknown, distance and direction from nearest town or intersection): If at owner's address, check here: 545 SE Croco Rd., Topeka, KS

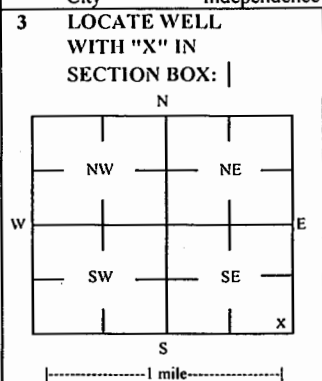

4 DEPTH OF COMPLETED WELL: 12 ft Depth(s) Groundwater Encountered: 1) 12 ft 2) 9.7 ft 3) 0 ft 4) Dry Well WELL'S STATIC WATER LEVEL: 9.7 ft

5 Latitude: 39.04457 (decimal degrees) Longitude: 95.61404 (decimal degrees) Horizontal Datum: WGS 84 NAD 83 NAD 27

7 WELL WATER TO BE USED AS: 1 Domestic: Household, Lawn & Garden, Livestock, Irrigation, Feedlot, Industrial

Was a chemical/bacteriological sample submitted to KDHE? Yes No If yes, date sample was submitted: Water well disinfected? Yes No

8 TYPE OF CASING USED: Steel PVC Other CASING JOINTS: Glued Clamped Welded Threaded Casing diameter 2 in. to 3 ft, Diameter in. to ft, Diameter in. to ft, Casing height above land surface -0.23 in. Weight lbs./ft. Well thickness or gauge No

9 GROUT MATERIAL: Neat cement Cement grout Bentonite Other Concrete: 0-0.7' Grout intervals: From 0.7 ft. to 2 ft, From ft. to ft, From ft. to ft,

Nearest source of possible contamination: Septic Tank Lateral Lines Pit Privy Livestock Pens Insecticide Storage Sewer Lines Cess Pool Sewage Lagoon Fuel Storage Abandoned Water Well Watertight Sewer Lines Seepage Pit Feedyard Fertilizer Storage Oil Well / Gas Well

Table with columns: FROM, TO, LITHOLOGIC LOG, FROM, TO, LITHO. LOG (cont.) or PLUGGING INTERVALS. Rows: 0-0.3 Gravel, 0.3-6 Silty clay/weathered mudstone, 6-10 Weathered siltstone/fine sandstone, 10-12 Shale

Notes: KDHE ID: Pops Stop-N-Shop; U4-089-14702 Target of monitoring well is shallow groundwater, <20' of grout was installed at the direction of KDHE.

11 CONTRACTOR'S OR LANDOWNER'S CERTIFICATION: This water well was constructed, reconstructed or plugged under my jurisdiction and was completed on (mo-day-year) 10/17/18 and this record is true to the best of my knowledge and belief. Kansas Water Well Contractor's License No 757 This Water Well Record was completed on (mo-day-year) 1/4/19 under the business name of Larsen & Associates, Inc. Signature

Mail 1 white copy along with a fee of \$5.00 for each constructed well to: Kansas Department of Health and Environment, Bureau of Water, GW Section, 1000 SW Jackson St., Suite 420, Topeka, Kansas 66612-1367. Mail one to Water Well Owner and retain one for your records. Telephone 785-296-5524.

# DENNIS L HANDKE

1820 NW 59th Terrace  
TOPEKA, KANSAS 66618  
785-286-4047 Home  
785-217-5864 Cell

Jess Chapman  
Larsen & Associates  
1311 E. 25<sup>th</sup> Street, Suite B  
Lawrence, Kansas, 66046

June 7, 2019

RE: Monitor Well Elevation Survey  
545 SE Croco Road, Topeka, Kansas

Proj. 19-00T  
Pops Stop-N-Shop  
U4-089-14702

Bench Mark: Chisled X on NE bolt in top fire hydrant at Southeast corner of property.

Elev: 949.43      North 98.84      West 34.77      (from SE Cor. Sec. 10-10-12E)

|       |          |        |       |        |                               |
|-------|----------|--------|-------|--------|-------------------------------|
| MW-1R | rim      | 935.40 | North | 100.16 | SE1/4,SE1/4,SE1/4,SE1/4       |
|       | top pipe | 935.17 | West  | 145.35 | Lat= 39.04457 Long = 95.61404 |
| MW-8  | rim      | 931.11 | North | 107.79 | SE1/4,SE1/4,SE1/4,SE1/4       |
|       | top pipe | 930.82 | West  | 261.73 | Lat= 39.04459 Long = 95.61445 |
| MW-9  | rim      | 934.89 | North | 175.33 | SE1/4,SE1/4,SE1/4,SE1/4       |
|       | top pipe | 934.62 | West  | 99.64  | Lat= 39.04477 Long = 95.61387 |
| MW-10 | rim      | 930.63 | North | 196.99 | SE1/4,SE1/4,SE1/4,SE1/4       |
|       | top pipe | 930.24 | West  | 246.93 | Lat= 39.04484 Long = 95.61439 |
| MW-11 | rim      | 930.28 | North | 283.14 | SE1/4,SE1/4,SE1/4,SE1/4       |
|       | top pipe | 930.00 | West  | 186.38 | Lat= 39.04507 Long = 95.61417 |
| MW-12 | rim      | 929.19 | North | 214.12 | SW1/4,SE1/4,SE1/4,SE1/4       |
|       | top pipe | 928.91 | West  | 349.46 | Lat= 39.04489 Long = 95.61475 |

Elevation derived from City of Topeka BM #75.1 NAVD27.

Lat & Long derived from Grantville 7.5' Quad Maps WGS 84.

If you have any questions, please feel free to call me. Thank you for the opportunity to be of service to you.

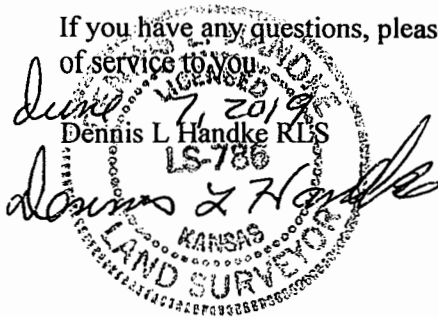

NOTE: Figures exhibited within this report are only to be used within the context of this report. Placement of property lines, wells, structures, and roads is based on the available information from county appraiser maps, surveys, site visits, and/or previous vendor reports and should be considered approximate.



FIGURE 2.2 - 500 FT RADIUS AREA BASE MAP

**LEGEND:**

- Approximate Location of Former UST Basin and Pump Islands
- Approximate Location of Active UST Basin and Pump Islands
- Building with Basement
- Approximate Location of Property Line
- Observation Well
- Plugged Well
- Existing Monitoring Well
- Monitoring Well (Installed 5/29/19)
- Soil Boring (Drilled 10/12-13/16)
- Fire Hydrant
- Sewer Inlet
- Electric Lines (2 - 6 ft BGS)
- Gas Lines (2 - 6 ft BGS)
- Overhead Lines (25-40 ft high)
- Telephone Lines (2 - 6 ft BGS)
- Water Lines (2 - 6 ft BGS)

NOTE: Approximate location of product lines is unknown.  
NOTE: Utility depths, heights and locations are approximate.



**PROJECT:**

Pops Stop-N-Shop  
545 SE Croco Road  
Topeka, KS  
KDHE ID: U4-089-14702  
Date: 6/26/19



1311 E 25th St., Suite B (785) 841-8707 office  
Lawrence, KS 66046 (785) 865-4282 fax

RECEIVED  
AUG 02 2019  
BUREAU OF WATER