

WATER WELL RECORD

Form WWC-5

Division of Water Resources App. No.

Well ID

MW9

Original Record Correction Change in Well Use

1 LOCATION OF WATER WELL: County Shawnee Fraction SE ¼ SE ¼ SE ¼ SE ¼ Section Number 34 Township Number T 11 S Range Number R 16 E W

2 WELL OWNER: Last Name: Jays Realty, LLC First: _____ Street or Rural Address where well is located (if unknown, distance and direction from nearest town or intersection): 545 SE Croco Rd, Topeka, KS If at owner's address, check here:
 Business: Jays Realty, LLC
 Address: PO Box 1176
 Address: _____
 City: Independence State: KS ZIP: 67301

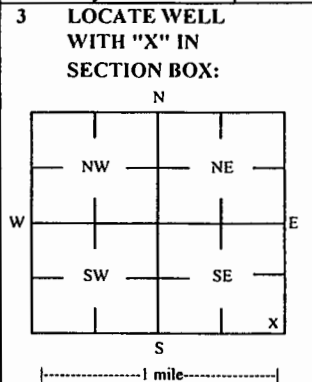

4 DEPTH OF COMPLETED WELL: 14.5 ft
 Depth(s) Groundwater Encountered: 1) _____ ft
 2) _____ ft 3) _____ ft, or 4) Dry Well
 WELL'S STATIC WATER LEVEL: 12.50 ft.
 below land surface, measured on (mo-day-yr) 6/26/19
 above land surface, measured on (mo-day-yr) _____
 Pump test data: Well water was _____ ft after _____ hours pumping _____ gpm
 Water well was _____ ft after _____ hours pumping _____ gpm
 Estimated Yield: _____ gpm
 Bore Hole Diameter: 7.25 in to _____ ft, and _____ in to _____ ft

5 Latitude: 39.04477 (decimal degrees)
Longitude 95.61387 (decimal degrees)
 Horizontal Datum: WGS 84 NAD 83 NAD 27
 Source for Latitude/Longitude: _____
 GPS (unit make/model: _____) (WAAS enabled? Yes No)
 Land Survey Topographic Map
 Online Mapper

6 Elevation 934.62 ft Ground Level TOC
 Source Land Survey GPS Topographic Map
 Other _____

7 WELL WATER TO BE USED AS:

1 Domestic: <input type="checkbox"/> Household <input type="checkbox"/> Lawn & Garden <input type="checkbox"/> Livestock <input type="checkbox"/> Irrigation <input type="checkbox"/> Feedlot <input type="checkbox"/> Industrial	5 <input type="checkbox"/> Public Water Supply: well ID	10 <input type="checkbox"/> Oil Field Water Supply: lease _____
2 <input type="checkbox"/> Livestock	6 <input type="checkbox"/> Dewatering: how many wells?	11 Test Hole: well ID _____
3 <input type="checkbox"/> Irrigation	7 <input type="checkbox"/> Aquifer Recharge: well ID	<input type="checkbox"/> Cased <input type="checkbox"/> Uncased <input type="checkbox"/> Geotechnical
4 <input type="checkbox"/> Feedlot	8 <input checked="" type="checkbox"/> Monitoring: well ID <u>MW9</u>	12 Geothermal: How many bores?
5 <input type="checkbox"/> Industrial	9 Environmental Remediation: well ID	a) Closed Loop <input type="checkbox"/> Horizontal <input type="checkbox"/> Vertical
	<input type="checkbox"/> Air Sparge <input type="checkbox"/> Soil Vapor Extractor	b) Open Loop <input type="checkbox"/> Surface Discharge <input type="checkbox"/> Inj. of Water
	<input type="checkbox"/> Recovery <input type="checkbox"/> Injection	<input type="checkbox"/> Other (specify): _____

Was a chemical/bacteriological sample submitted to KDHE? Yes No If yes, date sample was submitted: _____
 Water well disinfected? Yes No

8 TYPE OF CASING USED: Steel PVC Other _____ CASING JOINTS: Glued Clamped Welded Threaded
 Casing diameter 2 in. to 4.5 ft, Diameter _____ in. to _____ ft, Diameter _____ in. to _____ ft,
 Casing height above land surface -0.27 in. Weight _____ lbs./ft. Well thickness or gauge No _____
TYPE OF SCREEN OR PERFORATION MATERIAL:
 Steel Stainless Steel Fiberglass PVC Other (Specify) _____
 Brass Galvanized Steel Concrete tile None used (open hole)
SCREEN OR PERFORATION OPENINGS ARE:
 Continuous Slot Mill Slot Gauze Wrapped Torch Cut Drilled Holes Other (Specify) _____
 Louvered Shutter Key Punched Wire Wrapped Saw Cut None (Open Hole)
SCREEN-PERFORATED INTERVALS: From 4.5 ft. to 14.5 ft., From _____ ft. to _____ ft., From _____ ft. to _____ ft.,
GRAVEL PACK INTERVALS: From 3 ft. to 15 ft., From _____ ft. to _____ ft., From _____ ft. to _____ ft.,

9 GROUT MATERIAL: Neat cement Cement grout Bentonite Other Concrete: 0-0.7'
 Grout intervals: From 0.7 ft. to 3 ft., From _____ ft. to _____ ft., From _____ ft. to _____ ft.,

Nearest source of possible contamination:
 Septic Tank Lateral Lines Pit Privy Livestock Pens Insecticide Storage
 Sewer Lines Cess Pool Sewage Lagoon Fuel Storage Abandoned Water Well
 Watertight Sewer Lines Seepage Pit Feedyard Fertilizer Storage Oil Well / Gas Well
 Other (Specify) _____
 Direction from well? S Distance from well? ~40 ft

10 FROM	TO	LITHOLOGIC LOG	FROM	TO	LITHO. LOG (cont.) or PLUGGING INTERVALS
0	0.4	Asphalt			
0.4	6.5	Clayey silt			
6.5	14.5	Silty sand, fine grained			
14.5	15	Limestone			

Notes: KDHE ID: Pops Stop-N-Shop; U4-089-14702
 Target of monitoring well is shallow groundwater, <20' of grout was installed at the direction of KDHE.

11 CONTRACTOR'S OR LANDOWNER'S CERTIFICATION: This water well was constructed, reconstructed, or plugged under my jurisdiction and was completed on (mo-day-year) 5/29/19 and this record is true to the best of my knowledge and belief. Kansas Water Well Contractor's License No. 757 This Water Well Record was completed on (mo-day-year) 7/2/19 under the business name of Larsen & Associates, Inc. Signature _____

Mail 1 white copy along with a fee of \$5.00 for each constructed well to: Kansas Department of Health and Environment, Bureau of Water, G-125 Section, 1000 SW Jackson St., Suite 420, Topeka, Kansas 66612-1367. Mail one to Water Well Owner and retain one for your records. Telephone 785-296-5524.

DENNIS L HANDKE

1820 NW 59th Terrace
TOPEKA, KANSAS 66618
785-286-4047 Home
785-217-5864 Cell

Jess Chapman
Larsen & Associates
1311 E. 25th Street, Suite B
Lawrence, Kansas, 66046

June 7, 2019

RE: Monitor Well Elevation Survey
545 SE Croco Road, Topeka, Kansas

Proj. 19-00T
Pops Stop-N-Shop
U4-089-14702

Bench Mark: Chisled X on NE bolt in top fire hydrant at Southeast corner of property.

Elev: 949.43 North 98.84 West 34.77 (from SE Cor. Sec. 10-10-12E)

MW-1R	rim	935.40	North	100.16	SE1/4,SE1/4,SE1/4,SE1/4
	top pipe	935.17	West	145.35	Lat= 39.04457 Long = 95.61404
MW-8	rim	931.11	North	107.79	SE1/4,SE1/4,SE1/4,SE1/4
	top pipe	930.82	West	261.73	Lat= 39.04459 Long = 95.61445
MW-9	rim	934.89	North	175.33	SE1/4,SE1/4,SE1/4,SE1/4
	top pipe	934.62	West	99.64	Lat= 39.04477 Long = 95.61387
MW-10	rim	930.63	North	196.99	SE1/4,SE1/4,SE1/4,SE1/4
	top pipe	930.24	West	246.93	Lat= 39.04484 Long = 95.61439
MW-11	rim	930.28	North	283.14	SE1/4,SE1/4,SE1/4,SE1/4
	top pipe	930.00	West	186.38	Lat= 39.04507 Long = 95.61417
MW-12	rim	929.19	North	214.12	SW1/4,SE1/4,SE1/4,SE1/4
	top pipe	928.91	West	349.46	Lat= 39.04489 Long = 95.61475

Elevation derived from City of Topeka BM #75.1 NAVD27.

Lat & Long derived from Grantville 7.5' Quad Maps WGS 84.

If you have any questions, please feel free to call me. Thank you for the opportunity to be of service to you.

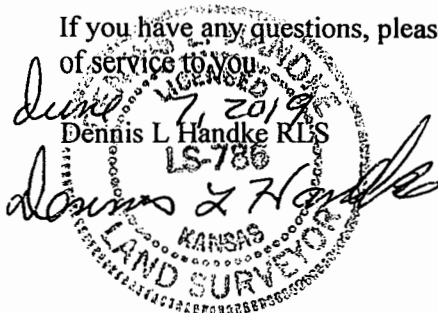

NOTE: Figures exhibited within this report are only to be used within the context of this report. Placement of property lines, wells, structures, and roads is based on the available information from county appraiser maps, surveys, site visits, and/or previous vendor reports and should be considered approximate.



FIGURE 2.2 - 500 FT RADIUS AREA BASE MAP

LEGEND:

- Approximate Location of Former UST Basin and Pump Islands
- Approximate Location of Active UST Basin and Pump Islands
- Building with Basement
- Approximate Location of Property Line
- Observation Well
- Plugged Well
- Existing Monitoring Well
- Monitoring Well (Installed 5/29/19)
- Soil Boring (Drilled 10/12-13/16)
- Fire Hydrant
- Sewer Inlet
- Electric Lines (2 - 6 ft BGS)
- Gas Lines (2 - 6 ft BGS)
- Overhead Lines (25-40 ft high)
- Telephone Lines (2 - 6 ft BGS)
- Water Lines (2 - 6 ft BGS)

NOTE: Approximate location of product lines is unknown.
NOTE: Utility depths, heights and locations are approximate.



PROJECT:

Pops Stop-N-Shop
545 SE Croco Road
Topeka, KS
KDHE ID: U4-089-14702
Date: 6/26/19



1311 E 25th St., Suite B (785) 841-8707 office
Lawrence, KS 66046 (785) 865-4282 fax

RECEIVED
AUG 02 2019
BUREAU OF WATER