

WATER WELL RECORD

Form WWC-5

Division of Water Resources App. No.

Well ID

MW12

Original Record Correction Change in Well Use

1 LOCATION OF WATER WELL: County Shawnee Fraction SW 1/4 SE 1/4 SE 1/4 SE 1/4 Section Number 34 Township Number T 11 S Range Number R 16 E W

2 WELL OWNER: Last Name: Business: Jays Realty, LLC Address: PO Box 1176 City Independence State: KS ZIP: 67301 Street or Rural Address where well is located (if unknown, distance and direction from nearest town or intersection): 545 SE Croco Rd, Topeka, KS

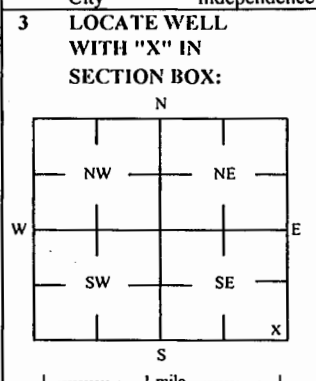

3 LOCATE WELL WITH 'X' IN SECTION BOX: 4 DEPTH OF COMPLETED WELL: 10 ft Depth(s) Groundwater Encountered: 1) 10 ft 2) 9.64 ft 3) Dry Well 4) Dry Well WELL'S STATIC WATER LEVEL: 9.64 ft. X below land surface, measured on (mo-day-yr) 6/26/19

5 Latitude: 39.04489 (decimal degrees) Longitude: 95.61475 (decimal degrees) Horizontal Datum: WGS 84 NAD 83 NAD 27 Source for Latitude/Longitude: GPS (unit make/model:) (WAAS enabled? Yes No) X Land Survey Topographic Map Online Mapper 6 Elevation 928.91 ft Ground Level X TOC Source X Land Survey GPS Topographic Map Other

7 WELL WATER TO BE USED AS: 1 Domestic: Household Lawn & Garden Livestock Irrigation Feedlot Industrial 2 Public Water Supply: well ID 3 Dewatering: how many wells? 4 Aquifer Recharge: well ID 5 Monitoring: well ID MW12 6 Environmental Remediation: well ID Air Sparge Recovery Soil Vapor Extractor Injection 7 Oil Field Water Supply: lease 8 Test Hole: well ID Cased Uncased Geotechnical 9 Geothermal: How many bores? a) Closed Loop Horizontal Vertical b) Open Loop Surface Discharge Inj. of Water Other (specify):

Was a chemical/bacteriological sample submitted to KDHE? Yes No X No If yes, date sample was submitted:

8 TYPE OF CASING USED: Steel PVC Other CASING JOINTS: Glued Clamped Welded X Threaded Casing diameter 2 in. to 3 ft. Diameter in. to ft. Diameter in. to ft. Casing height above land surface -0.28 in. Weight lbs./ft. Well thickness or gauge No TYPE OF SCREEN OR PERFORATION MATERIAL: Steel Stainless Steel Fiberglass PVC Other (Specify) Brass Galvanized Steel Concrete tile None used (open hole) SCREEN OR PERFORATION OPENINGS ARE: Continuous Slot X Mill Slot Gauze Wrapped Torch Cut Drilled Holes Other (Specify) Louvered Shutter Key Punched Wire Wrapped Saw Cut None (Open Hole) SCREEN-PERFORATED INTERVALS: From 3 ft. to 10 ft. From ft. to ft. From ft. to ft. GRAVEL PACK INTERVALS: From 2 ft. to 10.5 ft. From ft. to ft. From ft. to ft.

9 GROUT MATERIAL: Neat cement Cement grout Bentonite X Other Concrete: 0-0.7 Grout intervals: From 0.7 ft. to 2 ft. From ft. to ft. From ft. to ft.

Nearest source of possible contamination: Septic Tank Lateral Lines Pit Privy Livestock Pens Insecticide Storage Sewer Lines Cess Pool Sewage Lagoon X Fuel Storage Abandoned Water Well Watertight Sewer Lines Seepage Pit Feedyard Fertilizer Storage Oil Well / Gas Well Other (Specify) Direction from well? SE Distance from well? ~230 ft

Table with 3 columns: FROM, TO, LITHOLOGIC LOG. Rows: 0 to 0.4 Asphalt, 0.4 to 7 Limestone gravel fill, 7 to 10 Clayey silt, 10 to 10.5 Limestone.

Notes: KDHE ID: Pops Stop-N-Shop; U4-089-14702 Target of monitoring well is shallow groundwater, <20' of grout was installed at the direction of KDHE.

11 CONTRACTOR'S OR LANDOWNER'S CERTIFICATION: This water well was X constructed, reconstructed, or plugged under my jurisdiction and was completed on (mo-day-year) 5/29/19 and this record is true to the best of my knowledge and belief. Kansas Water Well Contractor's License No 757 This Water Well Record was completed on (mo-day-year) 7/2/19 under the business name of Larsen & Associates, Inc. Signature

DENNIS L HANDKE

1820 NW 59th Terrace
TOPEKA, KANSAS 66618
785-286-4047 Home
785-217-5864 Cell

Jess Chapman
Larsen & Associates
1311 E. 25th Street, Suite B
Lawrence, Kansas, 66046

June 7, 2019

RE: Monitor Well Elevation Survey
545 SE Croco Road, Topeka, Kansas

Proj. 19-00T
Pops Stop-N-Shop
U4-089-14702

Bench Mark: Chisled X on NE bolt in top fire hydrant at Southeast corner of property.

Elev: 949.43 North 98.84 West 34.77 (from SE Cor. Sec. 10-10-12E)

MW-1R	rim	935.40	North	100.16	SE1/4,SE1/4,SE1/4,SE1/4
	top pipe	935.17	West	145.35	Lat= 39.04457 Long = 95.61404
MW-8	rim	931.11	North	107.79	SE1/4,SE1/4,SE1/4,SE1/4
	top pipe	930.82	West	261.73	Lat= 39.04459 Long = 95.61445
MW-9	rim	934.89	North	175.33	SE1/4,SE1/4,SE1/4,SE1/4
	top pipe	934.62	West	99.64	Lat= 39.04477 Long = 95.61387
MW-10	rim	930.63	North	196.99	SE1/4,SE1/4,SE1/4,SE1/4
	top pipe	930.24	West	246.93	Lat= 39.04484 Long = 95.61439
MW-11	rim	930.28	North	283.14	SE1/4,SE1/4,SE1/4,SE1/4
	top pipe	930.00	West	186.38	Lat= 39.04507 Long = 95.61417
MW-12	rim	929.19	North	214.12	SW1/4,SE1/4,SE1/4,SE1/4
	top pipe	928.91	West	349.46	Lat= 39.04489 Long = 95.61475

Elevation derived from City of Topeka BM #75.1 NAVD27.

Lat & Long derived from Grantville 7.5' Quad Maps WGS 84.

If you have any questions, please feel free to call me. Thank you for the opportunity to be of service to you.

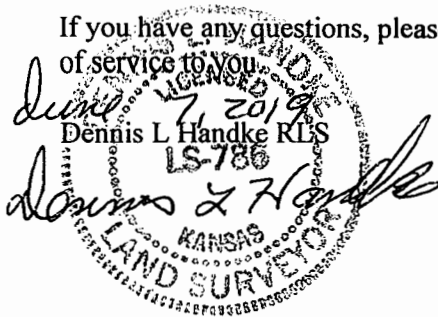

NOTE: Figures exhibited within this report are only to be used within the context of this report. Placement of property lines, wells, structures, and roads is based on the available information from county appraiser maps, surveys, site visits, and/or previous vendor reports and should be considered approximate.



FIGURE 2.2 - 500 FT RADIUS AREA BASE MAP

LEGEND:

- Approximate Location of Former UST Basin and Pump Islands
- Approximate Location of Active UST Basin and Pump Islands
- Building with Basement
- Approximate Location of Property Line
- Observation Well
- Plugged Well
- Existing Monitoring Well
- Monitoring Well (Installed 5/29/19)
- Soil Boring (Drilled 10/12-13/16)
- Fire Hydrant
- Sewer Inlet
- Electric Lines (2 - 6 ft BGS)
- Gas Lines (2 - 6 ft BGS)
- Overhead Lines (25-40 ft high)
- Telephone Lines (2 - 6 ft BGS)
- Water Lines (2 - 6 ft BGS)

NOTE: Approximate location of product lines is unknown.
NOTE: Utility depths, heights and locations are approximate.



PROJECT:

Pops Stop-N-Shop
545 SE Croco Road
Topeka, KS
KDHE ID: U4-089-14702
Date: 6/26/19



1311 E 25th St., Suite B (785) 841-8707 office
Lawrence, KS 66046 (785) 865-4282 fax

RECEIVED
AUG 02 2019
BUREAU OF WATER