

WATER WELL RECORD Form WWC-5

Original Record Correction Change in Well Use

Division of Water Resources App. No.

Well ID

MW-19

1 LOCATION OF WATER WELL: County: Shawnee Fraction NE 1/4 NE 1/4 SE 1/4 NE 1/4 Section Number 31 Township Number T 11 S Range Number R 16 E W

2 WELL OWNER: Last Name: Business: KDHE Address: 1000 SW Jackson St City: Topeka State: KS ZIP: Street or Rural Address where well is located (if unknown, distance and direction from nearest town or intersection): Approx 175' W. & 25' N. of intersection of SE 4th St. & S. Monroe St., Topeka, KS.

3 LOCATE WELL WITH "X" IN SECTION BOX: N W E S 1 mile

4 DEPTH OF COMPLETED WELL: 25.0 ft. Depth(s) Groundwater Encountered: 1) 23.21 ft. 2) ft. 3) ft. or 4) Dry Well WELL'S STATIC WATER LEVEL: ft. below land surface, measured on (mo-day-yr) above land surface, measured on (mo-day-yr) Pump test data: Well water was ft. after hours pumping gpm Well water was ft. after hours pumping gpm Estimated Yield: gpm Bore Hole Diameter: 8.75 in. to 25.0 ft. and in. to ft.

5 Latitude: 37.05417 (decimal degrees) Longitude: -95.66984 (decimal degrees) Horizontal Datum: WGS 84 NAD 83 NAD 27 Source for Latitude/Longitude: GPS (unit make/model) (WAAS enabled? Yes No) Land Survey Topographic Map Online Mapper

6 Elevation: 898.73 ft. Ground Level TOC Source: Land Survey GPS Topographic Map Other

7 WELL WATER TO BE USED AS: 1. Domestic Household Lawn & Garden Livestock 2. Irrigation 3. Feedlot 4. Industrial 5. Public Water Supply: well ID 6. Dewatering: how many wells? 7. Aquifer Recharge: well ID 8. Monitoring: well ID MW-19 9. Environmental Remediation: well ID Air Sparge Soil Vapor Extraction Recovery Injection 10. Oil Field Water Supply: lease 11. Test Hole: well ID Cased Uncased Geotechnical 12. Geothermal: how many bores? a) Closed Loop Horizontal Vertical b) Open Loop Surface Discharge Inj. of Water 13. Other (specify):

Was a chemical/bacteriological sample submitted to KDHE? Yes No If yes, date sample was submitted: Water well disinfected? Yes No

8 TYPE OF CASING USED: Steel PVC Other CASING JOINTS: Glued Clamped Welded Threaded Casing diameter 2 in. to 25.0 ft., Diameter in. to ft., Diameter in. to ft. Casing height above land surface 0 in. Weight lbs./ft. Wall thickness or gauge No. sch 40

TYPE OF SCREEN OR PERFORATION MATERIAL: Steel Stainless Steel Fiberglass PVC Other (Specify) Brass Galvanized Steel Concrete tile None used (open hole)

SCREEN OR PERFORATION OPENINGS ARE: Continuous Slot Mill Slot Gauze Wrapped Torch Cut Drilled Holes Other (Specify) Louvered Shutter Key Punched Wire Wrapped Saw Cut None (Open Hole)

SCREEN-PERFORATED INTERVALS: From 15.0 ft. to 25.0 ft., From ft. to ft., From ft. to ft. GRAVEL PACK INTERVALS: From 13.0 ft. to 25.0 ft., From ft. to ft., From ft. to ft.

9 GROUT MATERIAL: Neat cement Cement grout Bentonite Other Grout Intervals: From 1 ft. to 13.0 ft., From 0 ft. to 1 ft., From ft. to ft.

Nearest source of possible contamination: Septic Tank Lateral Lines Pit Privy Livestock Pens Insecticide Storage Sewer Lines Cess Pool Sewage Lagoon Fuel Storage Abandoned Water Well Watertight Sewer Lines Seepage Pit Feedyard Fertilizer Storage Oil Well/Gas Well Other (Specify) Contaminated Site Direction from well? Distance from well? ft.

Table with 6 columns: FROM, TO, LITHOLOGIC LOG, FROM, TO, LITHO. LOG (cont.) or PLUGGING INTERVALS. Rows include: 0-0.5 Asphalt, 0.5-5 Silty Clay, black, damp, petroleum odor, 5-7 Clay, black, moist, silty, petroleum odor, 7-10 Silty Clay, gray, moist, petroleum odor, 10-15 Silty Clay, gray, damp, plastic, strong petroleum odor, 15-20 Silty Clay, gray-brown, moist, petroleum odor, 20-25 Sandy Clay, light brown, moist

11 CONTRACTOR'S OR LANDOWNER'S CERTIFICATION: This water well was constructed, reconstructed, or plugged under my jurisdiction and was completed on (mo-day-year) 2-1-2022 and this record is true to the best of my knowledge and belief. Kansas Water Well Contractor's License No. 604 This Water Well Record was completed on (mo-day-year) 3/21/22 under the business name of Environmental Priority Service, Inc. Signature PTA MK

21-11-103

DENNIS L HANDKE
1820 NW 59th Terrace
TOPEKA, KANSAS 66618
785-286-4047 Home

Kelse Wheeler
GSI
4503 E. 47th Street
Wichita, Kansas, 67210

February 17, 2022

RE: Monitor Well Elevation Survey
320 SE Kansas, Topeka, Kansas

Proj. 22-00L
Montgomery Ward Co. Inc.
KDHE ID U4-089-00772

Bench Mark: Chisled Square on North center of concrete storm inlet on South side of 3rd St. & West of Monroe Street.
Elev: 888.04 North 3991.28 East 99.21 (from SE Cor. Sec. 31-11-16E)

✓ MW-7R	rim	892.38	North	3952.46	NE1/4,NE1/4,SE1/4,NE1/4
	top pipe	891.89	West	86.91	Lat= 37.05506 Long = 95.66954
✓ MW-14R	rim	890.81	North	3952.48	NW1/4,NW1/4,SW1/4,NW1/4 (Sec. 6-12-16E)
	top pipe	890.26	East	17.39	Lat= 37.05506 Long = 95.66917
✓ MW-17	rim	890.27	North	3881.50	NW1/4,NW1/4,SW1/4,NW1/4 (Sec. 6-12-16E)
	top pipe	889.51	East	167.38	Lat= 37.05487 Long = 95.66864
✓ MW-18	rim	899.24	North	3706.02	NE1/4,NE1/4,SE1/4,NE1/4
	top pipe	898.77	West	187.82	Lat= 37.05439 Long = 95.66990
✓ MW-19	rim	899.55	North	3627.60	SE1/4,NE1/4,SE1/4,NE1/4
	top pipe	898.73	West	171.75	Lat= 37.05417 Long = 95.66984

Lat & Long derived from Topeka 7.5' quad map. WGS 84.

Elevation established from existing proj. NAVD 88

If you have any questions, please feel free to call me. Thank you for the opportunity to be of service to you.



Shawnee

31-11-16E



Legend

	= Proposed Well		= Former Pump Island
	= Proposed Soil Boring		= Electric Line
	= Monitoring Well		= Gas Line
	= Destroyed Well		= Sewer Line
	= Easement		= Water Line
	= Parcel		= Fiber Optic Line
	= Building Footprint		= Power Pole
	= Grassy Area		= Trees
	= Former UST		

*Estimated buried utilities depth >= 4 ft bgs

ALL LOCATIONS AND BOUNDARIES ARE APPROXIMATE

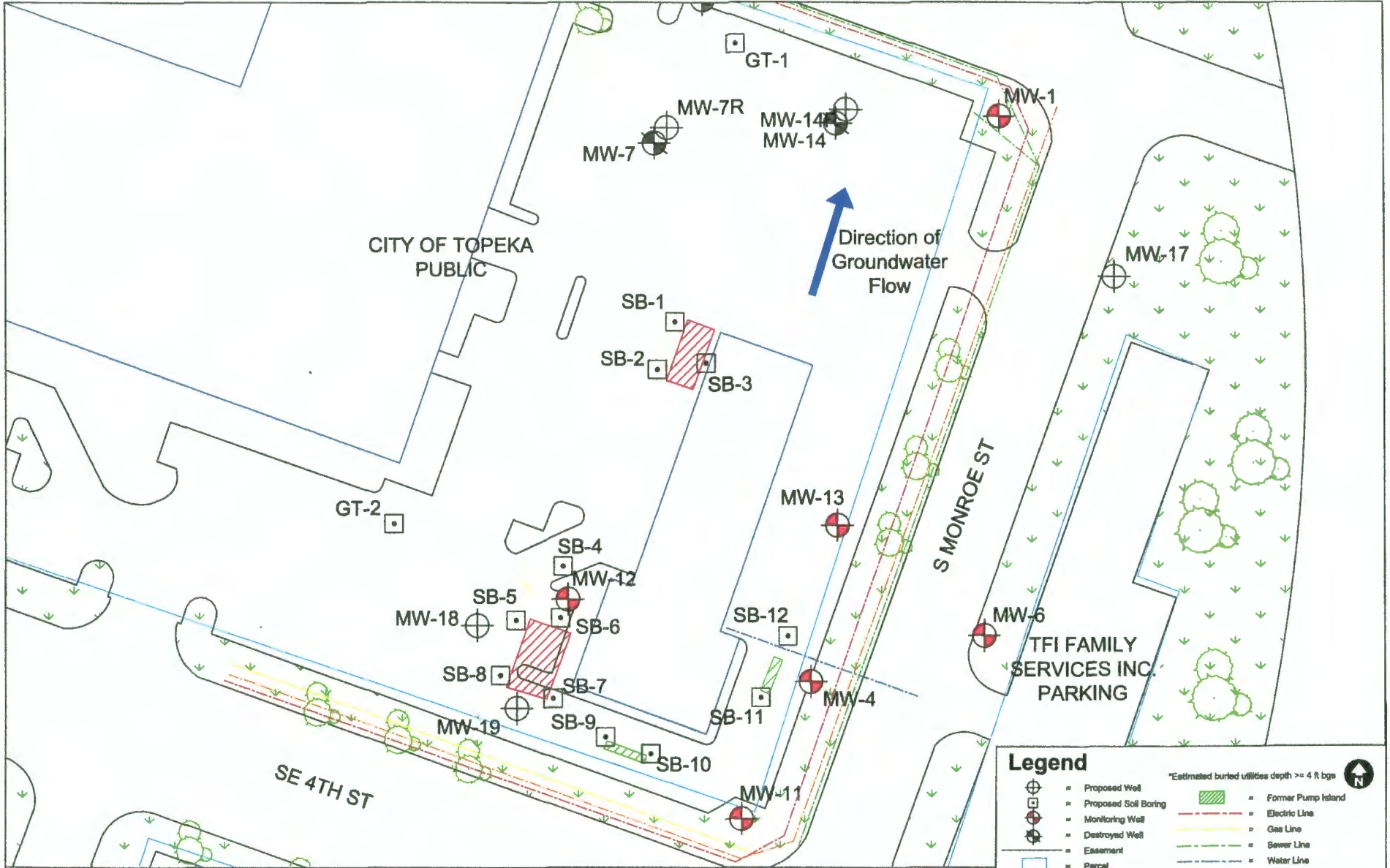

FIGURE: 3.0	FIGURE NAME: Aerial Photo
DATE: 01/07/2022	PROJECT NUMBER: 2174145
DRAWN BY: HS	PROJECT MANAGER: RE

Montgomery Ward & Co., Inc.
 320 Kansas Avenue
 Topeka, Kansas
 KDEE #U4-089-00772



31-11-166



Legend

	= Proposed Well		= Former Pump Island
	= Proposed Soil Boring		= Electric Line
	= Monitoring Well		= Gas Line
	= Destroyed Well		= Sewer Line
	= Easement		= Water Line
	= Parcel		= Fiber Optic Line
	= Building Footprint		= Power Pole
	= Grassy Area		= Trees
	= Former UST		

*Estimated buried utilities depth >= 4 ft bgs

ALL LOCATIONS AND BOUNDARIES ARE APPROXIMATE



FIGURE: 2.0
 DATE: 01/07/2022
 DRAWN BY: HS

FIGURE NAME: Site Map - Scale 1"=50'
 PROJECT NUMBER: 2174145
 PROJECT MANAGER: RE

Montgomery ward & Co., Inc.
 320 Kansas Avenue
 Topeka, Kansas
 KDHE #U4-089-00772

