

WATER WELL RECORD

Form WWC-5

Division of Water Resources App. No.

Well ID

MW11R

Original Record Correction Change in Well Ust

1 LOCATION OF WATER WELL: County Shawnee
2 WELL OWNER: Last Name: KDHE, Address: 1000 SW Jackson, Topeka, KS
3 LOCATE WELL WITH 'X' IN SECTION BOX: [Diagram showing a 3x3 grid with 'x' in the SE quadrant]
4 DEPTH OF COMPLETED WELL: 22 ft
5 Latitude: 39.04755, Longitude: 95.65653

7 WELL WATER TO BE USED AS:
1 Domestic: [] Household, [] Lawn & Garden, [] Livestock, [] Irrigation, [] Feedlot, [] Industrial
5 Public Water Supply: well ID
6 Dewatering: how many wells?
7 Aquifer Recharge: well ID
8 [X] Monitoring: well ID MW11R
9 Environmental Remediation: well ID
10 Oil Field Water Supply: lease
11 Test Hole: well ID
12 Geothermal: How many bores?

Was a chemical/bacteriological sample submitted to KDHE? [] Yes [X] No
Water well disinfected? [] Yes [X] No

8 TYPE OF CASING USED: [] Steel [X] PVC [] Other
Casing diameter 2 in. to 12 ft
TYPE OF SCREEN OR PERFORATION MATERIAL: [] Steel [] Stainless Steel [] Fiberglass [X] PVC [] Brass [] Galvanized Steel [] Concrete tile [] None used (open hole)
SCREEN OR PERFORATION OPENINGS ARE: [] Continuous Slot [X] Mill Slot [] Gauze Wrapped [] Torch Cut [] Drilled Holes [] Other (Specify)
SCREEN-PERFORATED INTERVALS: From 12 ft. to 22 ft.
GRAVEL PACK INTERVALS: From 10 ft. to 22 ft.

9 GROUT MATERIAL: [] Neat cement [] Cement grout [X] Bentonite [X] Other Concrete: 0-0.5'
Grout intervals: From 0.5 ft. to 10 ft.

Nearest source of possible contamination:
[] Septic Tank [] Lateral Lines [] Pit Privy [] Livestock Pens [] Insecticide Storage
[] Sewer Lines [] Cess Pool [] Sewage Lagoon [X] Fuel Storage [] Abandoned Water Well
[] Watertight Sewer Lines [] Seepage Pit [] Feedyard [] Fertilizer Storage [] Oil Well / Gas Well
[] Other (Specify)
Direction from well? SW Distance from well? ~120 ft

Table with 6 columns: FROM, TO, LITHOLOGIC LOG, FROM, TO, LITHO. LOG (cont.) or PLUGGING INTERVALS. Rows show depth intervals and lithology: 0-0.5 Concrete, 0.5-17 Clay, 17-22 Sand.

Notes: KDHE ID: Liberty Oil Company: U5-015-14814
Target of monitoring well is shallow groundwater, <20' of grout was installed at the direction of KDHE.

11 CONTRACTOR'S OR LANDOWNER'S CERTIFICATION: This water well was [X] constructed, [] reconstructed, or [] plugged under my jurisdiction and was completed on (mo-day-year) 6/27/22 and this record is true to the best of my knowledge and belief. Kansas Water Well Contractor's License No 757 This Water Well Record was completed on (mo-day-year) 9/13/22 under the business name of Larsen & Associates, Inc. Signature

NOTE: Figures exhibited within this report are only to be used within the context of this report. Placement of property lines, wells, structures, and roads is based on the available information from county appraiser maps, surveys, site visits, and/or previous vendor reports and should be considered approximate.

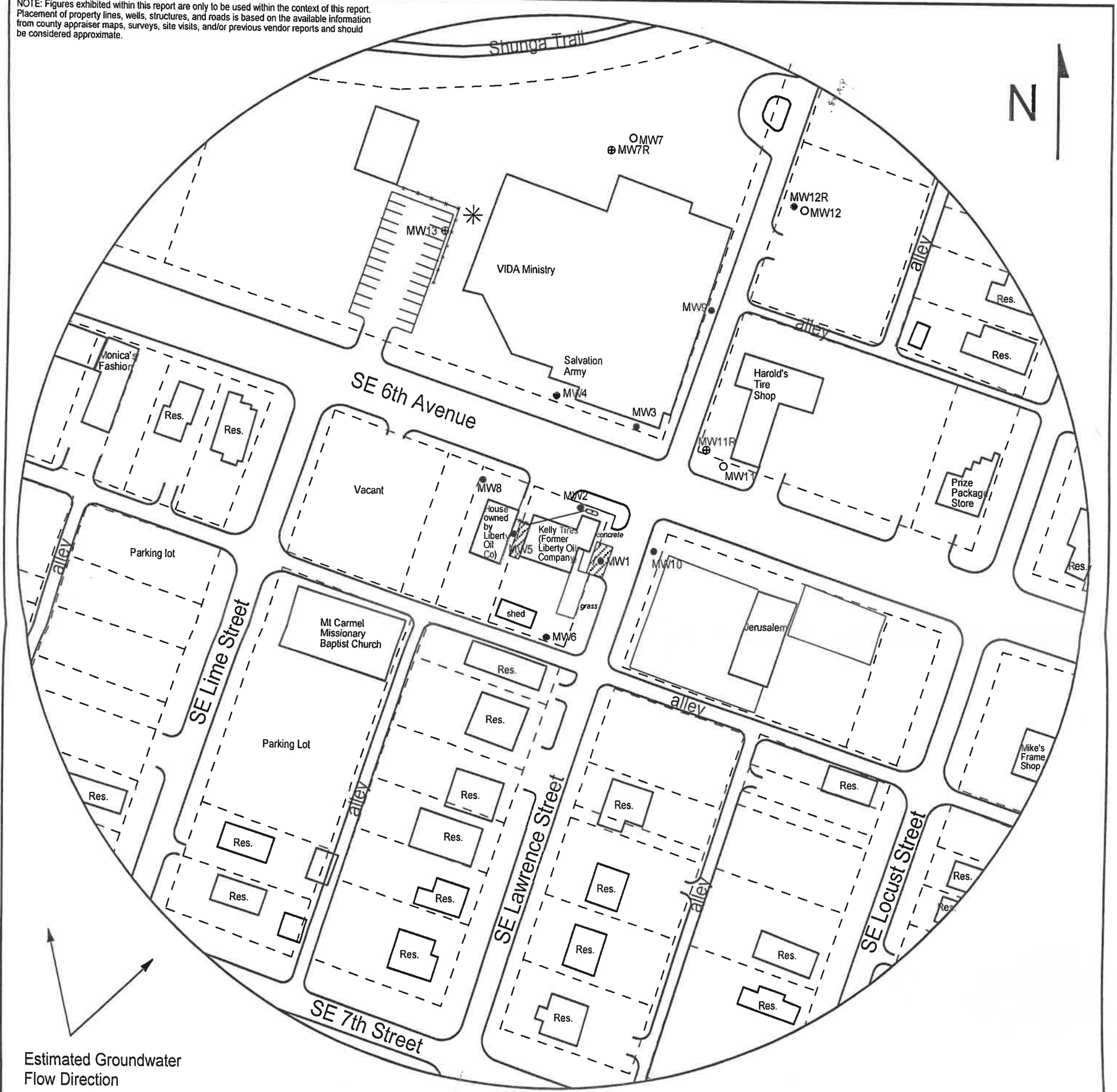

FIGURE 1 - 500 FT RADIUS AREA BASE MAP

LEGEND

- Approximate Location of Former UST Basin, Product Lines & Pump Islands
- Approximate Location of Property Line
- Existing Monitoring Well
- New Monitoring Well



PROJECT:
 Liberty Oil Company
 1319 SE 6th
 Topeka, KS
 KDHE ID: U4-089-00138
 Date: 6/27/22

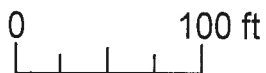

1311 E 25th St., Suite B 785-841-8707 office
 Lawrence, KS 66046 785-865-4282 fax

† 17-1216-SCC.32
 Shawnee
 KSA 82a-1212

RECEIVED
 SEP 22 2022
 BUREAU OF WATER

T 115 - R16E - Sec. 32
Shawnee
KSA 82a-1212

DENNIS L HANDKE
1820 NW 59th Terrace
TOPEKA, KANSAS 66618
785-286-4047 Home

Jess Chapman
Larsen & Associates
1311 E. 25th Street, Suite B
Lawrence, Kansas, 66046

September 10, 2022

RE: Monitor Well Elevation Survey
1319 SE 6th Ave., Topeka, Kansas

Proj. 22-00UU
Liberty Oil Company
U4-089-00138

Bench Mark: "M" in Mueller on top of fire hydrant at Northwest corner of SE 6 th Ave. & Lawrence St.
Elev: 887.34 North 1178 West 1716 (from SE Cor. Sec. 32-11-16E)

MW-7R	rim	888.01	North	1455	SW1/4,SE1/4,NW1/4,SE1/4
	top pipe	887.52	West	1761	Lat = 39.04832 Long = 95.65686
MW-11R	rim	885.72	North	1178	NW1/4,NE1/4,SW1/4,SE1/4
	top pipe	885.38	West	1664	Lat = 39.04755 Long = 95.65653
MW-13	rim	886.93	North	1385	SW1/4,SE1/4,NW1/4,SE1/4
	top pipe	886.60	West	1913	Lat = 39.0812 Long = 95.65740

Lat & Long derived from Topeka 7.5 quad map. WGS84

Elevation established from existing project. NAVD 88

If you have any questions, please feel free to call me. Thank you for the opportunity to be of service to you.



RECEIVED
SEP 22 2022
BUREAU OF WATER