

WATER WELL RECORD

Form WWC-5

Division of Water Resources App. No.

Well ID

MW13

Original Record Correction Change in Well Use

1 LOCATION OF WATER WELL: County Shawnee Fraction SW 1/4 SE 1/4 NW 1/4 SE 1/4 Section Number 32 Township Number T 11 S Range Number R 16 E W

2 WELL OWNER: Last Name: Business: KDHE Address: 1000 SW Jackson City Topeka State: KS ZIP: 66612 Street or Rural Address where well is located (if unknown, distance and direction from nearest town or intersection): If at owner's address, check here: ~250' N-NW of 1319 SE 6th Ave., Topeka, KS

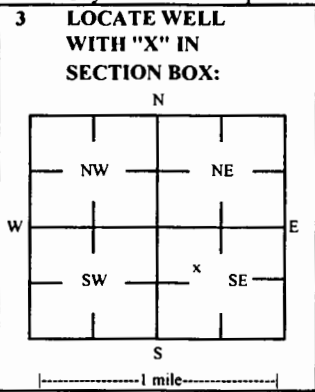

3 LOCATE WELL WITH 'X' IN SECTION BOX: 4 DEPTH OF COMPLETED WELL: 23.5 ft Depth(s) Groundwater Encountered: 1) ft 2) ft 3) ft, or 4) Dry Well WELL'S STATIC WATER LEVEL: ft. below land surface, measured on (mo-day-yr) above land surface, measured on (mo-day-yr) Pump test data: Well water was ft after hours pumping gpm Water well was ft after hours pumping gpm Estimated Yield: gpm Bore Hole Diameter: 7.25 in to ft, and in to ft

5 Latitude: 39.0812 (decimal degrees) Longitude: 95.65740 (decimal degrees) Horizontal Datum: X WGS 84 NAD 83 NAD 27 Source for Latitude/Longitude: GPS (unit make/model:) (WAAS enabled? Yes No) X Land Survey Topographic Map Online Mapper 6 Elevation: 886.6 ft Ground Level TOC Source: X Land Survey GPS Topographic Map Other

7 WELL WATER TO BE USED AS: 1 Domestic: Household Lawn & Garden Livestock Irrigation Feedlot Industrial 2 Public Water Supply: well ID 3 Dewatering: how many wells? 4 Aquifer Recharge: well ID 5 Monitoring: well ID MW13 6 Environmental Remediation: well ID Air Sparge Recovery Soil Vapor Extractor Injection 7 Oil Field Water Supply: lease 8 Test Hole: well ID Cased Uncased Geotechnical 9 Geothermal: How many bores? a) Closed Loop Horizontal Vertical b) Open Loop Surface Discharge Inj. of Water Other (specify):

Was a chemical/bacteriological sample submitted to KDHE? Yes No X No If yes, date sample was submitted: Water well disinfected? Yes No X No

8 TYPE OF CASING USED: Steel PVC Other CASING JOINTS: Glued Clamped Welded X Threaded Casing diameter 2 in. to 13.5 ft, Diameter in. to ft, Diameter in. to ft, Casing height above land surface -0.33 in. Weight lbs./ft. Well thickness or gauge No TYPE OF SCREEN OR PERFORATION MATERIAL: Steel Stainless Steel Fiberglass PVC Other (Specify) Brass Galvanized Steel Concrete tile None used (open hole) SCREEN OR PERFORATION OPENINGS ARE: Continuous Slot X Mill Slot Gauze Wrapped Torch Cut Drilled Holes Other (Specify) Louvered Shutter Key Punched Wire Wrapped Saw Cut None (Open Hole) SCREEN-PERFORATED INTERVALS: From 13.5 ft. to 23.5 ft, From ft. to ft, From ft. to ft, GRAVEL PACK INTERVALS: From 11.5 ft. to 23.5 ft, From ft. to ft, From ft. to ft,

9 GROUT MATERIAL: Neat cement Cement grout X Bentonite X Other Concrete: 0-0.5' Grout intervals: From 0.5 ft. to 11.5 ft, From ft. to ft, From ft. to ft,

Nearest source of possible contamination: Septic Tank Lateral Lines Pit Privy Livestock Pens Insecticide Storage Sewer Lines Cess Pool Sewage Lagoon X Fuel Storage Abandoned Water Well Watertight Sewer Lines Seepage Pit Feedyard Fertilizer Storage Oil Well / Gas Well Other (Specify) Direction from well? S-SE Distance from well? ~280 ft

Table with columns: 10 FROM, TO, LITHOLOGIC LOG, FROM, TO, LITHO. LOG (cont.) or PLUGGING INTERVALS. Row 1: 0, 0.5, Asphalt. Row 2: 0.5, 23.5, Clayey silt.

Notes: KDHE ID: Liberty Oil Company: U5-015-14814 Target of monitoring well is shallow groundwater, <20' of grout was installed at the direction of KDHE.

11 CONTRACTOR'S OR LANDOWNER'S CERTIFICATION: This water well was X constructed, reconstructed, or plugged under my jurisdiction and was completed on (mo-day-year) 6/27/22 and this record is true to the best of my knowledge and belief. Kansas Water Well Contractor's License No 757 This Water Well Record was completed on (mo-day-year) 9/13/22 under the business name of Larsen & Associates, Inc. Signature

NOTE: Figures exhibited within this report are only to be used within the context of this report. Placement of property lines, wells, structures, and roads is based on the available information from county appraiser maps, surveys, site visits, and/or previous vendor reports and should be considered approximate.

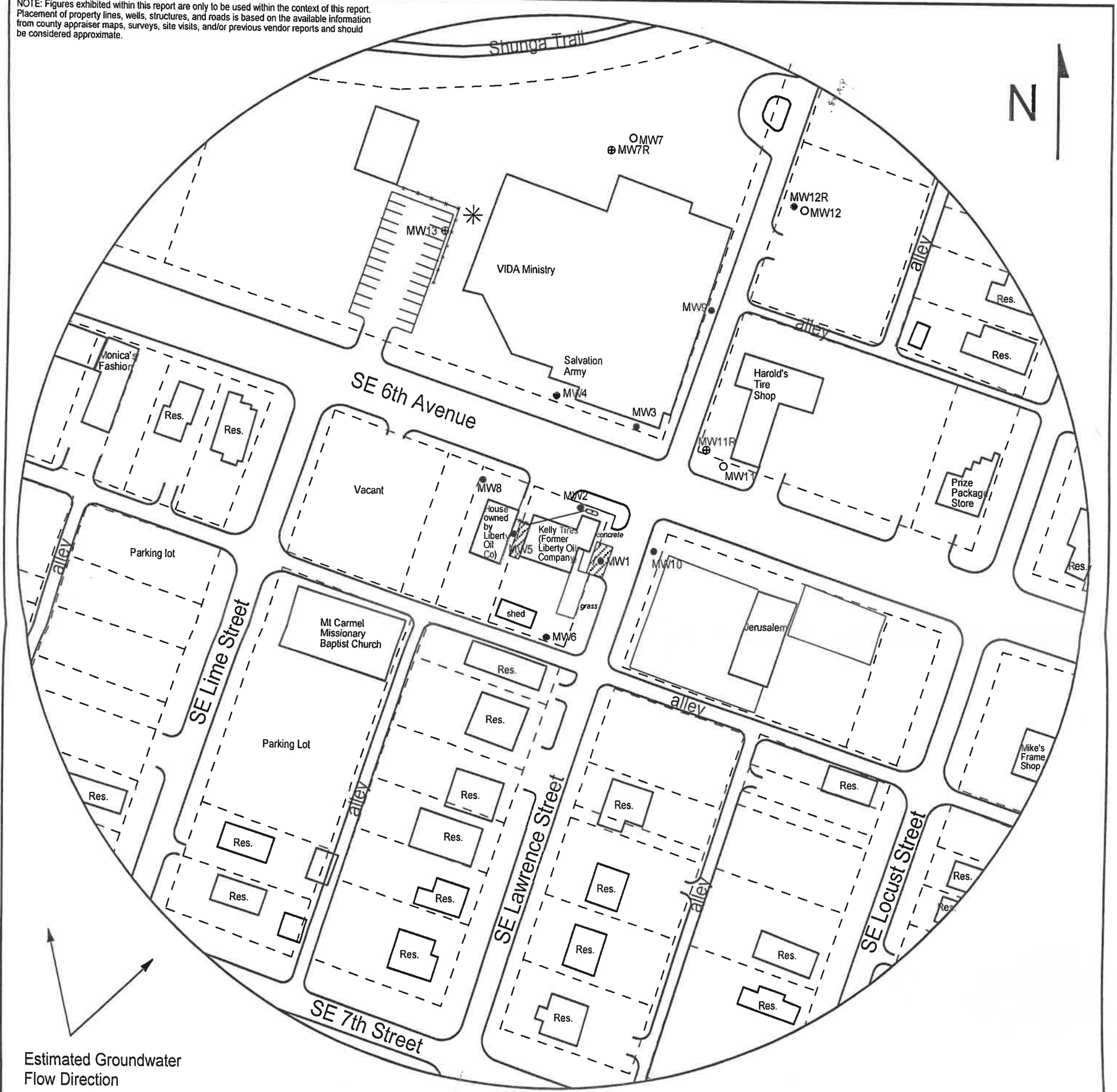

FIGURE 1 - 500 FT RADIUS AREA BASE MAP

LEGEND

- Approximate Location of Former UST Basin, Product Lines & Pump Islands
- Approximate Location of Property Line
- Existing Monitoring Well
- New Monitoring Well



PROJECT:
 Liberty Oil Company
 1319 SE 6th
 Topeka, KS
 KDHE ID: U4-089-00138
 Date: 6/27/22

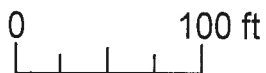

1311 E 25th St., Suite B 785-841-8707 office
 Lawrence, KS 66046 785-865-4282 fax

† 17-1216-SCC.32
 Shawnee
 KSA 82a-1212

RECEIVED
 SEP 22 2022
 BUREAU OF WATER

T 115 - R 16 E - Sec. 32
Shawnee
KSA 82a-1212

DENNIS L HANDKE
1820 NW 59th Terrace
TOPEKA, KANSAS 66618
785-286-4047 Home

Jess Chapman
Larsen & Associates
1311 E. 25th Street, Suite B
Lawrence, Kansas, 66046

September 10, 2022

RE: Monitor Well Elevation Survey
1319 SE 6th Ave., Topeka, Kansas

Proj. 22-00UU
Liberty Oil Company
U4-089-00138

Bench Mark: "M" in Mueller on top of fire hydrant at Northwest corner of SE 6 th Ave. & Lawrence St.
Elev: 887.34 North 1178 West 1716 (from SE Cor. Sec. 32-11-16E)

MW-7R	rim	888.01	North	1455	SW1/4,SE1/4,NW1/4,SE1/4
	top pipe	887.52	West	1761	Lat = 39.04832 Long = 95.65686
MW-11R	rim	885.72	North	1178	NW1/4,NE1/4,SW1/4,SE1/4
	top pipe	885.38	West	1664	Lat = 39.04755 Long = 95.65653
MW-13	rim	886.93	North	1385	SW1/4,SE1/4,NW1/4,SE1/4
	top pipe	886.60	West	1913	Lat = 39.0812 Long = 95.65740

Lat & Long derived from Topeka 7.5 quad map. WGS84

Elevation established from existing project. NAVD 88

If you have any questions, please feel free to call me. Thank you for the opportunity to be of service to you.



RECEIVED
SEP 22 2022
BUREAU OF WATER