

WATER WELL RECORD

Form WWC-5

Division of Water

Resources App. No. []

Well ID

MW1R

[X] Original Record [] Correction [] Change in Well Use

1 LOCATION OF WATER WELL: County Shawnee Fraction NW 1/4 NE 1/4 SW 1/4 Section Number 17 Township Number T 11 S Range Number R 16 E W

2 WELL OWNER: Last Name: First: Street or Rural Address where well is located (if unknown, distance and direction from nearest town or intersection): If at owner's address, check here: [] Business: KDHE (Graffiti Auto Sales) Address: 1000 SW Jackson 2640 NW Topeka Blvd., Topeka City Topeka State: KS ZIP: 66612

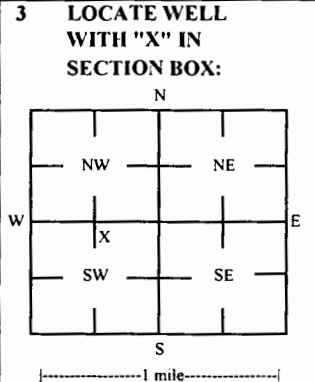

3 LOCATE WELL WITH "X" IN SECTION BOX: 4 DEPTH OF COMPLETED WELL: 39.5 ft Depth(s) Groundwater Encountered: 1) 39.5 ft 2) 0 ft or 3) 0 ft or 4) [] Dry Well WELL'S STATIC WATER LEVEL: 33.29 ft [X] below land surface, measured on (mo-day-yr) 4/3/23 [] above land surface, measured on (mo-day-yr) Pump test data: Well water was 0 ft after 0 hours pumping 0 gpm Water well was 0 ft after 0 hours pumping 0 gpm Estimated Yield: 0 gpm Bore Hole Diameter: 7.25 in to 0 ft, and 0 in to 0 ft

5 Latitude: 39.09461 (decimal degrees) Longitude: 95.66426 (decimal degrees) Horizontal Datum [X] WGS 84 [] NAD 83 [] NAD 27 Source for Latitude/Longitude: [] GPS (unit make/model:) (WAAS enabled? [] Yes [] No) [X] Land Survey [] Topographic Map [] Online Mapper 6 Elevation 887.56 ft [] Ground Level [X] TOC Source [X] Land Survey [] GPS [] Topographic Map [] Other

7 WELL WATER TO BE USED AS: 1 Domestic: [] Household [] Lawn & Garden [] Livestock 2 [] Irrigation 3 [] Feedlot 4 [] Industrial 5 [] Public Water Supply: well ID 6 [] Dewatering: how many wells? 7 [] Aquifer Recharge: well ID 8 [X] Monitoring: well ID MW1R 9 Environmental Remediation: well ID [] Air Sparge [] Soil Vapor Extractor [] Recovery [] Injection 10 [] Oil Field Water Supply: lease 11 Test Hole: well ID [] Cased [] Uncased [] Geotechnical 12 Geothermal: How many bores? a) Closed Loop [] Horizontal [] Vertical b) Open Loop [] Surface Discharge [] Inj. of Water [] Other (specify):

Was a chemical/bacteriological sample submitted to KDHE? [] Yes [X] No If yes, date sample was submitted: Water well disinfected? [] Yes [X] No

8 TYPE OF CASING USED: [] Steel [X] PVC [] Other CASING JOINTS: [] Glued [] Clamped [] Welded [X] Threaded Casing diameter 2 in. to 24.5 ft, Diameter in. to ft, Diameter in. to ft, Casing height above land surface -0.35 in. Weight lbs./ft. Well thickness or gauge No TYPE OF SCREEN OR PERFORATION MATERIAL: [] Steel [] Stainless Steel [] Fiberglass [X] PVC [] Other (Specify) [] Brass [] Galvanized Steel [] Concrete tile [] None used (open hole) SCREEN OR PERFORATION OPENINGS ARE: [] Continuous Slot [X] Mill Slot [] Gauze Wrapped [] Torch Cut [] Drilled Holes [] Other (Specify) [] Louvered Shutter [] Key Punched [] Wire Wrapped [] Saw Cut [] None (Open Hole) SCREEN-PERFORATED INTERVALS: From 24.5 ft. to 39.5 ft, From ft. to ft, From ft. to ft, GRAVEL PACK INTERVALS: From 22.5 ft. to 39.5 ft, From ft. to ft, From ft. to ft,

9 GROUT MATERIAL: [] Neat cement [] Cement grout [X] Bentonite [X] Other Concrete: 0-0.5' Grout intervals: From 0.5 ft. to 22.5 ft, From ft. to ft, From ft. to ft, Nearest source of possible contamination: [] Septic Tank [] Lateral Lines [] Pit Privy [] Livestock Pens [] Insecticide Storage [] Sewer Lines [] Cess Pool [] Sewage Lagoon [] Fuel Storage [] Abandoned Water Well [] Watertight Sewer Lines [] Seepage Pit [] Feedyard [] Fertilizer Storage [] Oil Well / Gas Well [] Other (Specify) Direction from well? S Distance from well? ~5 ft

Table with 6 columns: 10 FROM, TO, LITHOLOGIC LOG, FROM, TO, LITHO. LOG (cont.) or PLUGGING INTERVALS. Rows show depth intervals and lithology: 0-0.7 Concrete, 0.7-6 Silty clay, 6-12 Coarse-medium gravel, silt, 12-26 Silty clay, 26-39.5 Medium-coarse sand.

Notes: KDHE ID: Graffiti Auto Sales; U4-089-01026

11 CONTRACTOR'S OR LANDOWNER'S CERTIFICATION: This water well was [X] constructed, [] reconstructed, or [] plugged under my jurisdiction and was completed on (mo-day-year) 3/27/23 and this record is true to the best of my knowledge and belief. Kansas Water Well Contractor's License No 757 This Water Well Record was completed on (mo-day-year) 4/20/23 under the business name of Larsen & Associates, Inc. Signature []

Sec. 17 T. 11 R. 16E
Shawnee County

NOTE: Figures exhibited within this report are only to be used within the context of this report. Placement of property lines, wells, structures, and roads is based on the available information from county appraiser maps, surveys, site visits, and/or previous vendor reports and should be considered approximate.

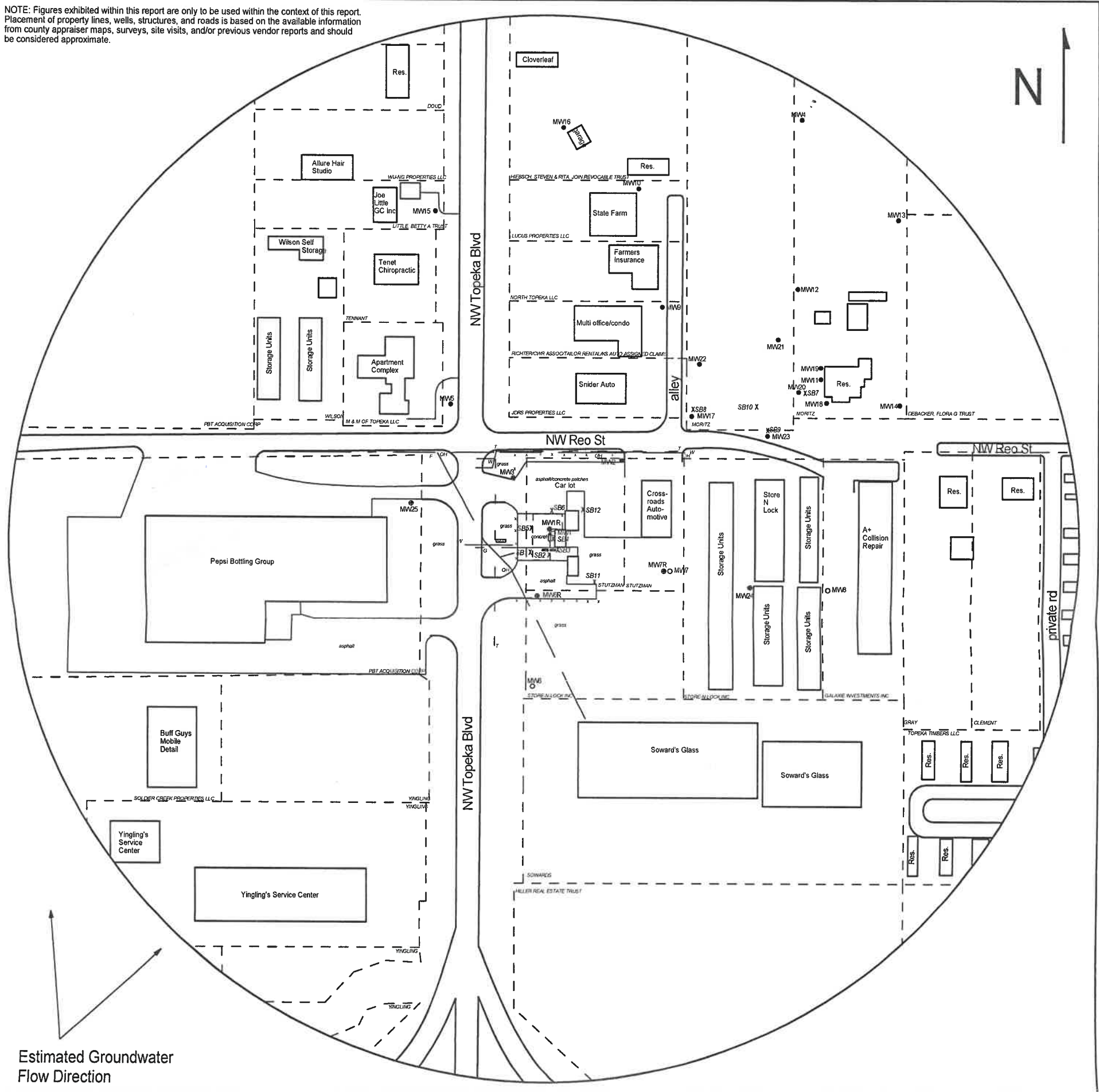

FIGURE 2.2 - 800 FT RADIUS AREA BASE MAP



1311 E 25th St., Suite B 785-841-8707 office
Lawrence, KS 66046 785-865-4282 fax

PROJECT:
Graffiti Auto Sales
2640 Northwest Topeka Blvd,
Topeka, KS
KDHE ID: U4-089-01026
Date: 4/3/23



LEGEND

- Approximate Location of Former UST Basin, Product Lines & Pump Islands
- Excavation Area
- Approximate Location of Property Line
- Existing Monitoring Well
- New Monitoring Well (Installed 3/27-30/23)
- Plugged Monitoring Well
- Soil Boring (Drilled 3/27-29/23)
- Fire Hydrant
- Gas Lines (1.5 - 3 ft bgs)
- Overhead Lines (25'-40' high)
- Telephone Lines (2 - 6 ft bgs)
- Water Lines (2 - 6 ft bgs)

NOTE: SB11 & SB12 were drilled to collect hydrologic samples.
NOTE: Utility depths, heights and locations are approximate.

DENNIS L HANDKE

1820 NW 59th Terrace
TOPEKA, KANSAS 66618
785-286-4047 Home

Jess Chapman
Larsen & Assoc.
1311 E. 25th St., Suite B
Topeka, Kansas 66046

*Sec. 17 T. 11 R. 16E
Shawnee County*

April 11, 2023

RE: Monitor Well Elevation Survey
2640 NW Topeka Blvd., Topeka, Kansas

Proj. 23-00N
Graffiti Auto Sales
KDHE ID U4-089-01026

Bench Mark: Chisled Sq. on NW corner of concrete floor of the North building.
Elev.: 889.66 North 2585.50 West 1489.39 (from SE Cor. Sec. 17-11-16E)

MW-1R	rim	887.91	North 2561.26	NW1/4,NW1/4,NE1/4,SW1/4
	top pipe	887.56	East 1456.07	Lat = 39.09461 Long = 95.66426
MW-6R	rim	886.92	North 2464.06	NW1/4,NW1/4,NE1/4,SW1/4
	top pipe	886.51	East 1445.68	Lat = 39.09434 Long = 95.66430
MW-7R	rim	886.71	North 2497.85	NW1/4,NW1/4,NE1/4,SW1/4
	top pipe	886.25	East 1638.22	Lat = 39.09443 Long = 95.66362
MW-24	rim	885.60	North 2474.59	NE1/4,NW1/4,NE1/4,SW1/4
	top pipe	885.33	East 1761.42	Lat = 39.09437 Long = 95.66319
MW-25	rim	877.33	North 2603.41	NE1/4,NE1/4,NW1/4,SW1/4
	top pipe	876.95	East 1261.24	Lat = 39.09473 Long = 95.66495

Lat & Long derived from Topeka 7.5' quad map. WGS84.

Elevation derived from City of Topeka BM #51. NAVD 88.

There is no SE Corner of Section 17 due to the Kaw Half Breed Reserve #5.
Location of wells are from the SW corner of Section 17.

If you have any questions, please feel free to call me. Thank you for the opportunity to be of service to you.

