

149

These are usually
The same

USE TYPEWRITER OR BALL
POINT PEN—PRESS FIRMLY,
PRINT CLEARLY.

WATER WELL RECORD
KSA 82a-1201-1215

Kansas Department of Health and
Environment—Division of Environment
(Water well Contractors)
Topeka, Kansas 66620

NE DAD

1. Location of well:	County Shawnee	Fraction SE 1/4 SW 1/4 SE 1/4	Section number 16	Township number T 11 S	Range number S R 16 E	E/W
----------------------	--------------------------	--	-----------------------------	----------------------------------	---------------------------------	-----

2. Distance and direction from nearest town or city: Street address of well location if in city: 2301 Kaw Rd	3. Owner of well: R.R. or street: Frank Forman 2301 Kaw Rd City, state, zip code: Topeka, KS.
--	---

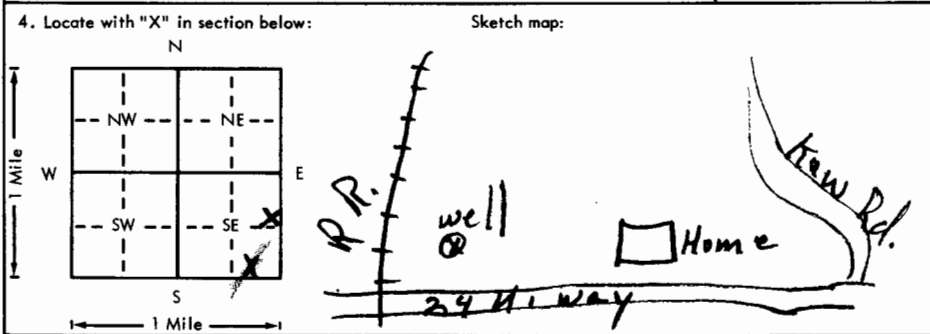

6. Bore hole dia. **6 1/4** in. Completion date **8-24-76**
Well depth **31** ft.

7. Cable tool Rotary Driven Dug
 Hollow rod Jetted Bored Reverse rotary

8. Use: Domestic Public supply Industry
 Irrigation Air conditioning Stock
 Lawn Oil field water Other

9. Casing: Material **PVS** Height: Above or below
Threaded Welded Surface **24** in.
RMP PVC Weight lbs./ft.
Dia. **5** in. to **31** ft. depth Wall Thickness: inches or
Dia. in. to ft. depth Page No. **300**

5. Type and color of material	From	To
Top soil	0	3
Clay sandy	3	17
Sand fine dirty	17	28
Sand Med	28	31

10. Screen: Manufacturer's name **SantPower**

Type **RMP** Dia. **5"**
Slot/gauze **050** Length **31**
Set between **28** ft. and **31** ft.
ft. and ft.
Gravel pack? **NO** Size range of material

11. Static water level: **16** ft. below land surface Date **8-24-76** mo./day/yr.

12. Pumping level below land surfaces:
 ft. after hrs. pumping g.p.m.
 ft. after hrs. pumping g.p.m.
Estimated maximum yield **20-30** g.p.m.

13. Water sample submitted: Yes No Date

14. Well head completion:
 Pitless adapter **24** inches above grade

15. Well grouted? **yes**
With: neat cement Bentonite Concrete
Depth: From **0** ft. to **20** ft.

16. Nearest source of possible contamination:
ft. **300** Direction **East** Type **Septic**
Well disinfected upon completion? Yes No

17. Pump: Not installed
Manufacturer's name
Model number HP Volts
Length of drop pipe ft. capacity g.p.m.
Type:
 Submersible Turbine
 Jet Reciprocating
 Centrifugal Other

18. Elevation: **870**
Topography:
 Hill
 Slope
 Upland
 Valley

19. Remarks:
owner to install slab.

20. Water well contractor's certification:
This well was drilled under my jurisdiction and this report is true to the best of my knowledge and belief.
Johnson Drilling 316A
Business name License No.
Address **A+1 Perry KS.**
Signed **John Johnson** Date **8-24-76**
Authorized representative

T 11 S
R 16 E
Sec 16 SE SE